

WELCOME

Dear Colleagues,

On behalf of the WSSA, it is our distinct pleasure to welcome you to beautiful Albuquerque, New Mexico, site of the 51st annual WSSA conference. Within 50 years, our association has grown from a small regional meeting that hardly filled the cafeteria at the University of Denver to a full-fledged conference attracting participants both nationally and internationally. In fact, if one casually examines the program, it is evident that the WSSA has a global following. We continue to draw attendees from Latin America, Canada, Australia, Asia, Europe, and even Africa.

This year, we are going to try something new. Larry Gould, WSSA Executive Officer, will host a Professional Development Luncheon, during which he will talk about developing a professional portfolio and documenting a path to promotion. This is something that graduate students and new scholars on the path to promotion and tenure will not want to miss. The luncheon will be followed by a publication workshop hosted by the Social Science Journal editor, Prabha Unnithan that everyone is encouraged to attend.

This year's conference theme, *New Era in a New World: Challenges facing the Social Sciences*, has attracted many outstanding papers. We have chosen this theme because this is a pivotal point in history. Domestically, we have elected the first African American President in America's history. This President has the unenviable task of rebuilding our economy and creating a vision for a New Era in a New World. Based on the number of presentations at this year's conference, our members are up to the challenge. During this three day conference, we invite you attend sessions outside your discipline and be open to new ideas. With these exchanges we can help integrate social science research in a way that will help us face these challenges.

Again, we welcome you to Albuquerque and, most of all, we are looking forward to seeing you during the three days that we are together. We would like to also ask you to please take the time to introduce yourselves to any of the WSSA officers during the conference. If there is anything that we can do to make WSSA better you can always leave us a note in the suggestion box that will be located near the Registration Desk.

Sincerely,

Phadrea D. Ponds
WSSA President

Jack W. Hou
General Program Coordinator
2008-9 President-Elect

Table of Contents

Conference Welcome Letter	i
Next Year's Conference Announcement	ii
Student Paper Award Winners	ii
Professional Development Luncheon	iii
SSJ Professional Development Session	iii
Student Paper Winners Session	iii
Special Screening of the Emmy winning Movie: "Made in LA"	iv
WSSA President's Reception	iv
Map of Hotel	v
Program Overview & Schedule of Events	vi-vii
Section Coordinator Listing	viii
African & African American Studies	1
American Indian Studies	5
American Studies	10
Arid Lands Studies & Geography	11
Asian Studies	13
Association for Borderland Studies	15
Canadian Studies	27
Chicano Studies/Land Grants	29
Chronic Disease & Disability	32
Criminal Justice & Criminology	35
Economics (AFIT)	39
Economics (Business and Finance)	47
Economics (General)	48
Environmental Policy & Natural Resource Management	52
History	55
Human Communication	58
Latin American Studies	60
Mass Communications	62
New Zealand & Australian Studies	65
Political Science	67
Public Administration	69
Public Finance & Budgeting	71
Rural Studies	75
Slavic Studies	77
Sociology	78
Urban Studies	84
Women's Studies	86
Index of Participants	88
Program Advertisements	97

Abstracts available at: <http://wssa.asu.edu>



Join us Next Year in Reno!

**Western Social Science Association
52nd Annual Conference
April 14 - 17, 2010
Reno, Nevada
Grand Sierra Resort**

Please plan to join us in Reno, the Biggest Little City in the World. The Western Social Science Association invites proposals for presentations at the 51st Annual Conference. Proposals for both complete panels and individual papers are welcome. You can submit your proposal through the WSSA website: <http://wssa.asu.edu>. Please note the section for which you would like your proposal submitted. Also, feel free to directly submit your proposal to the Section Coordinators (refer to the website, <http://wssa.asu.edu/sections/default.htm>, for a complete list and contact information).

Deadline for proposals is: December 1, 2009. Please include the following information:

- Title of Presentation
- Name, Affiliation, Mailing Address, Telephone Numbers and Email Address
- Other Authors
- Appropriate Section
- Abstract (not to exceed 200 words)

Scholars willing to serve as moderators or discussants should indicate their interest to the appropriate Section Coordinator listed on the website. All participants are required to register for the conference prior to March 1, 2010.

For additional information, please consult the Fall 2009 WSSA newsletter or contact the WSSA General Program Chair and President- Elect:

Gil Fowler
Arkansas State University
The Honors College
PO Box 2559
State University, AR 72467-2559
TEL: 870-972-2308 FAX: 870-972-3884
E-mail: gflower@astate.edu or gilfowler@hotmail.com

STUDENT PAPER AWARD WINNERS: CONGRATULATIONS!

Best Graduate Paper

 **Tatjana K. Rosev, University of New Mexico**
Reaching for the Stars: Acculturative Experiences of German Sojourners
on a Southwestern Air Force Base

Best Undergraduate Paper

 **Veronica Menard, Metropolitan State College of Denver**
The Perception of Homelessness in Urban and Suburban Settings

Honorable Mention

 **Amy Lewis, Colorado State University**
County Conservation, but for Whom? Indigenous Natural Resource Control, Social Movements, and the Struggle for Legitimacy in Mexico and Chile

SPECIAL EVENTS

Professional Development Luncheon

Thursday • 11:30 am – 12:45 pm • Pavilion VI • Ticketed Event



Larry A. Gould, PhD
Associate Vice President and Campus
Executive Officer
Northern Arizona University – Yuma
Branch Campus

Larry A. Gould, in addition to his academic position, is the Executive Director of the WSSA, overseeing the general operation of the Association. Prior to completing his Ph.D. in Sociology with a minor in Criminal Justice and Experimental Statistics from Louisiana State University, Gould had a successful career in law enforcement. He continues today as one of the leading consultants in the nation in the development and analysis of policies and procedures for police departments and their insurers.

Your Professional Portfolio and Your Path to Promotion & Tenure

This is a special presentation intended for graduate students, new scholars on the path to promotion and tenure, and/or scholars in need of information that will aid in the development of a professional portfolio.

Topics Covered:

- Development of the professional vita
- Development of the extended vita
- Development of the teaching, service, and scholarly portfolios
- Development of statements of philosophy on teaching, service, and research
- Organization of files for tracking your progress toward promotion and tenure or promotion

Cost: \$10.00, (This includes the cost of the lunch)
Registration is limited. Reservations are recommended.

SSJ Professional Development Session

Thursday • 1:00 pm - 2:30 pm
Pavilion VI • Open to All



At the SSJ Publication Workshop, **Prabha Unnithan** (Colorado State University), Editor, and **Rich Greene**, (Northern Illinois University) Book Review Editor, respectively, will discuss their editorial philosophies, submission (both traditional and online), review, and decision-making procedures for articles and reviews. Attendees will have the opportunity to learn about what goes on "backstage" at a major social science journal and to ask general questions regarding SSJ's publication process

This is a rare opportunity to understand the inner workings of a professional academic journal. This is a free/open event, and ALL welcome!



Special Presentation: Student Paper Competition Presentation of Winners

Thursday • 2:45 pm – 4:15 pm
Pavilion VI • Open to All



Moderator Cynthia A. Klima, *State University of New York – Geneseo*
Discussants Karma Chavez, *University of New Mexico*
Gesemia Nelson, *Metropolitan State College of Denver*

Reaching for the Stars: Acculturative Experiences of German Sojourners on a Southwestern Air Force Base

Tatjana K. Rosev, *University of New Mexico*

The Perception of Homelessness in Urban and Suburban Settings

Veronica Menard, *Metropolitan State College of Denver*

Conservation, but for Whom? Indigenous Natural Resource Control, Social Movements, and the Struggle for Legitimacy in Mexico and Chile

Amy Lewis, *Colorado State University*



Special Screening of the movie

"Made in LA"

2008 National Emmy Winner

Jointly sponsored by the
Western Social Science Association and the **Association for Borderland Studies**
4:30-6:00 p.m., Pavilion VI



This is the remarkable story of three Latina immigrants working in Los Angeles garment sweatshops who decide to resist. Through a groundbreaking lawsuit and consumer boycott, they fight to hold a giant American retailer liable for the labor conditions under which its products are manufactured. Compelling and deeply human, **Made in L.A.** is a story about immigration, the power of unity, and the courage it takes to find your voice.

Distributed by CALIFORNIA NEWSREEL. For more information on the film please go to: www.newsreel.org.

WSSA President's Reception (All are Invited)

Food, Drinks, and Conversation

Come join your colleagues to celebrate the successful conclusion of the 51st Annual Conference of the WSSA. *Hors d'oeuvres* will be served, and each person will receive a complimentary drink ticket.

We will also honor those hard working officers that have completed their term of office. Thank you!

6:30 p.m. to 8:00 p.m.

Fiesta Rooms

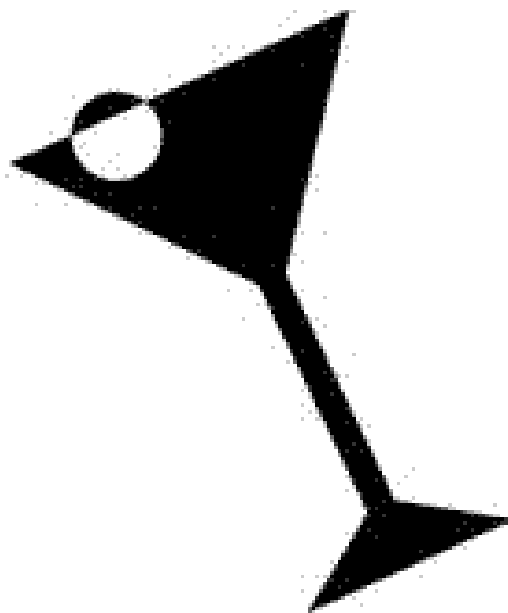

HYATT REGENCY ALBUQUERQUE

2nd Floor

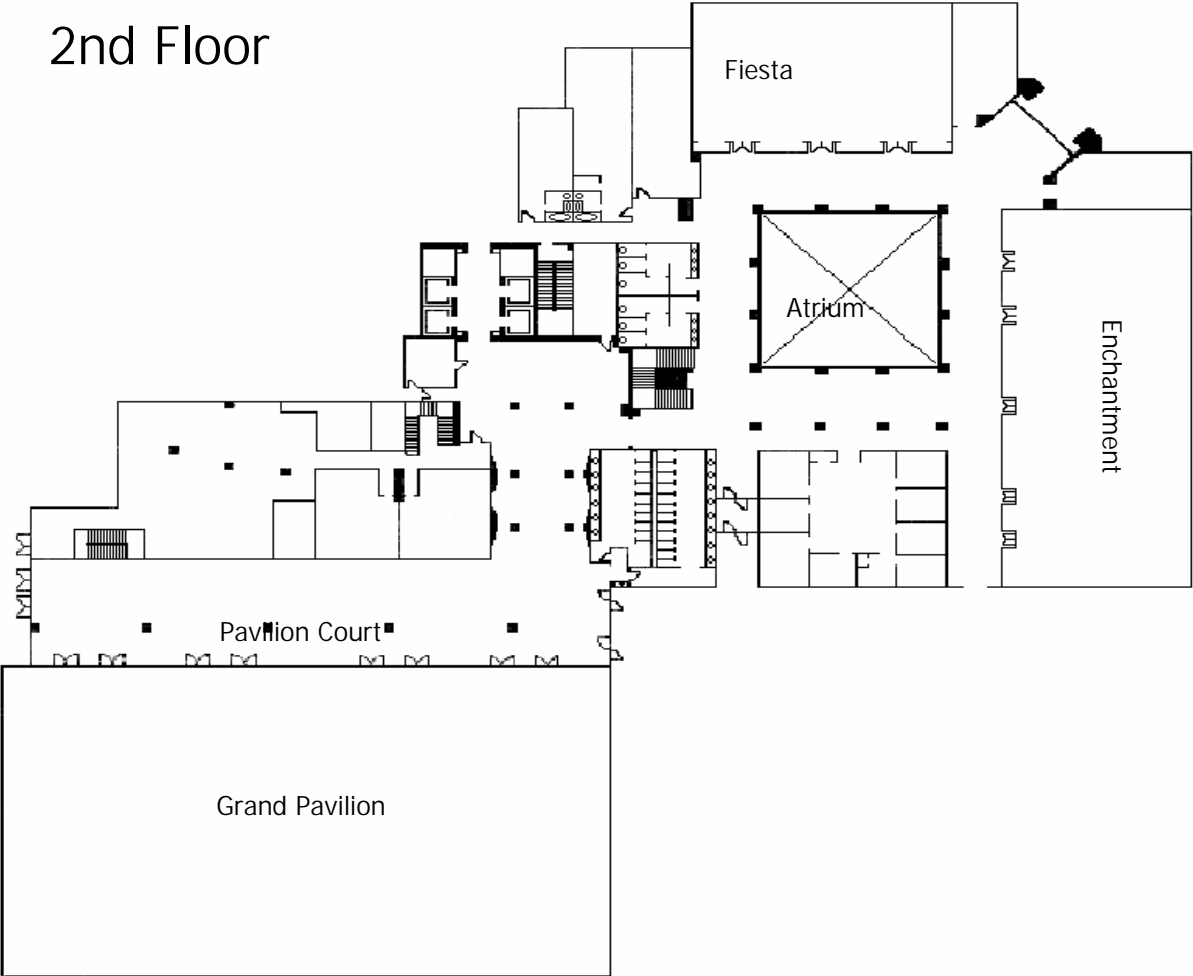

First Floor

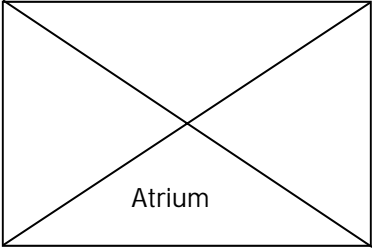

PROGRAM OVERVIEW & SPECIAL EVENTS

WEDNESDAY, April 15, 2009

EVENT	TIME	LOCATION
WSSA Executive Council Meeting	7:30 am to 4:00 pm	SIERRA VISTA
Conference Registration	3:00 pm to 6:45 pm	PAVILION LANDING
Welcome Reception	6:00 to 7:30 pm	Fiesta Rooms

THURSDAY, April 16, 2009

Conference Registration	7:30 am to 5:00 pm	PAVILION LANDING
Publishers' Book Exhibit	8:00 am to 6:00 pm	PAVILION COURT
Concurrent Panel Sessions	8:00 am to 6:00 pm	SEE PROGRAM
African and African American Studies Meet and Greet	8:00 am – 9:30 am	BOARDROOM NORTH
Coffee Break	9:15 am	PAVILION COURT
Professional Development Luncheon (Ticketed Event) WSSA Executive Director, Larry Gould	11:30 am to 12:45 pm	PAVILION VI
Association for Institutional Thought Business Meeting	11:45 am – 1:00 pm	PAVILION V
JBS <i>Journal of Borderland Studies</i> Editors Meeting	12:00 Pm – 1:00 pm	McGrath Bar & Grill (Hyatt)
SSJ Professional Development Session SSJ Editor, Prabha Unnithan Book Review Editor, Richard Greene	1:30 pm to 2:30 pm	PAVILION VI
Coffee Break	2:30 pm	PAVILION COURT
Student Paper Competition: Paper Presentation of Winners	2:45 pm to 4:15 pm	PAVILION VI
Association of Arid Lands Studies Business Meeting	4:30 pm – 6:00 pm	BOARDROOM EAST
Chicano Studies/Land Grants Meeting	4:30 pm – 6:00 pm	ENCHANTMENT B
American Indian Studies Section Meeting	6:15 pm to 7:15 pm	PAVILION II & III
AFIT 30 th Anniversary Banquet (transportation provided)	7:00 pm – 9:30 pm	Sadie's Cocinita

PROGRAM OVERVIEW & SPECIAL EVENTS

FRIDAY, April 17, 2009

EVENT	TIME	LOCATION
Conference Registration	7:30 am to 5:00 pm	PAVILION LANDING
Continental Breakfast	7:30 am to 9:00 am	PAVILION VI
Publishers' Book Exhibit	8:00 am to 6:00 pm	PAVILION COURT
Concurrent Panel Sessions	8:00 am to 6:00 pm	SEE PROGRAM
African and African American Studies Meet and Greet	8:00 am to 6:00 pm	BOARDROOM NORTH
Coffee Break	10:00 am	PAVILION COURT
Presidential Luncheon and Address WSSA President Phadrea Ponds <i>Student Paper Awards will be presented at this time.</i>	11:30 am to 12:45 pm	PAVILION VI
Association of Borderland Studies Board Members and Officers Meeting	12:00 pm to 1:00 pm	McGrath Bar & Grill (Hyatt)
Coffee Break	2:30 pm	PAVILION COURT
WSSA Business and Section Coordinators Meeting (Current and New Section Coordinators must attend)	4:30 pm to 5:30 pm	PAVILION I
Association of Borderland Studies Members' Business Meeting	6:00 pm – 7:45 pm	SERNDERO III
Association of Borderland Studies Welcoming Reception	8:00 pm – 9:30 pm	Tucanos Bar & Grill

SATURDAY, April 18, 2009

WSSA Breakfast and Executive Council Meeting	7:30 am to 12:30 pm	SIERRA VISTA
Conference Registration	7:30 am to 1:00 pm	PAVILION LANDING
Human Communication Section Business Meeting	8:00 am to 9:30 pm	SAGE
Coffee Break	9:15 am	PAVILION COURT
Publishers' Book Exhibit	8:00 am to 1:00 pm	PAVILION COURT
Concurrent Panel Sessions	8:00 am to 6:00 pm	See Program
Special Screening of the Movie: "Made in LA"	4:30 pm to 6:00 pm	PAVILION VI
WSSA President's Reception	6:30 pm to 8:00 pm	FIESTA ROOMS

**African-American and
African Studies**

Theodore Ransaw
University of Nevada, Las Vegas

American Indian Studies

Thomas J. Hoffman
St. Mary's University
and

Elizabeth Keith
St. Mary's University

American Studies

Daniel J. McInerney
Utah State University

Arid Lands Studies & Geography

Richard Greene
Northern Illinois University

Asian Studies

Linda H. Chiang, Ed. D.
Azusa Pacific University
and

Walter Y. Kiang
Los Angeles County
Dept. of Children and Family Services

**Association for Borderland
Studies (ABS)**

Tony Payan

Canadian Studies

Father Thomas Murphy, S.J.
Seattle University

Chicano Studies/Land Grants

Aileen Lucero
Metropolitan State College of Denver
and

Louis M. Holscher
San Jose State University
and

Eric Romero
New Mexico Highlands University

**Chronic Disease and
Disability (& RC-49, Research
Committee on Mental Health and
Illness of the International
Sociological Association)**

J. Gary Linn
Tennessee State University
and

Steven Brown
The University of Hawaii at Manoa
and

Debra R. Wilson
Tennessee State University

**Criminal Justice and
Criminology**

Steven Patrick
Boise State University
and

Eileen Luna-Firebaugh
University of Arizona

**Economics (Association for
Institutional Thought)**

Daniel Underwood
Peninsula College

**Economics (Business and
Finance)**

Kashi Nath Tiwari
KNT's Academic Financial Research

Economics (General)

Scott Carson
University of Texas – Permian Basin

**Environmental Policy and
Natural Resources Management**

Dwight C. Kiel
University of Central Florida

History

T. H. Baughman
University of Central Oklahoma

Human Communication

Brant Short
Northern Arizona University
and

Dayle Hardy-Short
Northern Arizona University

Latin American Studies

Ramón Gómez Zamudio
University of Guadalajara
and

Jorge A. Rosales Saldaña
University of Guadalajara

Mass Communication

Gil Fowler
Arkansas State University

New Zealand and Australia Studies

William C. Schaniel
University of West Georgia

Political Science

Jack W. Hou
California State University, Long Beach

Public Administration

Victor L. Heller
University of Texas at San Antonio
and

Nathan A. Heller
Arizona State University

Public Finance and Budgeting

Zhirong (Jerry) Zhao
University of Minnesota
and

Michael Moody
University of Kansas

Rural Studies

Anthony Amato
Southwest Minnesota State
University
and

Suzanne Kelley
North Dakota State University

Slavic Studies

Mark A. Cichock
University of Texas at Arlington

Sociology

Heather Albanesi
University of Colorado-Colorado Springs

Urban Studies

Thomas Sammons
University of Louisiana - Lafayette

Women's Studies

Diane Calloway-Graham
Utah State University

AFRICAN & AFRICAN AMERICAN STUDIES

Theodore Ransaw

University of Nevada, Las Vegas

SPECIAL EVENT

AFRICAN & AFRICAN AMERICAN STUDIES MEET & GREET

THURSDAY
8:00 – 9:30 AM

Boardroom North

PANEL 1

Moderators

New Trends in African and African American Higher Education

Scott Carson, *University of Texas, Permian Basin*

Ruth Githumbi, *University of St. Thomas*

THURSDAY
9:45 – 11:15 AM

Boardroom North

Creating Accountability in Higher Education

Stuart Zisman, *Walden University*

African American Males: Expectations, Retention and Graduation

Stephen Brown, *Azusa Pacific University*

Theodore Ransaw, *University of Nevada Las Vegas*

The Relationship between White Faculty and African American College Student Retention

Monica Green, *Texas A&M University*

PANEL 2

Moderators

Global Trends in African and African American Education

Barbara Hewins-Maroney, *Wellesley College, University of Nebraska at Omaha*

Morgen Maroney, *Wellesley College, University of Nebraska at Omaha*

Lynette Nickleberry, *University of Missouri-Columbia*

THURSDAY
1:00 - 2:30 PM

Boardroom North

Race Space and Place: The Luminal Function of Ritual in Global Hip-hop

Theodore Ransaw, *University of Nevada, Las Vegas*

Alternatives for Africa: Exploring America's Foreign Policy through African-American Intellectuals

Ruth Githumbi, *University of St. Thomas*

Repercussions of Failed Promises of Inclusion and Diversity

Stuart Zisman, *Walden University*

African & African American Studies

PANEL 3

Moderator

Indigenous Perspectives and Best Practices in Educating the Whole Child

Jaime Gaskin Eyrich, *Center for Lifelong Education, Institute of American Indian Arts*

**THURSDAY
1:00 – 2:30 PM**

Pavilion II & III

**Cross - listed with
American Indian
Studies**

Indigenous Perspectives and Best Practices in Educating the Whole Child: Shared Experiences in School Reform, Curriculum, Development, Teaching, Learning and School Achievement in the United States and Southern Africa

Jaime Gaskin Eyrich, *Institute of American Indian Arts*

Hayes A. Lewis, *Institute of American Indian Arts*

Stephen Fadden, *Institute of American Indian Arts*

Leatrice Lewis, *Institute of American Indian Arts*

PANEL 4

Roundtable: Strategies to Create a Friendlier Collegial Environment at the WSSA

**THURSDAY
2:45 – 4:15 PM**

Boardroom North

Moderator: Stuart Zisman, *Walden University*

PANEL 5

Moderators

African and African Americans Influence on the Media

Stephen Brown, *Azusa Pacific University*

Monica Greene, *Texas A&M University*

**THURSDAY
4:30 – 6:00 PM**

Boardroom North

Changing the face of Public Affairs: A look at How Social Networking is Impacting the Business of the Public Sector

Michael O. Adams, *Texas Southern University*

Linda Smith, *Texas Southern University*

Developing Radio Diversity in the 1920's

Michele Ferm, *Independent Researcher*

MEET & GREET

**FRIDAY
8:00 – 9:30 AM**

Boardroom North

PANEL 6
Moderators
African and African American Gender Issues
Michael O. Adams, *Texas Southern University*
Linda Smith, *Texas Southern University*
Michele Ferm, *Independent Researcher*

FRIDAY
9:45 – 11:15 AM

Boardroom North

How Do Girlfriends Talk about Sex in the City?: A Qualitative Comparative Analysis of Womanist and Feminist Themes

Theodore Ransaw, *University of Nevada Las Vegas*

A New Era/Old Woes: Health Disparities and the Sexual and Reproductive Rights of Black Women

Barbara Hewins-Maroney, *Wellesley College, University of Nebraska at Omaha*
Morgen Maroney, *Wellesley College, University of Nebraska at Omaha*

Exploring African American Masculinities

Lynette Nickleberry, *University of Missouri-Columbia*

PANEL 7
Moderators
Increasing African and African American Awareness of Health Disparities
Linda Smith, *Texas Southern University*
Ruth Githumbi, *University of St. Thomas*

FRIDAY
1:00 – 2:30 PM

Boardroom North

The Effects of Insulation on 19th Century African-American Stature and Health

Scott Carson, *University of Texas, Permian Basin*

A Multi-dimensional Approach to Health Disparities by a Marginalized Multi-cultural Coalition

Stuart Zisman, *Walden University*

PANEL 8
Roundtable: Recruitment Starts at Conception and Early Childhood

FRIDAY
2:45 – 4:15 PM

Boardroom North

Moderator: Stuart Zisman, *Walden University*

PANEL 9
Roundtable: Minority Higher-Ed Recruitment and Retention

FRIDAY
4:30 – 6:00 PM

Boardroom North

Moderators: Stephen Brown, *Azusa Pacific University*
Michele Ferm, *Independent Researcher*
Theodore Ransaw, *University of Nevada Las Vegas*

**African & African American
Studies**

PANEL 10 Roundtable: Navigating the Academy

**SATURDAY
9:45 – 11:15 AM**

Boardroom North

Moderators: Stephen Brown, *Azusa Pacific University*
Theodore Ransaw, *University of Nevada Las Vegas*

PANEL 11 Community Outreach Strategies to Recruit African American into the Hard Sciences

**SATURDAY
1:00 – 2:30 PM**

Boardroom North

Moderators: Theodore Ransaw, *University of Nevada Las Vegas*
Stephen Brown, *Azusa Pacific University*

PANEL 12 Roundtable: How Metro State College Denver Starts Recruiting in Elementary School

**SATURDAY
2:45 – 4:15 PM**

Boardroom North

Moderator: Stuart Zisman, *Walden University*

AMERICAN INDIAN STUDIES

Thomas J. Hoffman

St. Mary's University

Elizabeth Keith

St. Mary's University

PANEL 1

Moderator

Indians and the Law

Daniel Wildcat, *Haskell Indian Nations University*

**THURSDAY
8:00 – 9:30 AM
Pavilion II & III**

The Magna Carta and the Constitution of the Iroquois Confederacy: Foundations of the United States Constitution

Lilias Jones Jarding, *South Dakota State University*

The UN Declaration on the Rights of Indigenous Peoples: Why So Long and So Difficult?

Sheryl Lightfoot, *University of Minnesota*

Treaties between Nations; Interrelationships of the Saltwater Peoples

Georgina Olsen (TIZOT), *University of Victoria*

PANEL 2

Moderator

Indigenous and Western Views of Nature

Tom Hoffman, *St. Mary's University*

**THURSDAY
9:45 – 11:15 AM
Pavilion II & III**

Sacred Places at Risk

Suzan Shown Harjo, *The Morning Star Institute*

Falsely Accused: Nature in the Judeo-Christian Tradition and Aristotle's Influence

Tom Hoffman, *St. Mary's University*

Native Philosophy and Should Trees Have Standing? Revisiting and Indigenizing an Environmental Classic on the Rights of Nature

Steve Pavlik, *Northwest Indian College*

Indigenous Views of Nature

Daniel Wildcat, *Haskell Indian Nations University*

PANEL 3

Moderator

Indigenous Perspectives and Best Practices in Educating the Whole Child

Jaime Gaskin Eyrich, *Center for Lifelong Education, Institute of American Indian Arts*

**THURSDAY
1:00 – 2:30 PM
Pavilion II & III**

Indigenous Perspectives and Best Practices in Educating the Whole Child: Shared Experiences in School Reform, Curriculum, Development, Teaching, Learning and School Achievement in the United States and Southern Africa

Jaime Gaskin Eyrich, *Institute of American Indian Arts*

Hayes A. Lewis, *Institute of American Indian Arts*

Stephen Fadden, *Institute of American Indian Arts*

Leatrice Lewis, *Institute of American Indian Arts*

**Cross - listed with
African and African
American Studies**

American Indian Studies

PANEL 4

Moderator

American Indians: Theoretical Perspectives

William Haas Moore

**THURSDAY
2:45 – 4:15 PM
Pavilion II & III**

Sustainability and the World Indigenous Movement: An Ontological Politics

Peter J. Jacques, *University of Central Florida*

A Strange Attraction: Vine Deloria Jr.'s God is Red and Complexity Theory

Nicholas C. Peroff, *University of Missouri-Kansas City*

Moving Towards a New Model of Research with Indigenous Nations: Ethical and Practical Issues in Tribal Community-Based Participatory Research

Karen Jarratt-Snider, *Northern Arizona University*

America's Errand: Wilderness and 'Indians' in Cinema

Rick Wheelock, *Fort Lewis College*

PANEL 5

Moderator

Women in Indian Country

Diane Pearson, *University of California - Berkeley*

**THURSDAY
4:30 – 6:00 PM
Pavilion II & III**

Experiences of American Indian Women Doctoral Students in Mainstream Universities

Mary Jo Tippeconnic Fox, *University of Arizona*

Melissa Blind, *University of Arizona*

Women Spirit Rising: The Religious and Political Beliefs of Native American Women

Elizabeth Keith, *St. Mary's University*

Apache Na'ii'ees vs. Navajo Kinaalda: Comparison of the Ceremonial Components of the Navajo and Apache Girls Coming of Age Rites

William B. Tsosie Jr., *Fort Lewis College*

SPECIAL EVENT

American Indian Studies

Section Meeting

**THURSDAY
6:15 – 7:15 PM**

Pavilion II & III

PANEL 6

Moderator

Indian Education in the West

Billie Jo Kipp, *University of New Mexico*

**FRIDAY
8:00 – 9:30 AM**

Pavilion II & III

Beyond the Economic Consequences of Indian Gaming: Examining Educational Differences in New Mexico Public Schools

Thaddeus W. Conner, *The University of Oklahoma*

William A. Taggart, *New Mexico State University*

Unsettling the West: Montana's "Indian Education for All" Act and the White Undergraduate

Seán Patrick Eudaily, *University of Montana Western*

Multi-Cultural Attitudes toward Compulsory Education in Nineteenth-Century Four Corners Communities

William Haas Moore

PANEL 7

Moderator

Discussant

The AIO Ambassadors Program

Stephen M. Sachs, *IUPUI*

LaDonna Harris, *Americans for Indian Opportunity*

**FRIDAY
9:45 – 11:15 AM**

Pavilion II & III

The AIO Ambassadors Program: Nurturing Leadership, Building a Network for Indian Country and the Indigenous World

Panelists:

LaDonna Harris, *Americans for Indian Opportunity*

Stephen M. Sachs, *IUPUI*

Stephanie Poston, *AIO Ambassador Alumni*

Ron Looking Elk, *AIO Ambassador Alumni*

PANEL 8

Moderator/Discussant

Native American Criminal Justice

Steven Patrick, *Boise State University*

**FRIDAY
9:45 – 11:15 AM**

Pavilion I

Cross - listed with

**CRIMINAL JUSTICE
& CRIMINOLOGY**

Navajo Juveniles and Alcohol Related Arrests in Arizona: A Longitudinal Comparative Analysis

Randall R. Butler, *University of Texas at Arlington*

Michele L. Whitehead, *University of Texas at Arlington*

An Addition to Anomie Theory

David T. McCanna, *University of California Riverside*

The Effect of Official versus Self Attribution of American Indian/Alaska Native Racial Identity on Patterns of Drug Use by Recent Arrestees

Darryl Wood, *Washington State Univ. Vancouver*

Bradley Myrstol, *University of Arkansas*

American Indian Studies

PANEL 9
Moderator

Native American Criminal Justice as An Evolving Area Of Study
William G. Archambeault, *Minot State University*

FRIDAY
1:00 - 2:30 PM

Pavilion II & III

Cross - listed with

**CRIMINAL JUSTICE
& CRIMINOLOGY**

Native American Criminal Justice: Simply a Topic of Current Academic Interest or an Area of Study Evolving into its Own Discipline

William G. Archambeault, *Minot State University*

The Importance of Native American Philosophy in Shaping the Restorative Justice Movement: A First for the First Nations

Jon'a Meyer, *Rutgers University*

Appropriate Research Methods for the Study of Native American Criminal Justice

Marianne O. Nielsen, *Northern Arizona University*

PANEL 10
Moderator

Issues in Indian Country
Rick Wheelock, *Fort Lewis College*

FRIDAY
2:45 – 4:15 PM

Pavilion II & III

Indigenous Leadership: How the Thoughts of Past Navajo Tribal Chairman Jacob C. Morgan Might Create the Ideas Needed to Develop Indigenous Leadership Development Theory for the 21st Century

Lloyd L. Lee, *University of New Mexico*

Internal Exile: Recovering the Hia C-ed O'odham Community of Southern Arizona

David Martinez, *Arizona State University*

1879: The Year of Western Development, Federal Surveys, Broken Treaties, and Ute, Umatilla, and Nimiipuu Land Loss

Diane Pearson, *University of California, Berkley*

Margaret Mead's Unpublished Field Notes on The Omaha Tribe

Peter T. Suzuki, *University of Nebraska at Omaha*

PANEL 11
Moderator

Native Views of Animal Peoples: Two-leggeds, Four-leggeds, and the Swimming Peoples
Jeff Corntassel, *The University of Victoria*

FRIDAY
4:30 – 6:00 PM

Pavilion II & III

The Whale's Breath

Redwing Cloud, *Evergreen College*

Co-Management: The Continuing Struggle over Treaty Fishing Rights

Mary Olson, *Cornell College*

Souls and Spirits of the Animal People: Native Views of Death and the Afterlife among Non-Human Entities

Steve Pavlik, *Northwest Indian College*

PANEL 12
Moderator

American Indian History
Nicholas C. Peroff, *University of Missouri-Kansas City*

SATURDAY
8:00 – 9:30 AM
Pavilion II & III

The Winters Doctrine: Its Legal Role in Conflict and Negotiation
Kira Russo Bauer, *Northern Arizona University*

Our Solar System's History Memorialized in Lakota Tradition
Denny Gayton, *Haskell Indian Nations University*

Where Two Rivers Meet but Only One Continues: Addressing the Silence on 2nd Wave Missionization in BC Historiography
Emma Battell Lowman, *Government of British Columbia, Canada*

PANEL 13
Moderator

Decolonization
Elizabeth Keith, *St. Mary's University*

SATURDAY
9:45 – 11:15 AM
Pavilion II & III

Good News For a Change?: North American Radicals and Indigenous Liberation
Adam Barker, *University of Victoria*

Insurgent Education: Unsettling Truths about Covert Colonialism
Jeff Corntassel, *University of Victoria*

Decolonize Your Mind. Okay Where do I Start? The Search for the 'Original Man'
Leo Killback, *University of Arizona*

PANEL 14
Moderator

Indian Education
Mary Jo Tippeconnic Fox, *University of Arizona*

SATURDAY
1:00 – 2:30 PM
Pavilion II & III

Native Language Immersion Programs: An Investigation of Cognitive, Psychological and Social benefits
Billie Jo Kipp, *University of New Mexico*

Tribal-Academic Collaboration: Challenges, Opportunities and Benefits of Working with Federally Non-recognized Tribes
Erich Steinman, *Pitzer College*
Scott Scoggins, *Pitzer College*

AMERICAN STUDIES

Daniel J. McInerney

Utah State University

PANEL 1 **Revolutionary Turns: Protest and Identity**

Moderator /Discussant Daniel J. McInerney, *Utah State University*

THURSDAY
9:45 – 11:15 AM

Enchantment A

The Quebec Act of 1774: The Founding of an American Identity

Vernon P. Creviston, *California State University, Fresno*

Father Bombo's Pilgrimage to Mecca and Cultural Upheaval: Brackenridge, Freneau, and Undergraduate Uncertainty at the College of New Jersey

Darrin L. Grinder, *Northwest Nazarene University*

PANEL 2 **A Roundtable Discussion on Teaching**

Moderator Sarah Swedberg, *Mesa State College*

THURSDAY
1:00 – 2:30 PM

Enchantment A

Cross - listed with
SOCIOLOGY

Teaching to the Top or Teaching to the Bottom?

Sarah Swedberg, *Mesa State College*

Adele Cummings, *Mesa State College*

Maria Boikova Struble, *Western State College*

Martha E. Kinney, *Suffolk County Community College*

Pattie Dillon, *Spalding University*

PANEL 3 **Justice and Democracy in 20th Century American Studies**

Moderator Darrin L. Grinder, *Northwest Nazarene University*

THURSDAY
2:45 – 4:15 PM

Enchantment A

Selective Histories of Transgression: Using Justice and Creating the Imagined Nation: The Case of Navajo Justice in the Early 20th Century

Sondra Leftoff, *John Jay College of Criminal Justice*

PANEL 4 **The Young and Young at Heart: Age and Gender in American Studies**

Moderator/Discussant Daniel J. McInerney, *Utah State University*

THURSDAY
4:30 – 6:00 PM

Enchantment A

Creating the Disney Princess: Popular Ideas about Womanhood as Promoted through Disney

Kathryn Anderson-Holmes, *Utah State University*

ARID LANDS & GEOGRAPHY

Richard P. Greene
Northern Illinois University

PANEL 1 **Empirical Evidence about Water Shortages and Monitoring Aridity**
Moderator Daniel Kuester, *Kansas State University*

THURSDAY
8:00 - 9:30 AM
Boardroom East

Urban Water Supply on the Texas High Plains: Dwindling Lake Meredith
Otis Templer, *Texas Tech University*

San Pedro River Storm Flow as a Climate Change Indicator for Northwestern Mexico and Southeastern Arizona, 1913-2007

Conrad Moore, *Western Kentucky University*

Spatial Variation of Soil Salinity in the Mexicali Valley, Mexico: Application of a Practical Method for Agricultural Monitoring

Gabriel Judkins, *Arizona State University*

PANEL 2 **Affects of Aridity on Observed and Optimal Behavior**
Moderator Otis Templer, *Texas Tech University*

THURSDAY
9:45 - 11:15 AM
Boardroom East

Studying Arid State Voting Behavior during Recent Presidential Elections

Daniel Kuester, *Kansas State University*

Shane Sanders, *Nicholls State University*

Global Climate Change: Beliefs -- Public Policies and Private Actions

Richard K. Ford, *University of Arkansas*

David Gay, *University of Arkansas*

Charles Britton, *University of Arkansas*

Decision Making in the Face of Reduced Irrigation Allocations

Paul Clark, *Kansas State University*

Kevin Dhuyvetter, *Kansas State University*

Bill Golden, *Kansas State University*

Terry Kastens, *Kansas State University*

Kara Ross, *Kansas State University*

Leah Tsoodle, *Kansas State University*

PANEL 3 **Economic Trends and Aridity**
Moderator David Gay, *University of Arkansas*

THURSDAY
1:00 - 2:30 PM
Boardroom East

Investigating Health Insurance Coverage: An Arid / Non-Arid State Analysis

Joseph Earley, *Loyola Marymount University*

Tara Schreiner, *Loyola Marymount University*

Effects of the Current Economic Slowdown on Arid States

Daniel Kuester, *Kansas State University*

**Arid Lands &
Geography**

PANEL 4
Moderator

The Sale and Rationing of Water: Issues at the State Level
Kara Ross, *Kansas State University*

**THURSDAY
2:45 – 4:15 PM**

Boardroom East

Selling Water across State Lines: The Case of Arkansas

Richard K. Ford, *University of Arkansas*
David Gay, *University of Arkansas*
Charles Britton, *University of Arkansas*

Water Rationing: A Balanced Distribution of Water in California

Seid M. Zekavat, *Loyola Marymount University*

Association for Arid Lands Studies Business Meeting

**THURSDAY
4:30 – 6:00 PM**

Boardroom East

PANEL 5
Moderator

Topics in Human Geography
Rich Greene, *Northern Illinois University*

**FRIDAY
8:00 – 9:30 AM**

Boardroom East

What is Noteworthy in an Arid Landscape? Assessing the Saliency of Geographic Features as Indicated by Place Names in Mali, West Africa

Chris Duvall, *University of New Mexico*

Spatial Dimensions of Chicago's Housing Boom to Bust: Mapping the Dynamics of Home Sales 2000 - 2008

Pete Piet, *City of Elmhurst, IL*

Globalization's Impact on the Inland Empire's Industrial Geography: Focus on Small Business Dynamics

Rich Greene, *Northern Illinois University*

ASIAN STUDIES

Linda H. Chiang

Azusa Pacific University

Walter Y. Kiang

*Los Angeles County, Department
of Children and Family Services*

PANEL 1

Moderators
Discussant

Conflicts and Productivity

Linda H. Chiang, *Azusa Pacific University*
Linda H. Chiang, *Azusa Pacific University*

**FRIDAY
8:00 - 9:30 AM**

Enchantment A

The Role of Scholars in Community Conflict in China: A Research Note from Two Case Studies

Lihua Yang *Arizona State University*
G. Zhiyong Lan, *Arizona State University*

Are Asians the "Model Minority" Group? Examining the Research Productivity across the Various Sub-ethnic Asian Groups

Meghna Sabharwal, *City College of New York*

The Making of Indian Immigrant Entrepreneurs in the United States

Roli Varma, *University of New Mexico*

PANEL 2

Moderator/Discussant

Ideology and Images of Asians

Walter L. Kiang, *County of Los Angeles*

**FRIDAY
9:45 - 11:15 AM**

Enchantment A

Enhancing Leader Awareness of Cultural Sensitivities to Better Serve Asian American Students

Elizabeth Acevedo, *Claremont Graduate University*

The Making of Arts can Unify Chinese Culture

Becky Roe, *Azusa Pacific University*

Observation and Reflection from a Tibetan Family in Sichuan China: A Case Study

Linda H. Chiang, *Azusa Pacific University*

PANEL 3

Facilitator:

Symposium: The Educational Reforms in East Asia

Chris Yoon, *Azusa Pacific University*

**FRIDAY
1:00 - 2:30 PM**

Enchantment A

Panelists:

Chris Yoon, *Azusa Pacific University*
Jenny Yau, *Azusa Pacific University*
Linda H. Chiang, *Azusa Pacific University*
Dick Tak-sang Yau, *Biola University*

PANEL 4

Moderator
Discussant

Asians and Information Technology

Linda H. Chiang, *Azusa Pacific University*
Roli Varma, *University of New Mexico*

**FRIDAY
2:45 – 4:15 PM
Enchantment A**

Patterns of the Internet Usage and Related Factors with Internet Addiction of Korean Teenagers

Hyojin Song, *University of New Mexico*

Beauty is in the Eye of the QQ User: Instant Messaging in China

Pamela Koch, *Grand Valley State University*

Brad Koch, *Grand Valley State University*

Kun Huang, *University of New Mexico*

PANEL 5

Roundtable: The 2008 Presidential Election of the Republic of China and its Impact and Significance

**FRIDAY
4:30 – 6:00 PM
Enchantment A**

Panelists:

Yu-long Ling, *Franklin College*

James C. Hsiung, *New York University*

John Wood, *Franklin College*

Wen-hui Tsai, *Indiana-Purdue University at Fort Wayne*

PANEL 6

Moderator
Discussants

The Life of the Elderly in Taiwan

Wen-hui Tsai, *Indiana-Purdue University at Fort Wayne*

Walter Y. Kiang, *County of Los Angeles*

Wen-hui Tsai, *Indiana-Purdue University at Fort Wayne*

**FRIDAY
4:30 – 6:00 PM
Pavilion I**

Patterns of Leisure Activities among the Elderly in Taiwan

Shir-fun Hwang, *National Cheng-kung University, Taiwan*

Changing Life Styles of Elderly Taiwanese and Their Health: A Life Course Perspective

Wei Lei, *National Cheng-kung University, Taiwan*

The Application of Elderhostel in Taiwan: A Feasibility Study

Jr-shiuan Liang, *Hsuan Chuang University, Taiwan*

Li-hui Lin, *Hsuan Chuang University, Taiwan*

PANEL 7

Moderator
Discussant

Policies and Assessment in Asia Societies

Walter L. Kiang, *County of Los Angeles*

Yu-long Ling, *Franklin College*

**SATURDAY
9:45 - 11:15 AM
Enchantment A**

Taiwan's Entry to WTO and its Technological, Economic and Social Impacts on Taiwan Progress

Kuan-Hsiu Hsiao, *Taipei Economic and Cultural Office at Los Angeles*

Child Abuse and Neglect: The Case of Asian Population in Los Angeles County

Walter L. Kiang, *County of Los Angeles*

The Governments' Role in Marine Tourism: An Assessment of Thailand and Indonesia

Steven Parker, *University of Nevada, Las Vegas*

ASSOCIATION FOR BORDERLAND STUDIES

Tony Payan

Section Coordinator

James Scott

University of Joensuu

PANEL 1

Moderator/Discussant

Cross Border Regional Models, Citizenship and the Nation State

Joan Anderson, *University of San Diego*

**THURSDAY
8:00 - 9:30 AM**

Sendero II

European Borders, Project Territory and Joint Local Governance

Fabienne Leloup, *Facultés Universitaires de Mons, Académie de Louvain*
Sabine Duchamel, *Université du Littoral Côte d'Opale*

Of Belonging: Hyphenated Identities and the Citizenship Regime

T. Mark Montoya, *Northern Arizona University*

Euroregions, Eurodistricts, EGTC's": Reconceptualizations of European Regions and Regional Transnational Governance? An Actor-Oriented Model of Regional Transnationalism

Martin Klatt, *University of Southern Denmark*

Frontière et identité: la re-création dans les Corbières de l'Ancienne Frontière franco-espagnole de 1259

Christian Bataillou, *Université de Perpignan Via Domitia*

PANEL 2

Moderator/Discussant

Indigenous Peoples and the U.S. - Mexico Border: Militarization, Resistance, and Rights: Law and Rights

Jeffrey P. Shepherd, *University of Texas at El Paso*

**THURSDAY
8:00 - 9:30 AM**

Sendero III

Panelists:

Denise Gillman, *University of Texas at Austin - School of Law*
Eloisa Tamez, *University of Texas at Brownsville and Texas Southmost College*
(*Co-founder Lipan Apache Women Defense- Strength*)
Teresa Leal (*Opata-Mayo*) *Co-Founder of Las Comadres Ambos Nogales*
Jude Benavides, *University of Texas at Brownsville*
Enrique Madrid, *Independent Scholar*

PANEL 3

Moderator/Discussant

Binational Cooperation and Border Management

Roxanne Doty, *Arizona State University*

**THURSDAY
9:45 - 11:15 AM**

Sendero II

Regional Development in the U.S. - Mexican Border Region: Is This a Real Possibility or Just a Pipe Dream?

Kimberly Collins, *San Diego State University*
Salvador Espinosa, *San Diego State University*

The Role of Relational Networks in the Development of Complex Cross-Border Tourism Products: The Case of the Cathar Route in Catalonia and L'Ariège across the French Spanish Border

Joan Solé, *University of Girona*
Jaume Guia, *University of Girona*
Germà Coenders, *University of Girona*

Port of Entry Design, Location, and Management and Corresponding Effects on Border Wait Times

Joseph J. Lea, *San Diego State University*

Crecimiento Sostenido y Productividad Regional en México

Eliseo Díaz González, *El Colegio de la Frontera Norte*

PANEL 4

Moderator/Discussant

**Water and Environmental Conservation: The U.S. - Mexico Border and the
NAFTA Countries**

Donna Lybecker, *Colorado State University*

**THURSDAY
9:45 - 11:15 AM**

Sendero III

Water Conservation, Alternative Energy and the New Role of BECC/NADB

Oscar F. Ibáñez, *Universidad Autónoma de Ciudad Juárez*

Policies and Practices for the Conservation of Riparian Regions in Sonora

Donna L. Lybecker, *Idaho State University*

The CEC's Role in Transboundary Conservation along the U.S. - Mexico Border

Stephen Mumme, *Colorado State University*

Donna Lybecker, *Idaho State University*

Osiris Gaona, *Universidad Nacional Autónoma de México*

**Innovative Organization Models and Funding Plans for Air Improvement
Projects on the U.S. - Mexico Border**

Richard W. Ryan

SPECIAL EVENT

"No Wall Caucus"

Kathy Staudt, *University of Texas at El Paso*

Bring your own lunch to this open discussion on the

U.S. - Mexico Border Wall

**THURSDAY
11:30 AM – 12:45 PM**

Sendero III

Journal of Borderlands Studies

Editors Meeting

Emmanuel Brunet-Jailly

**THURSDAY
12:00 – 1:00 PM**

McGrath Bar & Grill

Hyatt Regency Hotel

PANEL 5 **Transmigration Patterns and Their Psychological Aspects**

Moderator/Discussant Javier Durán, *University of Arizona*

THURSDAY
1:00 – 2:30 PM

Sendero II

Migration and Symbols: Psychological Aspects of Migration Movements in the Polish German Border Region after the Accession to the Schengen Convention

Krzysztof Wojciechowski, *Collegium Polonicum, Słubice Poland*

Frontières Ouvertes, Frontières Fermées: L'immigration Maghrébine et les Contraintes de la Législation Européenne

Saida Latmani, *Abdelmalek Essaadi University*

Transmigración Laboral Urbana y Estructuración Social en Mexicali, Baja California

Agustín Sáenz Pérez, *Universidad Autónoma de Baja California*

Lya Margarita Niño Contreras, *Universidad Autónoma de Baja California*

Norma García Leos, *Universidad Autónoma de Baja California*

After the ICE Raids: Immigration and Refugee Integration in Greeley, Colorado

Christine Marston, *University of Northern Colorado*

PANEL 6 **The Continuing Militarization of Higher Education: Border Security Initiatives**

Moderator/Discussant Kathleen Staudt, *University of Texas at El Paso*

THURSDAY
1:00 – 2:15 PM

Sendero III

Militarization of the U.S. - Mexico Border

Timothy J. Dunn, *Salisbury University*

Minutemen: Vigilantes at the Border

Roxanne Doty, *Arizona State University*

Clandestine Border Crossing

David Spener, *Trinity University*

The Eisenhower Project

Aaron Belkin, *University of California at Santa Barbara*

PANEL 7 **Challenges and Opportunities for International Studies and Research in North American University Environments**

Moderator/Discussant Christopher Brown, *New Mexico State University*

THURSDAY
2:30 – 4:15 PM

Sendero II

Panelists:

Irasema Coronado, *University of Texas in El Paso*

Everett Egginton, *New Mexico State University*

Oscar Martinez, *University of Arizona*

Stephen Mumme, *Colorado State University*

Doug Nord, *Western Washington University*

Kathy Staudt, *University of Texas in El Paso*

PANEL 8

Invisible Indian Borderlands, Cultural Memories and Political, Economic and Ethnic Issues

Moderator/Discussant John Paul Nuno, *University of Texas at El Paso*

**THURSDAY
2:45 - 4:30 PM**

Sendero III

America's National Parks: (Re)Producing Invisible Indian Borderlands

Emily Lyons, *Northern Arizona University*

Bandidos, Buccaneers, Ballads, and the Border

Les Powner, *Keele University*

Santo Toribio: Martyr-Saint and Human –Trafficker

Thomas Evans, *Utah State University*

Place Identity and Inequality at the San Diego-Tijuana Border

Kristen Hill Maher, *San Diego State University*

PANEL 9

Constructing and Reconstructing the Border

Moderator/Discussant Juan Carlos Ramírez Pimienta, *San Diego State University*

**THURSDAY
4:30 - 6:00 PM**

Sendero II

Reclaiming the Frontier in National Geographic and Backpacker Magazines

Jamie Wilson, *University of Arizona*

The Wall on the Web: Representing the U.S. - Mexico Border in the New Media

Willie Costley, *University of Arizona*

Constructing the People: Governmentality and Fictive Ethnicity in the XIX Century U.S. Frontier

Ricardo Andrés Guzmán, *University of Arizona*

Some Notable Cross-boundary 'Kidnappings' along the U.S. - Mexico Border and Their Impact on Bilateral Relations: An Historical Perspective

Lawrence D. Taylor, *El Colegio de la Frontera Norte*

PANEL 10

Forms of Translocality across the British (Canadian) – USA Borderlands (1824 - 1872)

Moderator/Discussant A.K. McDougall, *U. Western Ontario and University of Alberta*

**THURSDAY
4:30 - 6:00 PM**

Sendero III

Levels of Translocality: The Individual and the Community 1820 - 1872

A.K. McDougall, *University of Western Ontario and University of Alberta*

Translocality and Emergent Identities in the Pacific Northwest 1820 - 1872

Lisa Phillips, *University of Alberta*

How Hawaiians became Indians: Negotiating Identity in the Oregon Territory

Daniel L. Boxberger, *Western Washington University*

PANEL 11

Indigenous Peoples and the U.S. - Mexico Border: Militarization, Resistance, and Rights: Militarization

Moderator/Discussant Margo Tamez, *Washington State University*

**FRIDAY
8:00 - 9:30 PM**

Sendero II

Panelists:

Timothy Dunn, *Salisbury University*

José Matus (Yoreme), *Alianza Indígena Sin Fronteras*

Gloria Valencia-Weber, *University of New Mexico—School of Law*

Michael Paul Hill (Apache) *San Carlos Apache Cultural Preservation Office*

Shannon Speed, *University of Texas at Austin*

PANEL 12

Moderator/Discussant

Theories of Borderlands Studies

James W. Scott, *University of Joensuu*

**FRIDAY
8:00 - 9:30 AM**

Sendero III

Understanding Borders: A Model of Border Studies to Understand Globalization

Emmanuel Brunet-Jailly, *University of Victoria*

An Examination of the Theory of Borderland Studies: A Case Study of Twin Cities along the North American Common Borders

Robert A. Rebuck, *New Mexico State University*

Local Discourses on Border in Sortavala

Aleksander Izotov, *University of Joensuu*

Can Complex System Analysis be used to Model Cultural Evolution in the Mexico - U.S. Borderlands?

Belinda Roman, *Palo Alto College*

PANEL 13

Moderator/Discussant

Transnationalism, Femicides, and the Politization of Women Victimization on the U.S. Mexican Border

Kathy Staudt, *University of Texas at El Paso*

**FRIDAY
9:45 - 11:15 AM**

Sendero II

Transnationalism and Femicide: A Reading of 'Bordertown'

Maria Socorro Tabuenca Córdoba, *University of Texas, El Paso*

The Measurement of Femicide: Politicizing Women's Victimization on the U.S. - Mexican Border

Terry Collins, *Arizona State University*

Carol Mueller, *Arizona State University*

Claiming U.S. Social Security Survivor Benefits: Mexican Women in El Paso

Gabriele Kohpahl, *University of California at Los Angeles*

Violence and Gender at the Border

Alejandrina Barajas, *University of Arizona*

PANEL 14

Moderator/Discussant

Borderland Economy, Industry and Finances

Joan Anderson, *University of San Diego*

**FRIDAY
9:45 - 11:15 AM**

Sendero III

Canadian Dollars and Mexican Pesos: Currency Substitution in the NAFTA Borderlands

Michael J. Pisani, *Central Michigan University*

David W. Yoskowitz, *Texas A&M University*

Quality Upgrading through Informal Networking Mae Sot Border Town, Thailand

Chutathip Maneepong, *Arizona State University*

Comportamiento Etnocentrista de los Consumidores Transfronterizos del Sur de Francia

Ramon Palau i Saumell, *Universitat de Girona*

Responsabilidad Social Empresarial: Corporativos y Plantas de Productos Médicos en Tijuana

María Ruth Vargas Leyva, *Instituto Tecnológico de Tijuana*

Association of Borderlands Studies
BOARD MEMBERS & OFFICERS MEETING
FRIDAY
12:00 – 1:00 PM
McGrath Bar & Grill
Hyatt Regency Hotel

PANEL 15 **Business of the Canada-United States Border**
Moderator Don Alper, *Western Washington University*
Discussant Tony Payan

FRIDAY
1:00 - 2:30 PM
Sendero II

Border Cost Impediments to NAFTA Trade, Integration, and Competitiveness
Paul Storer, *Western Washington University*

Firm Level Resilience and Regional Learning Curves: A Tale of Two Borderlands in an Age of Heightened Security
Annalise Vance, *SUNY Buffalo/BPRI*

Sustaining the Prosperity Partnership? Business, Binational Security Imperatives and the Search for Balance in Rebordering Between Canada and the United States
Victor Konrad, *Carleton University/BPRI*

Cascadia Reconsidered: Questioning Micro-Scale Cross-Border Integration in the Fraser Lowland
Patrick Buckley, *Western Washington University*
John Belec, *University of the Fraser Valley*

PANEL 16 **Border, Education and Language**
Moderator/Discussant Javier Urbina, *Instituto Tecnológico de Ciudad Juárez*

FRIDAY
1:00 - 2:30 PM
Sendero III

Dealing With the English Language Exposure in the Borderland
Javier Ventura Urbina, *Instituto Tecnológico de Ciudad Juárez*

Inglés sin Barreras: Un Análisis de la Mercadotecnia Utilizada en los Estados Unidos
Claudia Francom, *University of Arizona*

Consuming English and the Nation: Identities, Ideologies, and the Peculiar Impact of 'Inglés Sin Barreras'
Char Ullman, *University of Texas at El Paso*

Language, Landscape, and Borders
David Stea, *Center for Global Justice*

Knitting a Close-Fitting Jersey: The Role of Executive Leadership, Bureaucratic Incorporation, and Immigrant Activism in Shaping State Immigrant integration Policy
Christine Brenner, *Rutgers University*

PANEL 17

Moderator/Discussant

Border Security

Timothy J. Dunn, *Salisbury University*

**FRIDAY
2:45 - 4:15 PM**

Sendero II

Transnational Territoriality: Technologies of Discipline and Surveillance at the U.S. - Mexico Border

Magali Muria, *University of California in San Diego*

Don't Fence Us In: What Locals Have to Say about Immigration and Border Security in Brownsville, TX

Kym Neck, *CUNY Graduate Center*

Losing Individuality, Losing Identity: An Exploratory Research on Federal Border Agents

P. Ethridge, *University of Texas—Pan American*

Rosalva Resendiz, *University of Texas—Pan American*

Impunity and Political Economy: Crime, Violence, and Neoliberalism in the U.S. - Mexico Borderlands and Oaxaca

Julie A. Murphy Erfani, *Arizona State University*

PANEL 18

Moderator/Discussant

Indigenous Peoples and the U.S. - Mexico Border: Militarization, Resistance, and Rights: Resistance

Jeffrey P. Shepherd, *University of Texas at El Paso*

**FRIDAY
2:45 - 4:15 PM**

Sendero III

Panelists:

Margo Tamez, *Washington State University*

Jack Forbes, *University of California at Davis*

Jeff Wilson, *University of Texas—Brownsville*

Arnoldo García, *National Network for Immigrant Refugee Rights*

PANEL 19

Moderator/Discussant

Institutional Frameworks and Cross-Border Economics

Osiris Gaona, *Colorado State University*

**FRIDAY
4:30 – 6:00 PM**

Sendero II

Is There any Difference in Property Tax Collection by the Northern Border Influence? Evidence from Chihuahua Municipalities

Jorge Ibarra Salazar, *Instituto Tecnológico de Estudios Superiores de Monterrey*

Lida Sotres Cervantes, *Instituto Tecnológico de Estudios Superiores de Monterrey*

Local and Global Determinants of Labor Employment in the Mexican Maquiladora Industry

Jorge Eduardo Mendoza, *El Colegio de la Frontera*

Remesas y Evolución del Tipo de Cambio Real en México

Cuahtémoc Calderón Villarreal, *El Colegio de la Frontera Norte*

PANEL 20

Moderator/Discussant

Civil Society and Juridical Frameworks in European Borders

James W. Scott, *University of Joensuu*

**FRIDAY
4:30 - 6:00 PM**

Sendero III

Civil Society as an Agent in Cross-border Regionalization

James W. Scott, *University of Joensuu*

Historical Roots of Finnish Russian Para-Diplomatic Rhetoric and Practices

Ikka Liikainen, *University of Joensuu*

Civil Society Organizations as Drivers of Cross-border Interaction across the Finnish-Russian Border: On Whose Terms and for which Purpose?

Jussi Laine, *University of Joensuu*

**Derechos Fundamentales y Libertades Públicas de los Extranjeros en España:
El Fenómeno de la Inmigración en el Ordenamiento Jurídico Español**

Chantal Lucero Vargas, *Poder Judicial de la Federación*

Association for Borderlands Studies

Members' Business Meeting

James W. Scott and Tony Payan

**FRIDAY
6:00 - 7:45 PM**

Sendero III

Association for Borderlands Studies

Welcoming Reception

**FRIDAY
8:00 - 9:30 PM**

Tucanos Bar & Grill

PANEL 21

Moderator/Discussant

The Study of Borders and the Journal of Borderlands Studies

Martin van der Velde, *Radboud University Nijmegen*

**SATURDAY
8:00 – 9:30 AM**

Sendero II

Looking Back Twenty-Three Years: An Analysis of Contributors and Contributions to the Journal of Borderlands Studies, 1986 (Volume 1, Number 1) to 2008 (Volume 23, Number 2)

Michael J. Pisani, *Central Michigan University*

Juan C. Reyes, *Texas A&M International University*

Baldomero García Jr., *Texas A&M International University*

JBS Contributions on the Way to its 25th Anniversary

Emmanuel Brunet-Jailly, *University of Victoria*

Martin Van der Velde, *Radboud University Nijmegen*

Baldomero García Jr., *Texas A&M International University*

Michael Patrick, *New Mexico State University*

James Peach, *New Mexico State University*

Anthony V. Popp, *New Mexico State University*

Joan Anderson, *University of San Diego*

Paul Ganster, *San Diego State University*

PANEL 22

Moderator/Discussant

Borderland Tourism

María Ruth Vargás Leyva, *Instituto Tecnológico de Tijuana*

**SATURDAY
8:00 – 9:30 AM**

Sendero III

Determinación de Clusters de Productos Turísticos con Potencial de Desarrollo en Regiones Transfronterizas: El caso de la Frontera Catalana Francesa

Dani Blasco, *University of Girona*

Jaume Guia-Julve, *University of Girona*

Lluís Prats, *University of Girona*

Tourism Border Complexity: A Conceptual Model for Development of Mexican - U.S. Destinations by Nets

Isabel Zizaldra-Hernández, *Universitat de Girona*

Tomás J. Cuevas Contreras, *Universidad Autónoma de Ciudad Juárez*

Jaume Guia i Julve, *Universitat de Girona*

Leadership Net Examination: Mexican Chihuahua Northwest Tourism Border Region

Tomás J. Cuevas Contreras, *Universidad Autónoma de Ciudad Juárez*

Border Interactions and Tourism Growth: The Case of Baja California Sur

Alba Eritrea Gámez Vázquez, *Universidad Autónoma de Baja California Sur*

PANEL 23

Moderator/Discussant

Ideas toward a North American Environmental Research Agenda

Christopher Brown, *New Mexico State University*

**SATURDAY
9:45 – 11:15 AM**

Sendero II

Panelists:

Irasema Coronado, *University of Texas at El Paso*

Don Alper, *Western Washington University*

Heather Nicol, *Trent University*

Ed Williams, *University of Arizona*

Victor Konrad, *Carleton University*

Jorge Salas Plata, *Universidad Autónoma de Ciudad Juárez*

PANEL 24

Moderator/Discussant

Landscape Change and Culturally Relevant "Smart Growth" on the U.S. – Mexico Border

Raúl Pacheco Vega, *University of British Columbia*

**SATURDAY
9:45 – 11:15 AM**

Sendero III

Binational Synthesis of Landscape Change along the U.S. - Mexico Border

Jean W. Parcher, *U.S. Geological Survey*

Laura M. Norman, *U.S. Geological Survey*

Culturally Relevant 'Smart Growth' in the U.S. - Mexico Border

Andrea Garfinkel-Castro, *Arizona State University*

Globalization, Borders and Quality of Life on the U.S. - Mexico Border

Sergio Peña, *El Colegio de la Frontera Norte*

Pre and Post-NAFTA Trends on the U.S. - Mexico Border: A Regional Comparative Data Analysis

Victor M. Ortiz, *Northeastern Illinois University*

PANEL 25

Moderator/Discussant

Transnationalism, Dysfunctional Borders and Identity Development

Emmanuel Brunet-Jailly

**SATURDAY
1:00 - 2:30 PM**

Sendero II

Les Frontières? Des Maladies Culturellement Transmissibles

Fatima Gallaire, *Paris, France*

The News Media and the Coverage of North American Security: When Policies and Misinformation are at Play

Manuel Chávez, *Michigan State University*

Undocumented Spaces in the National Border Patrol Museum

Gabriela Moreno-Álvarez, *University of Arizona*

A Two-Way Game between Centers and Locals: Dynamic toward the Border Solutions in Eurasia

Akihiro Iwashita, *Hokkaido University*

PANEL 26

Moderator/Discussant

Water and Environmental Management across Borders

Kristen Hill Maher, *San Diego State University*

**SATURDAY
1:00 – 2:30 PM**

Sendero III

Comparing Water Conservation across Borders: Bringing Wastewater Back into U.S. and Mexican Water Policies

Raúl Pacheco Vega, *University of British Columbia*

The Transboundary Aquifer Assessment Program — Arizona: A Case Study of Binational Cooperation

Prescott Vandervoet, *University of Arizona*

Christopher A. Scott, *University of Arizona*

James Callegary, *U.S. Geological Survey*

Sharon Megdal, *University of Arizona*

Environmental Protection in the U.S. - Mexico Border Region: An Analysis of Binational Collaboration

Kileen Brooks Mitchell, *University of New Mexico*

David S. Henkel Jr., *University of New Mexico*

PANEL 27

Moderador/Discussant

La Sociedad Civil en la Coyuntura del Neoliberalismo

Irasema Coronado, *University of Texas at El Paso*

**SATURDAY
2:45 – 4:15 PM**

Sendero II

Evaluación de la Contribución de las Organizaciones de la Sociedad Civil a la Gobernabilidad en México

Carmen Álvarez González, *Universidad Nacional Autónoma de México y Universidad Autónoma de Ciudad Juárez*

Estrategias de Adaptación y Resistencia de las Organizaciones de la Sociedad Civil en el Modelo Neoliberal

Nemesio Castillo Viveros, *Universidad Autónoma de Ciudad Juárez*

Organizaciones de la Sociedad Civil y Gestión Medioambiental. El Caso de Ciudad Juárez, Chihuahua

Carmen Amelia Caballero Lozano, *Universidad Autónoma de Ciudad Juárez*

La agencia de las Mujeres en la Sociedad Civil

Elsa Patricia Hernández, *Universidad Autónoma de Ciudad Juárez*

Las Organizaciones de la Sociedad Civil en la Frontera Norte de México

Sandra Bustillos Durán, *Universidad Autónoma de Ciudad Juárez*

PANEL 28

Moderador/Discussant

Equidad y Discriminación Hacia las Mujeres

Rodolfo Rincones Delgado, *Universidad Autónoma de Ciudad Juárez*

**SATURDAY
2:45 – 4:15 PM**

Sendero III

Uso de Herramientas GIS para la Elaboración de Indicadores con Perspectiva de género

Sergio García, *Universidad Autónoma de Ciudad Juárez*

Educación no Formal y Trabajo en la Industria Maquiladora de Ciudad Juárez

Marta Miker, *El Colegio de la Frontera Norte*

Educación, Trabajo, Salud, y Justicia desde la Perspectiva de las Mujeres

Sandra Bustillos Durán, *Universidad Autónoma de Ciudad Juárez*

La Participación de las Mujeres en la Política Local

Iván Álvarez Olivas, *Universidad Autónoma de Ciudad Juárez*

Evaluación de las Políticas Públicas con Enfoque de Género en el Caso de Ciudad Juárez

Aída Reyes, *Universidad Autónoma de Ciudad Juárez*

Sandra Bustillos Durán, *Universidad Autónoma de Ciudad Juárez*

Las Mujeres en el Panorama Social Chihuahuense desde el Enfoque de Análisis Estructural

Rodolfo Rincones Delgado, *Universidad Autónoma de Ciudad Juárez*

SPECIAL EVENT

• **ALL WELCOME** •

**A Special Screening of the
2008 National Emmy Winner**

Made In LA

Jointly sponsored by

WSSA

and

Association for Borderland Studies

Pavilion VI

Saturday

4:30 – 6:00 PM

PANEL 1 Illicit Exchanges: Canada, the U.S. and Crime

THURSDAY
8:00 – 9:30 AM

Fiesta 1

Robert Wells Marshall, *Pacific Lutheran University*
Kelsey Liddle, *Pacific Lutheran University*
Julie Olds, *Pacific Lutheran University*

PANEL 2 Canadian Politics
Moderator/Discussant Timothy Casey, *Mesa State College*

THURSDAY
9:45 – 11:15 AM

Fiesta 1

Retention and Recruitment in Canada's Temporary Foreign Workers' Program
Erick Lee Erickson, *Metropolitan State College of Denver*

A Question of Confidence: The Life and Death of Government and Parliament in Canada

C.E.S. Frank, *Queens University*

A New Era in Sustaining Minority Language Rights: CEDEC'S and Anglophone Capacity Building in Quebec

Andrew F. Johnson, *Bishop's University*

PANEL 3 Canadian Literature

THURSDAY
1:00 – 2:30 PM

Fiesta 1

Singing, Crying, Chirping, Bellowing: Sounds of Race, Class and Gender in Margaret Laurence's *A Bird in the House*

Carol Beran, *St. Mary's College*

Evangeline in Acadia and Louisiana: Literature, Folklore and Fakelore

Rita Ross, *University of California at Berkeley*

As an Indian She was a Dead Loss: Piquette Tonnere in Margaret Laurence's *Manawaka Cycle*

Nora Foster Stovel, *University of Alberta*

PANEL 4 Empires Large and Small
Moderator Jim Maher, *University of New England*

THURSDAY
2:45 - 4:15 PM

Fiesta 1

**Cross - listed with
NEW ZEALAND &
AUSTRIALIA STUDIES**

Constitutional Recognition of Local Government in Australia: Third Time Lucky?

Jim Maher, *University of New England, Australia and Deputy Mayor Armidale Dumaresq Council*

Queensland, British Columbia and New Zealand React to the United States: Colonial Perspectives on the Emerging American Empire, 1869-1870

Fr. Thomas Murphy, S.J., *Seattle University*

Canadian Studies

PANEL 5 Sustaining Infrastructures of National Unity

FRIDAY
9:45 – 11:15 AM

Fiesta 1

Scientists, Environmental Policy-making and the Concept of Objectivity: A Canada-United States Perspective

Leslie Alm, *Boise State University*
Ross Burkhart, *Boise State University*

Pioneer Efforts in Long Distance Electrical Transmission and National Power Grid Planning

Lawrence Taylor, *Colegia de la Frontera Norte*

PANEL 6 Environmental and Economic Studies

FRIDAY
1:00 – 2:30 PM

Fiesta 1

Alberta Tar Sands: The World's Last Remaining Oil Field

Doreen Barrie, *University of Calgary*

The Role of Influence Channels and Sociological Infrastructures in Developing Poverty Reduction in Ontario

Carol S. Hudson, *McMaster University*

Between the Sands and a Hard Place: Aboriginal Peoples and the Tar Sands

Ian Urquhart, *University of Alberta*

PANEL 7 Current Directions in the Promotion and Institutionalization of Canadian Studies: Regional and National Initiatives in the United States

FRIDAY
2:45 - 4:15 PM

Fiesta 1

**Cross - listed with
NEW ZEALAND &
AUSTRIALIA STUDIES**

Panelists:

Christopher Kirkey, *State University of New York at Plattsburgh*
Jamie Caton, *Canadian Consulate General in Denver*
Kevin Cook, *Canadian Consulate General in Seattle*

PANEL 8 North American Borderlands: Is North So Different from South?

SATURDAY
9:45 – 11:15 AM

Fiesta 1

Panelists:

Jamie Caton, *Canadian Consulate in Denver*
Don Alper, *Western Washington University*
Kevin Cook, *Canadian Consulate in Seattle*

CHICANO STUDIES/ LAND GRANTS

Aileen F. Lucero

Metropolitan State College of Denver

Louis M. Holscher

San Jose State University

Eric Romero

New Mexico Highlands University

PANEL 1 **Roundtable: New Mexico Community Land Grants: Challenges and a New Vision for the 21st Century**

Moderator LM García y Griego, *University of New Mexico*

**THURSDAY
8:00 - 9:30 AM**

Enchantment B

The Legislative Interim Committee and Community Land Grants: A Story of Initiative and Reform

Bernadette Sánchez, *Member of the Interim Land Grant Committee*

Un Movimiento que no Muere: The Land Grant Forum and the Re-emergence of New Mexico Land Grant Issues at the Dawn of the 21st Century

Roberto Mondragón, *Anton Chico Land Grant*

Community and Economic Development Projects on Chililí Land Grant Common Lands

Juan Sánchez, *NM Land Grant Council / Consejo*

Getting Federal Government Support for Land Recovery: Challenges and Opportunities

Arturo Archuleta, *Mexicano Land and Education Conservation Trust*

PANEL 2 **Measuring Diversity: A Look at New Census Bureau Data**

Moderator Aileen F. Lucero, *Metropolitan State College of Denver*

**THURSDAY
9:45 - 11:15 AM**

Enchantment B

Panelists:

Jerry O'Donnell, *U. S. Census Bureau, Denver Regional Office*

Aileen F. Lucero, *Metropolitan State College of Denver*

PANEL 3 **Examining the Social Bond in Contemporary Institutions**

Moderator John Burke, *University of St. Thomas*

**THURSDAY
1:00 - 2:30 PM**

Enchantment B

Alone in America: A Comparison of Disrupted Families in the African American and U.S. Latino Communities

Crystal Gonzales, *University of St. Thomas*

Immigration and Social Work: What do Practitioners Need to Know?

Emilia E. Martinez-Brawley, *Arizona State University*

Paz M-B. Zorita, *Arizona State University*

Student Use of Oral History Stories for Reading and Writing Achievement

Santos Vega, *Arizona State University*

Chicano Studies/Land Grants

PANEL 4

Moderator/Discussant

Recent Scholarship on the Hispanic Land Grants of New Mexico

Felipe Gonzales, *University of New Mexico*

**THURSDAY
2:45 – 4:15 PM**

Enchantment B

Current and Future Challenges of New Mexico Land Grants: Land Recovery, Economic Development, and Land Management

LM Garcia y Griego, *University of New Mexico*

Dispossession and the New Deal: New Mexico Land Grants in the Age of Roosevelt

Jacobo Baca, *University of New Mexico*

The Hijuelas of Tierra Amarilla

David Correia, *University of Southern Maine*

Leña, Laja y Cesinas: Natural Resources and Indigenous Management Practices In New Mexico Land Grant Communities

Eric Romero, *New Mexico Highlands University*

Chicano Studies/Land Grants Section Meeting

**THURSDAY
4:30 – 5:30 PM**

Enchantment B

PANEL 5

Moderator

Roundtable: The Chicana/o Community and Current Criminal Justice Issues in New Mexico

Lou Holscher, *San Jose State University*

**FRIDAY
8:00 – 9:30 AM**

Enchantment B

Panelists:

Cynthia Bejarano, *New Mexico State University*

Dana Greene, *New Mexico State University*

Dulcinea Lara, *New Mexico State University*

Lou Holscher, *San Jose State University*

PANEL 6

Moderator

Land Grant Histories and Contemporary Organizational Practices

Eric Romero, *New Mexico Highlands University*

**FRIDAY
9:45 – 11:15 AM**

Enchantment B

The Santa Fe Ring and New Mexico Land Grants

Ruben Salaz, *Independent Scholar*

Mora Land Use History and Contemporary Practices

Gilbert Quintana, *Mora Land Grant*

Local Community Organizing in Response to the GAO Report

Paula Garcia, *Mora Land Grant*

Developing Sustainable Rural Strategies for Land Management

Juan Archuleta, *New Mexico Highlands University*

PANEL 7

Moderator

Music and Popular Culture

Lou Holscher, *San Jose State University*

**FRIDAY
1:00 - 2:30 PM
Enchantment B**

Constructions and Structures of New Mexico Corridos and Romances

Juan Archuleta, *New Mexico Highlands University*

Viva La Onda Chicana: Diverse Influences in Chicano Music

Jesus Covarrubias, *San Jose City College*

Chicano Music in New Mexico: A History of Recordings

Lou Holscher, *San Jose State University*

PANEL 8

Moderator

Land, Culture and Memory

Eric Romero, *New Mexico Highlands University*

**FRIDAY
2:45 - 4:15 PM
Enchantment B**

Immigration to the American Dream, Finding Contemporary Testimonios Similar to Méndez' Peregrinos de Aztlán

Jeanette M. Castro-Buelna, *New Mexico Highlands University*

Social Movements for Land and Water in Northern New Mexico in the 21st Century: The Paradoxes of Communal Imaginaries in the Espanola Valley

David Garcia, *University of Texas, Austin*

Familiar Contexts for Select New Mexico Folk Stories

Justin Garcia, *New Mexico Highlands University*

A Village Remembered: Story, Image and Pláticas

Stephen Salas, *New Mexico Highlands University*

PANEL 9

Moderator

Election 2008 in New Mexico

Elaine Rodriguez, *New Mexico Highlands University*

**FRIDAY
4:30 - 6:00 PM
Enchantment B**

Patterns of Racial Bloc Voting in the 2008 Presidential Election

Enegha Enyong, *New Mexico Highlands University*

The 2008 Presidential Election: Hispanics and Millennial Voters

Stephen Salas, *New Mexico Highlands University*

Democrats, Republicans, and Independents: Young Registrants and Political Party Affiliation for the 2008 Presidential Election

Stephanie Valdez, *New Mexico Highlands University*

The Campaign Trail of Ben Lujan Jr. for New Mexico 3rd Congressional District

Carmen Vidal Lieberman, *New Mexico Highlands University*

CHRONIC DISEASE AND DISABILITY

RC-49, RESEARCH COMMITTEE ON MENTAL HEALTH AND ILLNESS
OF THE INTERNATIONAL SOCIOLOGICAL ASSOCIATION

J. Gary Linn

Tennessee State University

Steven E. Brown

University of Hawaii

Debra R. Wilson

Middle Tennessee State University

PANEL 1

Exploring the Impact of Emerging Genetic and Reproductive Technologies on People with Disabilities: The Case of the UK Human Fertilization and Embryology Bill of 2007

Moderator
Discussant

Susan Foster, *Rochester Institute of Technology*
Sharon Barnartt, *Gallaudet University*

**THURSDAY
9:45 – 11:15 AM**

Fiesta 4

Panelists:

Susan Foster, *Rochester Institute of Technology*
Teresa Blankmeyer Burke, *Gallaudet University*

PANEL 2

The Implementation of Disability Policy: Positive and Adverse Outcomes

Moderator
Discussant

Gary E. May *University of Southern Indiana*
Richard Scotch, *University of Texas at Dallas*

**THURSDAY
1:00 – 2:30 PM**

Fiesta 4

Putting the Federal Functional Equivalency Directive into Everyday Practice: Interpreter Accountability

Jeremy Brunson, *Gallaudet University*

Substance Abuse Screening Among Applicants for Disability Related Employment Services: Privacy Violation or Promising Practices

Dennis Moore, *Wright State University*

The Consequences of University Health Care for People with Chronic Mental Illness

April Fehler, *University of North Texas*
Richard Scotch, *University of Texas at Dallas*

PANEL 3

Moderator
Discussant

Disability Culture and Lived Experiences

Steve Brown, *University of Hawaii*
Thomas Horejas, *Arizona State University*

**THURSDAY
2:45 – 4:15 PM**

Fiesta 4

Disability Culture: Global and Diverse

Steve Brown, *University of Hawaii*

Disabling the Myths: Ending Disability Discrimination

Gary May, *University of Southern Indiana*

Kafkaesque Social Justice through the Court System: A Focus on Disability Experience

Tommy Horejes, *Arizona State University*

PANEL 4

Moderator
Discussant

Disability Issues and Health Disparities

Debra R. Wilson, *Middle Tennessee State University*
J. Gary Linn, *Tennessee State University*

**THURSDAY
4:30 – 6:00 PM**

Fiesta 4

Exploring School Life from the Lens of a Child Who Does Not Use Speech to Communicate

Amanda Ajodhia-Andrews, *Ryerson University*
Rachel Berman, *Ryerson University*

Online Teaching for Individuals with Disabilities

Maria Revell, *Middle Tennessee State University*

The Undesirable Consequences of Misinterpreting the Roots of Chronic Diseases in Historically Marginalized Populations

Stuart Zisman, *Walden University*

PANEL 5

Moderator
Discussant

Behavioral Interventions for Managing Chronic Illness

Brenda Ralls, *Utah Department of Health*
Cynthia Kerber, *Illinois State University*

**FRIDAY
9:45 – 11:15 AM**

Fiesta 4

Involving the Family in Diabetes Management among Utah Tongan Americans

Brenda Ralls, *Utah Department of Health*
William Stinner, *Utah State University*
Fahina Pasi, *Utah State University*
Grant Sunada, *Utah State University*

Efficacy of Stress Management Classes for Adult Survivors of Childhood Sexual Abuse

Debra R. Wilson, *Walden University and Middle Tennessee State University*

From Eden to Normal: Personal Journeys and Therapeutic Interactions

Emily Schlenker, *Illinois State University*
Cynthia Kerber, *Illinois State University*

Do We Still Need Social Sciences in the Era of Biological Medicine? The Example of Psychiatry

Reinhold Kilian, *University of Ulm*

Chronic Diseases & Disability

PANEL 6

Moderator
Discussant:

Psychological Depression and Adverse Effects of Polypharmacy

Debra R. Wilson, *Middle Tennessee State University*
Jack Corbett, *Portland State University*

FRIDAY
1:00 – 2:30 PM

Fiesta 4

Migration and Depression in a Mexican Community

Elsa Cruz Martinez, *Benito Juarez Autonomous University*
Jack Corbett, *Portland State University*

Cytokines: The Link between Depression and Immune Function

Debra R. Wilson, *Middle Tennessee State University*

Desire for Children among Women with Severe Mental Disorders

Silvia Krumm, Reinhold Kilian, and Thomas Becker, *Ulm University*

Exploring the Effects of Polypharmacy on the Chronically Ill Elderly Population

Shanda Brown, *Tennessee State University*
Godspower Erhunmwunse, *Tennessee State University*
Pinky Noble-Britton, *Tennessee State University*
Kim Stewart, *Tennessee State University*
Mamie Williams, *Tennessee State University*

PANEL 7

Moderator
Discussant

International Dimensions of HIV/AIDS

J. Gary Linn, *Tennessee State University*
Kwabena Poku, *University of Ghana*

FRIDAY
2:45 – 4:15 PM

Fiesta 4

HIV/AIDS Mitigation through Improved Rural Livelihood Strategies in Mozambique

J. Gary Linn, *Tennessee State University*
Maria Quive, *International HIV/AIDS Alliance*

Mental Health Consequences of HIV Infection in Ghanaian Women and Preferred Intervention Modes

Kwabena Poku, *University of Ghana*

The Impact of HIV/AIDS on Maternal and Child Nursing Services in Botswana

J. Gary Linn, *Tennessee State University*
Thabo Fako, *University of Botswana*

CRIMINAL JUSTICE & CRIMINOLOGY

Steven Patrick

Boise State University

Eileen Luna-Firebaugh

University of Arizona

PANEL 1

Juveniles

Moderator/Discussant

Steven Patrick, *Boise State University*

**THURSDAY
9:45 - 11:15 AM**

Pavilion I

Juvenile Sexual Offenders: An Empirical Analysis and Profiles

Kathleen Bailey, *Grand Valley State University*

James David Ballard, *Grand Valley State University*

Debra Ross, *Grand Valley State University*

Natalie Seif, *Grand Valley State University*

Evaluating Collaboration and Cooperation in Juvenile Justice

Janis E. Johnston, *AAAS Science and Technology Policy Fellow with U.S. EPA/NHSRC*

N. Prabha Unnithan, *Colorado State University*

PANEL 2

Potpourri

Moderator/Discussant

Dennis W. Catlin, *Northern Arizona University-Tucson*

**THURSDAY
1:00 – 2:30 PM**

Pavilion I

The Effects of Cell Dog Programs on Prison Populations

Laura Woods Fidelie, *Midwestern State University*

Public Defense Agency Investigators: An Invisible Role in the American Criminal Justice System

Dennis W. Catlin, *Northern Arizona University-Tucson*

Education of Incarcerated Native Women in Canada and the United States: Opportunities, Challenges and Effectiveness

Mary Jo Tippeconnic Fox, *University of Arizona*

Melissa Blind, *University of Arizona*

PANEL 3

Crime and its Structural Precursors

Moderator/Discussant

Steven Patrick, *Boise State University*

**THURSDAY
2:45 - 4:15 PM**

Pavilion I

Mental Health, Child Maltreatment and Poverty in the Coachella Valley of California

Edgar W. Butler, *University of California, Riverside*

Susan Francis, *John F. Kennedy Memorial Foundation*

Anne Coleman, *John F. Kennedy Memorial Foundation*

Child Maltreatment and Child Protective Services Referrals: Current and Future Risk

Edgar W. Butler, *University of California, Riverside*

Susan Francis, *John F. Kennedy Memorial Foundation*

Anne Coleman, *John F. Kennedy Memorial Foundation*

Introducing the Idea of Sequestration

David T. McCanna, *University of California Riverside*

Criminal Justice & Criminology

PANEL 4

Moderator/Discussant

Criminal Justice Student Papers

Steven Patrick, *Boise State University*

**FRIDAY
8:00 - 9:30 AM**

Pavilion I

Repatriation, Reburial, and the Native American Graves Protection and Repatriation Act (NAGPRA): The History, The Politics, and The Opinions

Christina Weitzettle, *University of Arizona*

Healing the Native American Rape Victim: If the Physical, Mental, Emotional and Spiritual Well Being of the Woman is Intact, so too is that of the Family, Community and Society

Joan Kauppi, *University of Arizona*

Hispanic Women and Education

Vanessa Chia, *Texas Tech University*

The Perceptions of Forensic Science Based on Television Shows

Christopher Berger, *New Mexico Highlands University*

PANEL 5

Moderator/Discussant

Native American Criminal Justice

Steven Patrick, *Boise State University*

**FRIDAY
9:45 – 11:15 AM**

Pavilion I

**Cross - listed with
AMERICAN INDIAN
STUDIES**

Navajo Juveniles and Alcohol Related Arrests in Arizona: A Longitudinal Comparative Analysis

Randall R. Butler, *University of Texas at Arlington*

Michele L. Whitehead, *University of Texas at Arlington*

An Addition to Anomie Theory

David T. McCanna, *University of California Riverside*

The Effect of Official versus Self Attribution of American Indian/Alaska Native Racial Identity on Patterns of Drug Use by Recent Arrestees

Darryl Wood, *Washington State Univ. Vancouver*

Bradley Myrstol, *University of Arkansas*

PANEL 6

Moderator

Native American Criminal Justice as an Evolving Area of Study

William G. Archambeault, *Minot State University*

**FRIDAY
1:00 - 2:30 PM**

Pavilion II&III

**Cross - listed with
AMERICAN INDIAN
STUDIES**

Native American Criminal Justice: Simply a Topic of Current Academic Interest or an Area of Study Evolving into its Own Discipline

William G. Archambeault, *Minot State University*

The Importance of Native American Philosophy in Shaping the Restorative Justice Movement: A First for the First Nations

Jon'a Meyer, *Rutgers University*

Appropriate Research Methods for the Study of Native American Criminal Justice

Marianne O. Nielsen, *Northern Arizona State*

PANEL 7

Moderator/Discussant

Historical and International Criminal Justice

Eileen M. Luna-Firebaugh, *University of Arizona*

**FRIDAY
2:45 – 4:15 PM**

Pavilion I

Police Accountability in Nigeria

Eileen M. Luna-Firebaugh, *University of Arizona*

Community Issues in the Far North: at Look at Black Lake First Nation

Melissa Blind, *University of Arizona*

Quakers and Residential Schools

Barbara Heather, *Grant MacEwan College*

Marianne O. Nielsen, *Northern Arizona University*

PANEL 8

Moderator/Discussant

Crime and Punishment in Nevada: An Examination at the Factors Affecting Sentence Type and Severity in 2007

Steven Patrick, *Boise State University*

**SATURDAY
8:45 – 9:15 AM**

Pavilion I

Sex and Severity: The Impact of Gender on Offender Sentencing Across Crime Type

Janice R. Russell, *University of Nevada, Reno*

Victoria A. Springer, *University of Nevada, Reno*

Matthew C. Leone, *University of Nevada, Reno*

James T. Richardson, *University of Nevada, Reno*

Suggestions Offered and Suggestions Ignored: Factors which Explain the Decision to Sentence in Opposition to the Pre-Sentence Investigation Report

Victoria A. Springer, *University of Nevada, Reno*

Janice R. Russell, *University of Nevada, Reno*

Denise Schaar-Buis, *University of Nevada, Reno*

Matthew C. Leone, *University of Nevada, Reno*

James T. Richardson, *University of Nevada, Reno*

Past Acts and Present Consequences: An examination of Past Offender Behavior and Record on Present Sentencing Decisions

Matthew C. Leone, *University of Nevada, Reno*

Victoria A. Springer, *University of Nevada, Reno*

Janice R. Russell, *University of Nevada, Reno*

James T. Richardson, *University of Nevada, Reno*

PANEL 9

Moderator/Discussant

Prison Sentencing

Steven Patrick, *Boise State University*

**SATURDAY
1:00 – 2:30 PM**

Pavilion I

Prison Sentencing and Confinement for Child Sex Offenders

Steven Patrick, *Boise State University*

Robert Marsh, *Boise State University*

The Second Chance Act: Stemming the Recidivist Tide or Another Failed Hope

Teresa I. Francis, *Central Washington University*

Normal Homicides, Normal Defendants: Finding Leniency in Oklahoma's Murder Conviction Machinery

Larry Mays, *New Mexico State University*

David Keys, *New Mexico State University*

Julian Lapeyre, *New Mexico State University*

Community and Courtroom Influences on Sentencing Outcomes

Christine Arazan, *Northern Arizona University*

Thomas G. Blomberg, *Northern Arizona University*

William Bales, *Northern Arizona University*

PANEL 10

Moderator/Discussant

Victims of Intimate Violence: Prevention and Outcomes

Steven Patrick, *Boise State University*

**SATURDAY
2:45 – 4:15 PM**

Pavilion I

Explaining Fear of Crime as Fear of Rape among College Females: An Examination of the Context of Media Across Multiple Campuses in the United States

Rhonda R. Dobbs, *University of Texas at Arlington*

Tara O'Connor Shelley, *Colorado State University*

Courtney A. Waid, *North Dakota State University*

Evaluation of Anti-Stalking Legislation as an Appropriate Response to Bullying in Adolescence

Julie Campbell, *University of Nebraska – Kearney*

Peter Longo, *University of Nebraska – Kearney*

Probation Sentencing Convicted for Child Sex Offenders

Steven Patrick, *Boise State University*

Robert Marsh, *Boise State University*

**ECONOMICS
ASSOCIATION
FOR INSTITUTIONAL
THOUGHT (AFIT)**
Daniel Underwood
Peninsula College

PANEL 1

Moderator
Discussant

Economics When People Matter I

Daniel A. Underwood, *Peninsula College*
Geoff Schneider, *Bucknell University*

**THURSDAY
8:00 – 9:30 AM**

Pavilion IV

Achieving Human Development through Ethical Trade: The SITS Regime

George DeMartino, *University of Denver*
Jonathan Moyer, *University of Denver*
Kate Watkins, *University of Denver*

Farmer Income Support, Futures Markets and the Problem of Smallness

Sasha Breger Bush, *Colorado College*

Does Competition Advance or Retard Economic Development? – An Institutional View

Frederic B. Jennings Jr., *Center for Economic and Ethical Education*

The Political Economy of Remittances: What do we Know? What do we Need to Know?

Ilene Gabel, *University of Denver*

A Brief Guide to the 21st Century: Imperium, Crisis, and Redemption – Notes on a Banal New World

Rajani Kanth, *Harvard University*

PANEL 2

Moderator
Discussant

Welfare and Freedom

Anne Mayhew, *University of Tennessee*
Michael K. Green, *State University of New York at Oneonta*

**THURSDAY
9:45 - 11:15 AM**

Pavilion IV

Capitalism and Freedom: What is Their Relationship?

Robert E. Prasch, *Middlebury College*

Some Thoughts on an Institutional Economics Approach to the Interaction between Welfare States and Labor Markets

Cristina Matos, *Universidade do Minho*

The Middle Class in the World Economy: An Update and Analysis of their Condition in the Early 2000's

Steven Pressman, *Monmouth University*

Simon Patten and the Institutional Notion of Abundance

Robert LaJeunesse, *University of Newcastle*

PANEL 3

Moderator
Discussants

Chris Brown, *Inequality, Consumer Credit and the Saving Puzzle*

Jim Peach, *New Mexico State University*
Christopher Brown, *Arkansas State University*

THURSDAY
9:45 - 11:15 AM

Pavilion V

Panelist:

John Watkins, *Westminster College*
Richard Adkisson, *New Mexico State University*
Reynold Nesiba, *Augustana College*
Glen Atkinson, *University of Nevada – Reno*

Association For Institutional Thought

Business Meeting

THURSDAY
11:45 AM – 1:00 PM

Pavilion V

PANEL 4

Moderator
Discussant

Innovative Approaches for Economic Education

Geoff Schneider, *Bucknell University*
Eric Hake, *Eastern Washington University*

THURSDAY
1:00 - 2:30 PM

Pavilion IV

Research Projects on the Music Industry by Undergraduate Economics Majors

Ronnie Phillips, *Colorado State University*

Principles of Macroeconomics, Reading #9: An Overview of Orthodox Theory

Kevin Furey, *Chemeketa Community College*

Introducing Political Economy Principles to Introductory Students: A Critical Review of the Best Selling Text by "Hunt & Sherman" (7th Ed)

Phillip Anthony O'Hara, *Curtin University*

The Inheritance of Heterodox Economic Thought

Mary Wrenn, *Weber State University*

Teaching the Social Fabric Matrix with a Semester Research Project

F. Gregory Hayden, *University of Nebraska – Lincoln*

PANEL 5 **Heterodox Approaches to Welfare**
Moderator/Discussant Frederic S. Lee, *University of Missouri – Kansas City*

THURSDAY
1:00 - 2:30 PM

Pavilion V

Welfare in Historic Context: An Aspect of the Double Movement, or...?
John F. Henry, *University of Missouri – Kansas City*

Poverty and the Market System: Institutional and Neoclassical Economics
William T. Ganley, *Buffalo State College*

A Post Keynesian Microeconomic Approach to Welfare
Tae-Hee Jo, *Buffalo State College*

Competition and Welfare in Post Keynesian Economics
Tuna Baskoy, *Ryerson University*

PANEL 6 **Environmental and Natural Resource Economics**
Moderator Steven Pressman, *Monmouth University*
Discussant F. Gregory Hayden

THURSDAY
2:45 - 4:15 PM

Pavilion IV

Global Political Economy of Global Warming, Species Extinction and Human Development
Phillip Anthony O'Hara, *Curtin University*

Marx's Contradiction of Capitalism and Peak Oil
Janine Fitzgerald, *Fort Lewis College*

Energy Security for Whom?
Lynne Chester, *Curtin University*

Implementing the Utopian Consumer: Deregulating Electricity in Sweden
Mats Bladh, *Linköping University*

PANEL 7 **Economic Insights From Institutional Analysis I**
Moderator Mary Wrenn, *Weber State University*
Discussant Phillip Anthony O'Hara, *Curtin University*

THURSDAY
2:45 - 4:15 PM

Pavilion V

The Ethical and Economic Implications of Advertising to Children
Valerie Kepner, *King's College*

The Consumption of Cultural Goods: An Institutional Approach
José Felipe A. de Almeida, *University of Paraná*

Property Rights and Pirates: From the High Seas to DVDs
Philip Kozel, *Rollins College*

Veblen, Myrdal and Dewey and the War on Drugs
James L. Webb, *University of Missouri – Kansas City*

Why Not Tear Down the Wall Now? How Mass Incarceration Increases Crime
Geert Dhondt, *University of Massachusetts – Amherst*

PANEL 8

The 30th Anniversary of the Association For Institutional Thought: Reflections From Some Evolutionary Revolutionaries

Moderator

Daniel A. Underwood, *Peninsula College*

**THURSDAY
4:30 - 6:00 PM**

Pavilion V

Panelist:

William M. Dugger, *University of Tulsa*
F. Gregory Hayden, *University of Nebraska – Lincoln*
Edythe Miller, *Littleton, Colorado*
Ronnie Phillips, *Colorado State University – Fort Collins*
James Sturgeon, *University of Missouri – Kansas City*
William Waller, *Hobart and William Smith Colleges*

Association For Institutional Thought

30th Anniversary Banquet

Sadie's Cocinita

**THURSDAY
7:00 – 9:30 PM**

(transportation will be provided)

PANEL 9

Economics When People Matter II

Moderator
Discussant

Daniel A. Underwood, *Peninsula College*
Dan Axelsen, *PricewaterhouseCoopers, LLP*

**FRIDAY
8:00 – 9:30 AM**

Pavilion IV

Why Pragmatism and Microevolution Matter When People Matter: The Cases of Standard Oil and Wal-Mart

Anne Mayhew, *University of Tennessee*

A Simple Institutional Analysis of the North Dakota Pharmacy Ownership Law

Dan Friesner, *North Dakota State University*

Successful Community Development: Care as a Necessity to an Inclusive and Sustainable Local Economy

Paula M. Cole, *Hobart and William Smith Colleges*

PANEL 10

AFIT Student Paper Competition

Moderator
Discussant

Christopher Niggle, *University of Redlands*
Daniel A. Underwood, *Peninsula College*

**FRIDAY
9:45 – 11:15 AM**

Pavilion IV

A Comparative Perspective: Imperialism and the Forgotten Insight of Thorstein Veblen

Ian Matthew Green, *Portland State University*

Veblen's Cumulative Change and the Origins of Money in Mesopotamia

Alla Semenova, *University of Missouri – Kansas City*

PANEL 11
Facilitator

Workshop: Collaborative Learning Techniques for Heterodox Economics
Geoff Schneider, *Bucknell University*

FRIDAY
1:00 – 2:30 PM

Pavilion IV

Participants:

Barbara Wiens-Tuers, *Penn State Altoona*
Janet T. Knoedler, *Bucknell University*

PANEL 12
Moderator
Discussant

Post-Keynesian Institutionalism: Antecedents, Analyses and Assessments
Christopher J. Niggle, *University of Redlands*
Clifford S. Poirot Jr., *Shawnee State University*

FRIDAY
1:00 – 2:30 PM

Pavilion V

Veblen's *Absentee Ownership* and Financial Crisis

Zdravka Todorova, *Wright State University*

Post-Keynesian-Institutionalist Analysis of Financial Instability

Fadhel Kaboub, *Denison University*

The Post Keynesian/The Institutionalists: A Synthesis of Selected Views and Analysis

W. Robert Brazelton, *University of Missouri – Kansas City*

Post-Keynesian Institutionalism: Alive and Well at Twenty-five

Charles J. Whalen, *Utica College*

PANEL 13
Moderator
Discussant:

Institutional Analysis of the Current Economic Crises
Christopher J. Niggle, *University of Redlands*
Charles J. Whalen, *Utica College*

FRIDAY
2:45 – 4:15 PM

Pavilion IV

Accounting for Capital in a WAMU World

Eric R. Hake, *Eastern Washington University*

The Global Subprime Financial Crisis: Institutional Problems and Solutions

Phillip Anthony O'Hara, *Curtin University*

Housing Matters An Analysis of the Mortgage Foreclosure Crisis and Proposals for Reform

Reynold Nesiba, *Augustana College*

Financial Crisis and Institutional Economics

Andres F. Cantillo, *University of Missouri – Kansas City*

Origins of the Current Economic Crisis

Howard Sherman, *University of California – Los Angeles*

PANEL 14

Moderator
Discussant

Institutions and Labor Markets

Phillip Klein, *Pennsylvania State University*
Barbara E. Hopkins, *Wright State University*

**FRIDAY
2:45 – 4:15 PM**

Pavilion V

Balance of Power: Flexibility and Control of Time and Process at Work

Barbara Wiens-Tuers, *Penn State Altoona*

Spatial Econometric Analysis of County Unemployment Rates in the Continental United States, 2000 - 2007

Richard Dadzie and Xuan Pham, *University of Missouri – Kansas City*

Demographic Transition and Female Labor Force Participation Behavior

Misbah Tanveer Choudhry, *University of Groningen*

Give a Man a Fish While Teaching Him to Fish: Public Policies Towards Poverty Reduction with Rationally Bounded Beneficiaries

Huáscar Fialho Pessali, *Universidade Federal do Paraná*

PANEL 15

Moderator

Friends and Critics of Abundance: Views and Reviews of Economic Abundance: An Introduction by William Dugger and James Peach

Glen W. Atkinson, *University of Nevada – Reno*

**FRIDAY
4:30 – 6:00 PM**

Pavilion IV

Panelists:

William M. Dugger, *University of Tulsa*
James Peach, *New Mexico State University*
Clifford S. Poirot, Jr., *Shawnee State University*
Robert Prasch, *Middlebury College*
John F. Henry, *University of Missouri – Kansas City*

PANEL 16

Moderator
Discussant

Crises as an Institution

John Watkins, *Westminster College*
Reynold Nesiba, *Augustana College*

**FRIDAY
4:30 – 6:00 PM**

Pavilion V

Increasing Inequality, Status Insecurity, Ideology, and the Financial Crises of 1929 and 2008

Jon D. Wisman, *American University*

The Political Economy of Risk and Our Current Crisis

Michael K. Green, *State University of New York at Oneonta*

Central Banking under the Era of Financialization

Hasan Comert, *University of Massachusetts – Amherst*

Housing Finance Systems: Which System Serves Its Goals Best?

Elisabeth Springler, *University of New Orleans*

Economists as Enabling Myth Makers: Thoughts on Economic Crises

Richard Adkisson, *New Mexico State University*

PANEL 17

Moderator
Discussant

Economics When People Matter III

Daniel A. Underwood, *Peninsula College*
F. Gregory Hayden, *University of Nebraska – Lincoln*

**SATURDAY
8:00 – 9:30 AM**

Pavilion IV

Justice and the Just Economy

Charles Clark, *St. Johns University*

Feminist Evaluation of the American Economic System: Reviving the Feminine

Barbara E. Hopkins, *Wright State University*

The 'Strict Parent' State in Economic Recession: Did Conservative Religious Values Undermine the Economic Interest and will Liberal Religious Values Help Restore it?

Dell P. Champlin, *Eastern Illinois University (retired)*

Janet T. Knoedler, *Bucknell University*

Welfare to Work When People Matter

Daniel A. Underwood, *Peninsula College*

Dan Axelsen, *PricewaterhouseCoopers LLP*

Dan Friesner, *North Dakota State University*

PANEL 18

Moderator
Discussant:

Economic Insights from Institutional Analysis II

Phillip Anthony O'Hara, *Curtin University*

John Watkins, *Westminster College*

**SATURDAY
9:45 – 11:15 AM**

Pavilion IV

Consumerism and the U.S. Trade Deficit

Christopher Brown, *Arkansas State University*

Industrialization in Caricom

Winston H. Griffith, *Bucknell University*

'The Hicksian Getaway' and 'The Hirshleifer Rescue': Increasing Returns from Clapham to Kaldor

Frederic B. Jennings Jr., *Center for Ecological Economic and Ethical Education*

A Minskian Approach to Financial Crises with a Behavioural Twist

Mathieu Dufour, *Dalhousie University*

The Question of the Falling Rate of Profit and the Rise in Long-term Profitability in the U.S. in the 1980's and 1990's

Erdogan Bakir, *Bucknell University*

Al Campbell, *University of Utah*

PANEL 19

Moderator/Discussant

Heterodox Approaches in the Mainstream

Charles J. Whalen, *Utica College*

**SATURDAY
9:45 – 11:15 AM**

Pavilion V

The Three Worlds of Evolutionary Economics

Clifford S. Poirot Jr., *Shawnee State University*

John Davis and the Recent Turn in Economics

John F. Henry, *University of Missouri – Kansas City*

Frederic S. Lee, *University of Missouri – Kansas City*

Rules and Institutions as Opportunity Costs Patterns: Culture Blindness and the Failure to Define Rules and Institutions

Paul Fudulu, *University of Bucharest*

Mainstream Amnesia: Why Evolutionary Ideas in the Mainstream Are Not Being Recognized for What They Are and How Institutional Economics Can Benefit?

Timothy A. Wunder, *University of Texas at Arlington*

ECONOMICS BUSINESS & FINANCE

Kashi Nath Tiwari

KNT's Academic Financial Research

PANEL 1

Moderators
Discussants

Forecasting and Uncertainty

Deniz Kebabci, *San Francisco State University*
Deniz Kebabci, *San Francisco State University*
Irina Khindanova, *University of Denver*
Thomas Pencek, *University of South Florida, Sarasota*

**SATURDAY
8:00 – 9:30 AM**

Enchantment E

Integrating Financial Statement Modeling and Sales Forecasting

John Cuddington, *Colorado School of Mines*
Irina Khindanova, *University of Denver*

Uncertainty and Allocation

Deniz Kebabci, *San Francisco State University*

Costing in Managerial (Cost) Accounting: A Case Study

Annhenrie Campbell, *California State University, Stanislaus*
David H. Lindsay, *California State University, Stanislaus*
Kim B. Tan, *California State University, Stanislaus*
Freddie Choo, *San Francisco State University*

PANEL 2

Moderator

Accounting, Costs, and Benefits

David H. Lindsay, *California State University, Stanislaus*
Annhenrie Campbell, *California State University, Stanislaus*
Discussants
Thomas Pencek, *University of South Florida, Sarasota*
Kashi Nath Tiwari, *KNT's Academic Financial Research*
David H. Lindsay, *California State University, Stanislaus*

**SATURDAY
9:45 – 11:15 AM**

Enchantment E

A Simplified Approach to Teaching Process Costing Costs and Benefits of AACSB accreditation

David H. Lindsay, *California State University, Stanislaus*

The Sensitivity of State Tax Revenues

Tzu-Man Huang, *California State University, Stanislaus*

An Examination of Kiplinger's Best Mutual Funds

William Zaremba, *University of South Florida, Sarasota*
Thomas Pencek, *University of South Florida, Sarasota*

PANEL 2

Moderator
Discussants

Valuation and Choice

Kashi Nath Tiwari, *KNT's Academic Financial Research*
Kashi Nath Tiwari, *KNT's Academic Financial Research*
Balasundram Maniam, *Sam Houston State University*
Thomas Pencek, *University of South Florida, Sarasota*

**SATURDAY
1:00 – 2:30 PM**

Enchantment E

Data Analysis

Deniz Kebabci, *San Francisco State University*

Large Businesses versus Small Businesses

Hadley Leavell, *Sam Houston State University*

Intertemporal Tradeoffs for Corporations

Kashi Nath Tiwari, *KNT's Academic Financial Research*

Value of Tax-deductibility

Kashi Nath Tiwari, *KNT's Academic Financial Research*

PANEL 1

Moderator
Discussants

Agricultural Economics

Randy Kesselring, *Arkansas State University*
Jennifer Thatcher, *University of New Mexico*
David Hoass, *Centenary College*
Gregory Torell, *New Mexico State University*

**THURSDAY
1:00 – 2:30 PM**

Enchantment E

The Tragedy of the Commons Dilemma and Consumptive Water Use within the NRCS Environmental Quality Incentives Program

Gregory Torell, *New Mexico State University*

The Decision to Manage Invasive Weeds: Which Factors Matter?

Jennifer Thatcher, *University of New Mexico*
K. Grimsrud, *University of New Mexico*
J. Chermak, *University of New Mexico*
K. Krause, *University of New Mexico*

How Fruitful is the Irrational Consumer Assumption in Wine Evaluation?

David Hoass, *Centenary College*
John McAdams, *Republic National Distributing Company*

PANEL 2

Moderator
Discussants

Applied Microeconomics, Public Policy, and Regulation

Dale Bremmer, *Rose-Hulman Institute of Technology*
Randy Kesselring, *Arkansas State University*
Timothy Matthews, *Kennesaw State University*
Harold Christianson, *Centenary College*
Marion Jones, *University of Regina*

**THURSDAY
2:45 – 4:15 PM**

Enchantment E

More Than Just a Job: Solutions for the Employed Homeless in Calgary

Marion Jones, *University of Regina*

Gasoline and Crude Oil: Evidence of Asymmetric Prices Changes during 2008?

Randy Kesselring, *Arkansas State University*
Dale Bremmer, *Rose-Hulman Institute of Technology*

The Impact of Organizer Market Structure on Participant Entry Behavior in a Multi-Tournament Environment

Timothy Matthews, *Kennesaw State University*
Soiliou Daw Namoro, *Kennesaw State University*

The Impact of Energy Costs upon Railroad Performance

Harold Christianson, *Centenary College*
Elizabeth Rankin, *Centenary College*

PANEL 3

Moderator

Discussants

International Economics and Public Policy

Sue Stockly, *Eastern New Mexico State University*

Marion Jones, *University of Regina*

Richard Adkisson, *New Mexico State University*

Craig McPhee, *University of Nebraska, Lincoln*

Yu-Feng Lee, *New Mexico State University*

**THURSDAY
4:30 – 6:00 PM**

Enchantment E

The Influence of exports on State Level Economic Development

Richard Adkisson, *New Mexico State University*

Eduardo Suacedo, *New Mexico State University*

Did the MFA Really Restrict US Textile and Apparel Imports?

Craig McPhee, *University of Nebraska, Lincoln*

Janel Scott, *Union College*

ASEAN Plus Three and Intra-Regionalism: Is It True That “More Is Better”?

Yu-Feng Lee, *New Mexico State University*

Trilingualism and the Nazi: Clashing Education Policies and Socioeconomic Well-being of China’s Minority Peoples

Marion Jones, *University of Regina*

Dongyan Blanchford, *University of Regina*

PANEL 4

Moderator

Discussants

Education and Innovation: An International Perspective

Leila Pratt, *University of Tennessee at Chattanooga*

Robert Herren, *North Dakota State University*

David Hoass, *Centenary College*

Scott Carson, *University of Texas, Permian Basin*

**FRIDAY
8:00 - 9:30 AM**

Enchantment E

Labor Markets in Macroeconomic Analysis before Milton Friedman’s Natural Rate Theory

Robert Herren, *North Dakota State University*

Sexism or Professional Elitism? The Historical Influence on the Discipline of Home Economics in British Columbia

James Ponzetti, *University of British Columbia*

Sustainable Development of the Science and Technology Parks in Taiwan

Jou-juo Chu, *National Chung Cheng University, Taiwan*

**Economics
General**

PANEL 5

Moderator
Discussants

Economic Education

Robert Herren, *North Dakota State University*
Carston Lang, *California State University, Polytechnic*
Sue Stockley, *Eastern New Mexico State University*
Leila Pratt, *University of Tennessee at Chattanooga*

**FRIDAY
9:45 – 11:15 AM
Enchantment E**

Differences in Male and Female Publication Rates

Leila Pratt, *University of Tennessee at Chattanooga*

Progress in Diversity: A Study of Minority Scholar Attainment in Post-Secondary Education

Sue Stockley, *Eastern New Mexico State University*

Predicting Student Learning Success in a Principles of Economics Online Course using Linear Regression and Neural Networks

Carston Lang, *California State University, Polytechnic*

Student "Skimming" Across Public Schools in the Denver Metropolitan Region: Empirical Evidence Using an Agent-based Approach

Rhonda R. Corman, *University of Northern Colorado*
Laura S. Connolly, *University of Northern Colorado*
David Aske, *University of Northern Colorado*

PANEL 6

Moderator
Discussants

Topics in International Economics

Christine Sauer, *University of New Mexico*
T. Scott Findley, *University of New Mexico*
Matias Fontenla, *University of New Mexico*
Carsten Lange, *CSU Pomona*
Don Coes, *University of New Mexico*

**FRIDAY
1:00 – 2:30 PM
Enchantment F**

The Impact of Environmental Regulation on Foreign Direct Investment

Steven Archambault, *University of New Mexico, Ph.D Candidate*

Emigrant Remittances and the Real Exchange Rate

James Price, *University of New Mexico, Ph.D Candidate*

Testing the Purchasing Power Parity Hypothesis in an Online Virtual Economy

Micheal Morrison, *University of New Mexico, Ph.D Candidate*

Distance and Price Effects of Currency Unions

Justin T.H. Smith, *University of New Mexico, Ph.D Candidate*

PANEL 7

Moderator
Discussants

Sports and Labor Economics

Kristina Lybecker, *Colorado College*
King Banian, *Saint Cloud State University*
Scott Fuess, *University of Nebraska, Lincoln*
Harold Christianson, *Centenary College*

**FRIDAY
1:00 – 2:30 PM
Enchantment E**

The Predictive Ability of the List of the Top 100 Blue Chip High School Football Players: A Preliminary Examination of Their Impact on College Football

John Hafner, *Centenary College*
Harold Christianson, *Centenary College*
Elizabeth Rankin, *Centenary College*

Sportswriters and Customer Discrimination in Major League Baseball: Evidence from Voting for the Hall of Fall: Revisited

King Banian, *Saint Cloud State University*
William Luksetick, *Saint Cloud State University*

Recreation in Japan: Where is Life Leisurely?

Scott Fuess, *University of Nebraska, Lincoln*

PANEL 8

Moderator
Discussants

Health Economics and Public Policy

Scott Fuess, *University of Nebraska, Lincoln*
Kristina Lybecker, *Colorado College*
Scott Carson, *University of Texas, Permian Basin*
Leila Pratt, *University of Tennessee, Chattanooga*

FRIDAY
2:45 – 4:15 PM
Enchantment E

The Distribution of Working Time in Germany: Who is Time Privileged?

Scott Fuess, *University of Nebraska, Lincoln*

Urbanization, Migration, Refugees

Tatul Mananseryan, *Research Center ALTERNATIVE in Yerevan*
Hakob, Sekepyan, *Research Center ALTERNATIVE in Yerevan*

Nineteenth Century Wealth and Physical Environmental Sources Associated with Tuberculosis

Scott Carson, *University of Texas, Permian Basin*

PANEL 9

Moderator
Discussants

Inflation Targeting

Craig McPhee, *University of Nebraska, Lincoln*
Ozden Birkin, *Yasar University*
Unro Lee, *University of the Pacific*

FRIDAY
4:30 – 6:00 PM
Enchantment F

Forecasting Inflation for Inflation-Targeted Countries: A Comparison of Predictive Performances of Alternative Inflation Models

Unro Lee, *University of the Pacific*

Growth and Distribution Under Inflation Targeting

Ozden Birken, *Yasar University*

PANEL 10

Moderator
Discussants

Health and Labor Economics

Leila Pratt, *University of Tennessee - Chattanooga*
Kristina Lybecker, *Colorado College*
Scott Carson, *University of Texas, Permian Basin*
Kay Unger, *University of Montana*

FRIDAY
4:30 – 6:00 PM
Enchantment E

Tobacco Taxes and Spillovers into Other Risky Behaviors

Kay Unger, *University of Montana*

Exploring the Decision to Patent: Socioeconomic Indicators and the Prevalence of Patents in Developing Nations

Kristina Lybecker, *Colorado College*
Alex Brody, *Colorado College*

The Wailer Surface Reconsidered in the Late 19th and Early 20th Century Tennessee Prison

Scott Carson, *University of Texas, Permian Basin*

ENVIRONMENTAL POLICIES & NATURAL RESOURCES

Dwight C. Kiel

University of Central Florida

PANEL 1

Rivers and Water

Moderator

Steven Parker, *University of Nevada, Las Vegas*

THURSDAY
2:45 – 4:15 PM

Sage

Allocating Water Under Conditions of Risk: The Colorado River

Steven Parker, *University of Nevada, Las Vegas*

Jeffrey Tilton, *University of Nevada, Las Vegas*

Miracle of the Commons: Improved Salmon Runs on the Columbia-Snake in 2008

Bradley T. Clark, *Fort Lewis College*

Incorporating Science in Natural Resource Management

Nina Burkardt, *U.S. Geological Survey*

Emily Ruell, *Colorado State University*

Douglas Clark, *U.S. Bureau of Reclamation*

PANEL 2

Biodiversity

Moderator

Dwight C. Kiel, *University of Central Florida*

THURSDAY
4:30 – 6:00 PM

Sage

Biodiversity Risk in the U.S.

Justin Tevie, *University of New Mexico*

Kristine Grimsrud, *University of New Mexico*

Buying Back the Everglades Ecosystem: Florida's Acquisition of U.S. Sugar

Dwight C. Kiel, *University of Central Florida*

PANEL 3

Environmental Assessment

Moderator

William R. Mangun, *East Carolina University*

FRIDAY
8:00 - 9:30 AM

Pavilion V

An Assessment of Environmental Program Implementation in Oregon

Lauren Jordan, *East Carolina University*

William R. Mangun, *East Carolina University*

A Contemporary Analysis of the National Environmental Policy Act

Heather M. Farley, *Northern Arizona University*

GHG Emission and Global Warming: A Cointegration Test

Xiaobing Zhao, *Northern Arizona University*

Barriers and Motivators for the Adoption of Public Sector Environmental Management Systems

Jing Wang, *Arizona State University*

Elizabeth A. Corley, *Arizona State University*

Eric Welch, *Arizona State University*

Panel 4
Moderator

Agriculture and the Environment
Sharon Ridgeway, *University of Louisiana at Lafayette*

FRIDAY
2:45 – 4:15 PM

Pavilion VI

A Game Theoretic Model of Rancher Responses to Diffusing Weed Infestations
Kristine Grimsrud, *University of New Mexico*

Brettonwoods Institutions Destruction of Sustainable Agriculture
Sharon Ridgeway, *University of Louisiana at Lafayette*

Targeting Agriculture: Air Quality Policy in California's San Joaquin Valley
Kurt Cline, *California State University, Fresno*

PANEL 5
Moderator

Place and Value (Location, Location, Location)
Irina Khindanova, *University of Denver*

FRIDAY
4:30 – 6:00 PM

Pavilion VI

The Pro-Growth Orientation of the Sustainable Development Movement
Location Factors for Exploration Investments
Irina Khindanova, *University of Denver*

The Economic Value of Protecting Inventoried Roadless Areas: A Spatial Hedonic Price Study in New Mexico
German M. Izon, *University of New Mexico*

Insect Infestation and Residential Property Values: A Hedonic Analysis of the Mountain Pine Beetle Epidemic in Grand County Colorado
James Price, *University of New Mexico*

PANEL 6
Moderator

The Environment and Disasters
Pamela Duncan, *Colorado State University*

SATURDAY
8:00 – 9:30 AM

Pavilion VI

The Issue of Problem Formulation in Policy-Making: A Sandstorm-Combating Policy Case in North China
Lihau Yang, *Arizona State University*
Zhiyong Lan, *Arizona State University*

Creating a Discourse Coalition: Policy Decision-Making from Hurricane Rita to Hurricane Ike
David E. Birch, *Lone Star College*

Marijuana Cultivation in National Forests and Parks, Environmental Impacts and Policy Failure: Disaster by Management
Eugenie Rovai, *California State University, Chico*
Christine M. Rodrigue, *California State University, Long Beach*

Environmental Policies & Natural Resources

PANEL 7

Moderator

Environmental Transformations

Peter J. Jacques, *University of Central Florida*

SATURDAY
9:45 – 11:15 AM

Pavilion VI

Desolation and Pedagogy

Peter J. Jacques, *University of Central Florida*

Environmental Policy in Less Developed Countries: What's Pluralism Got To Do With It?

Kristi Ross, *Northern Arizona University*

Climate Activism: An Indicator of U.S. Transformation into a Risk Society?

Katrina Taylor, *Northern Arizona University*

The Role of Civic Science in the Walker River Basin, Nevada

Leah Wilds, *University of Nevada, Reno*

Robert Dickens, *University of Nevada, Reno*

PANEL 8

Moderator

Energy Issues

Lilias Jones Jarding, *South Dakota State University*

SATURDAY
1:00 – 2:30 PM

Pavilion VI

The New Nuclear Era in the United States: Regulators' Responses to the Uranium Boom

Lilias Jones Jarding, *South Dakota State University*

Are We Addicted to Oil? Really...

Melinda Harm Benson, *University of New Mexico*

Regulation Across Organizational Networks: Oil and Gas Operations in the Inter-Mountain West

Rick S. Kurtz, *Central Michigan University*

PANEL 1

Moderator
Discussants

War and Gridiron

Thomas M. Camfield, *Sam Houston State University*
B.R. Burg, *Arizona State University*
Richard Yasko, *University of Wisconsin-Whitewater*

FRIDAY
1:00 – 2:30 PM

Enchantment D

World War II's Greatest Warriors

Clifford Egan, *University of Houston*

'A Fist That Was Very Much Intentional': Postwar Football in the Midwest and the 1951 Johnny Bright Scandal

Lane T. Demas, *Central Michigan University*

The Unseen War: President Woodrow Wilson and the Call for Allied Intervention into Russia, 1918

Philip Norfleet, *University of Central Oklahoma*

PANEL 2

Moderator /Discussant

Historical Scholarship in the Digital Age

Richard A. Voeltz, *Cameron University*

FRIDAY
2:45 – 4:15 PM

Enchantment D

Historical Scholarship in the Digital Age: Asking New Questions and Exploring New Forms of Scholarly Communication with Digital Techniques

Brent M. Rogers, *University of Nebraska-Lincoln*
Jason A. Heppler, *University of Nebraska-Lincoln*
Nicholas D. Swiercek, *University of Nebraska-Lincoln*
Michelle Tiedje, *University of Nebraska-Lincoln*
Robert J. Voss, *University of Nebraska-Lincoln*

PANEL 3

Moderator /Discussant

Women across the Centuries

Brad Whitsel, *The Pennsylvania State University at Fayette*

FRIDAY
4:30 – 6:30 PM

Enchantment D

Women Writing in the 17th century: Jane Leade, Claiming Spiritual Authority in the End Times

Jane Crawford, *Mt. St. Mary's College*

Playing 'Cat and Mouse' with the Women's Social and Political Union, April 1913-July 1914

Angela A. Dormiani, *Edmond Public Schools*

Moonshine, Policewomen, and Shimmy Queens: How the Federated Church Women of Milwaukee County 'Saved' the City

Monica S. Gallamore, *Marquette University*

History

PANEL 4

Moderator
Discussant

Views of Religion

T.H. Baughman, *University of Central Oklahoma*
Jane Crawford, *Mt. St. Mary's College*

**SATURDAY
8:00 – 9:30 AM**

Enchantment D

Rewriting History: Mormonism and Conservative Politics in the Early Cold War, 1945-1954

Tam Hoskisson, *Northern Arizona University*

Ritual and Race in the Antebellum Southern Church

Kevin D. Butler, *University of Arkansas at Pine Bluff*

Marie Ogden and the Home of Truth: Prophecy and Disaster in a Depression-Era Western Religious Commune

Brad Whitsel, *The Pennsylvania State University at Fayette*

PANEL 5

Moderator /Discussant

City and Country

Gretchen A. Adams, *Texas Tech University*

**SATURDAY
9:45 – 11:15 AM**

Enchantment D

Building off the Great Tohomoho: An Urban-Environmental History of Waco, Texas, and the Middle Brazos River

Kenna Archer, *Texas Tech University*

Hazards, Risks & Disaster Recovery: Hurricanes, Crude Oil and Risk in Galveston, Texas, 1900 - 1902

James B. McSwain, *Tuskegee University*

The Question is 'Will it Pay?': Economic Management Strategies and Resiliency of the Kohrs and Bielenberg Ranch

Brandon Chapman, *Washington State University*

PANEL 6

Moderator /Discussant

Foreign Affairs

T.H. Baughman, *University of Central Oklahoma*

**SATURDAY
1:00 - 2:30 PM**

Enchantment D

From ECSC to European Union: A Historical-Institutional Analysis of Policymaking

Constantine Hadjilambrinos, *University of New Mexico*

Pasaron para no volver: Elite Attitudes, Popular Culture, and Race, Class, and Gender Roles in Nineteenth-Century Maracaibo, Venezuela, 1830-1900

Peter S. Linder, *New Mexico Highlands University*

Social-historical Transformations in Northern Africa's Political Economies: Interpreting the Emergence of Two World Systems

Ray A. Kea, *University of California at Riverside*

PANEL 7

The American Revolution in Antebellum Imagination

Moderator /Discussant D. Kurt Graham, *Cody Institute of Western American Studies*

**SATURDAY
2:45 – 4:15 PM**

Enchantment D

The Memory of the American Revolution in the Politics of the Sectional Crisis

Jonathan B. Crider, *Texas Tech University*

The Revolution in Anti-Slavery Rhetoric

Patricia Roeser, *Arizona State University*

Benedict Arnold, Jefferson Davis and the Politics of Treason

Gretchen A. Adams, *Texas Tech University*

PANEL 8

Historians and Historiography

Moderator Ray A. Kea, *University of California at Riverside*
Discussant Ray A. Kea, *University of California at Riverside*

**SATURDAY
4:300 – 6:00 AM**

Enchantment D

Where Rivers Flow, Cities Grow: Why Environmental Historians have more to Contribute to Urban Histories

Kenna Archer, *Texas Tech University*

Historiographical Reassessment of Robert Falcon Scott

T.H. Baughman, *University of Central Oklahoma*

Teaching American History Through Film: Hollywood Blockbuster, PBS, History Channel, or the Postmodern

Richard A. Voeltz, *Cameron University*

HUMAN COMMUNICATION

Brant Short

Northern Arizona University

Dayle Hardy-Short

Northern Arizona University

PANEL 1

Moderator

Campaign Communication in 2008: Case Studies I

Brant Short, *Northern Arizona University*

**FRIDAY
8:00 – 9:30 AM**

Sage

Bristol Palin and Jaime Lynn Spears, Celebrity or Private Figure: The Intimacy Created by *ShowBiz Tonight*

Emilly Borthwick, *Northern Arizona University*

Becoming President is More Than Announcing You're Going to Run: An Epideictic Analysis of Barack Obama and John McCain's Presidential Acceptance Speeches

Angelica Hernandez, *Northern Arizona University*

The Hate on 8 or 'And Justice for All': An Ideographic Analysis of California's Proposition 8 Campaign

Ric Brunner, *Northern Arizona University*

Barack Obama's Use of Environmental Appeals in the 2008 Presidential Campaign

Enrique Ramirez Sanchez, *Northern Arizona University*

Barack Obama's Presidential Campaign: A Redressing of American Politics on the Internet

Riva Starks, *Northern Arizona University*

PANEL 2

Moderator

Culture, Gender, Sexuality and Communication

Brian Rogers, *Northern Arizona University*

**FRIDAY
9:45 – 11:15 AM**

Sage

Reaching for the Stars: Acculturative Experiences of German Sojourners on a Southwestern Air Force Base

Tatjana K. Rosev, *University of New Mexico*

Sports, Homophobia, and Homosexual Affection: Social Learning Theory and Masculine Socialization Regarding Public Displays

Anthony R. Cuttitta, *Northern Arizona University*

Sexual Expectations on First Dates: Sex of Date Initiator, Date Location, and Rape Myth Acceptance

Jenny M. Farrell, *University of Nevada, Las Vegas*

With Legal Civil Unions, is Mexico Safe for Gays? An Exploration of the Rhetorical Limits for Mexican Asylum Seekers in the United States

Sara L. McKinnon *University of New Mexico*

Karma R. Chavez, *University of New Mexico*

PANEL 3

Moderator
Discussant

Instructional Communication Constructs and Consequences in the Classroom

Marji Price, *Brigham Young University, Idaho*
Kay Lynn Broadhead, *Idaho State University*

**FRIDAY
2:45 – 4:15 PM**

Sage

A Review of the Literature Regarding Interaction between Instructional Technology and Instructor Immediacy

Brian Rogers, *Northern Arizona University*

Communication Apprehension and Cultural Issues in the Classroom: A Review of the Literature

Amanda Carrillo, *Northern Arizona University*

A Review of the Literature on Instructor Humor and Its Consequences in the Classroom

Enrique Ramirez Sanchez, *Northern Arizona University*

'I would rather be attacked by shark': A Review of the Literature on Communication Apprehension in Education

Ben D. A. Heffington, *Northern Arizona University*

PANEL 4

Moderator

Media, Popular Culture and Human Communication

Emilly Borthwick, *Northern Arizona University*

**FRIDAY
4:30 – 6:00 PM**

Sage

Mediated Political Reality in *Frontline's* 'Kim's Nuclear Gamble'

Shannon Stevens, *University of Nevada, Las Vegas*

The Uptake and Circulation of Debated Representations: Representing Human Trafficking of Prostituted Women

Daniel Foster, *University of Denver*

Bob Dylan Online: Reclusive Strategies and the Evolution of Fan Culture

Lisa Eutsey, *The Pennsylvania State University*

PBS *Frontline's News War* as Propaganda: An Analysis of Narration, Interviews and Footage

Jenny M. Farrell, *University of Nevada, Las Vegas*

SPECIAL EVENT

Human Communication Section

Business Meeting

**SATURDAY
8:00 – 9:30 AM**

SAGE

Human Communication

PANEL 5

Moderator

Campaign Communication in 2008: Case Studies II

Brant Short, *Northern Arizona University*

SATURDAY
9:45 – 11:15 AM

Sage

America's Toughest Sheriff: The Use of Immigration Appeals in Sheriff Joe Arpaio's 2008 Reelection Campaign

Amanda Carrillo, *Northern Arizona University*

Girl, Interrupted: How Character and Gender Cost Hillary Clinton the 2008 Democratic Presidential Nomination

Tracie Hansen, *Northern Arizona University*

The Religious Exigency of Barack Obama and John McCain

Kevin Snyder, *Northern Arizona University*

Change is Not for Everyone: Gay Rights and the Election of 2008

Anthony R. Cuttitta, *Northern Arizona University*

PANEL 6

Moderator

Technology and Human Communication

Dayle Hardy-Short, *Northern Arizona University*

SATURDAY
1:00 – 2:30 PM

Sage

Going Digital: What the Mp3 is doing to the Music Industry

Zac Ziegler, *Northern Arizona University*

Kick Starting the Conversation: How YouTube Could Alter Marginalized Representation

Brian Rogers, *Northern Arizona University*

Bridging the Media Divide in the Classroom: Instructional Strategies for Contemporary Students

Jerry Thull, *Northern Arizona University*

Give It Away Now: The World of New Media in the New Era of Free

Jon Torn, *Northern Arizona University*

PANEL 7

Moderator

Case Studies in Political Communication

Daniel Foster, *University of Denver*

SATURDAY
2:45 – 4:15 PM

Sage

The Political Life of New Mexico Governor Bill Richardson, 2008 Presidential Candidate

Diana Cudeii, *Northern Arizona University*

Why Are Americans So Angry?: A Rhetorical Criticism of Ron Paul's Answer to the House of Representatives

Benjamin D. A. Heffington, *Northern Arizona University*

Native American Graves Protection and Repatriation Act: How It Affected a Native Hawaiian Conflict

Emilly Borthwick, *Northern Arizona University*

Flyfishing Saves Lives: A Study of Shared Perspectives in Relationship to Human Activity and Decreased Population of Dolly Varden

Zachary Alan Mickelsen, *University of Alaska, Juneau*

Kay Lynn Broadhead, *Idaho State University*

**LATIN AMERICAN
STUDIES**
Ramón Gómez Zamudio
Universidad de Guadalajara
Jorge Abel Rosales Soldana
Universidad de Guadalajara

PANEL 1 **Migration and Citizenship: Local and Regional Issues**
Moderator Nelson Valdéz, *University of New Mexico*

**THURSDAY
8:00 – 9:30 AM**

Sendero I

The New Desaparecidos: Effects of Missing Migrants on Families in Sending Communities of Southern Mexico

Sara L. Bollinger, *University of Arizona*

La Migración Centroamericana en la Frontera Sur de México: Compromisos, Políticas y Ficciones en Materia de Protección a los Derechos Humanos

Jorge A. Rosales, *Universidad de Guadalajara*

Ramón Gómez Zamudio, *Universidad de Guadalajara*

La Crisis Económica y los Derechos Ciudadanos

Mirta Villegas, *Universidad de Guadalajara*

La Política de las Políticas Públicas en el Nivel Subnacional en México.

Juan Poom Medina

PANEL 2 **New Left Political Trends in Latin American Governments**
Moderator Ignacio Medina, *ITESO*

**THURSDAY
9:45 – 11:15 AM**

Sendero I

Petro para la Patria: The Nationalization of Mexican and Cuban Petroleum and the Inconsistency of U. S. Policy toward Latin America

Joseph J. Garcia, *University of New Mexico*

Antimodern and Antiliberal Thought in Brazilian Modernismo: Oswald de Andrade and Plinio Salgado

Juri Bottura, *Vanderbilt University*

El Ascenso Político Electoral de la Izquierda en América Latina

Ignacio Medina, *ITESO*

Signs of Revolution: Public Messages in Cuba

Max Fitzpatrick

PANEL 3 **Education in Times of Liberalism**
Moderator Jorge A. Rosales Saldaña, *Universidad de Guadalajara*

**THURSDAY
4:30 – 6:00 PM**

Sendero I

Education and Labor: Interdisciplinary Location of Transition School to the Workplace

Jesús Ruiz Flores, *Observatorio Ciudadano de la Educación*

Sergio Sandoval, *Observatorio Ciudadano de la Educación*

Liliana Castañeda, *Observatorio Ciudadano de la Educación*

Política de Contención Salarial: Impactos en el Desempeño de Profesores Universitarios

Roberto Ochoa Macías, Marco A. Cortes Guardado and Jesús Ruiz Flores

Universidad de Guadalajara, CUCSH

Impact of Charter Schools on Latino Students in Los Angeles Area

Chris Yoon, *Azusa Pacific University*

MASS COMMUNICATION

Gil Fowler

Arkansas State University

PANEL 1

Moderator

International Communication

Ralph E. Hanson, *University of Nebraska at Kearney*

**THURSDAY
1:00 – 2:30 PM**

Sendero I

Bias from the Middle East? A Comparison of Online News Content of Al Jazeera English and CNN

Kris Kodrich, *Colorado State University*

Mass Media and Social Capital in the Middle East: A Multidimensional Approach

Paula F. Furr, *Northwestern State University*

Hesham M. Mesbah, *Northwestern State University*

PANEL 2

Moderator

Hollywood and Media

Mary Jackson Pitts, *Arkansas State University*

**THURSDAY
2:45 – 4:15 PM**

Sendero I

The Incas through the Lens of Hollywood

Kimberly Eberhardt Casteline, *University of Colorado - Boulder*

Shu-Ling Chen Berggreen, *University of Colorado - Boulder*

But it's Just a Movie: The Revealing Nature of Hollywood in a Post-racial Society

Frederick Gooding, *The Minority Reporter, Rockville, MD*

Winslow, Arizona: Frozen in Time; Documenting a Community in Economic Stress through Words and Photographs

Mary Tolan, *Northern Arizona University*

Laura Camden, *Northern Arizona University*

PANEL 3

Moderator

Community Journalism

Rodney Osborne, *Northeastern State University*

**FRIDAY
8:00 – 9:30 AM**

Sendero I

Community Radio as an Alternative to Corporate and Public Radio

Ralph E. Hanson, *University of Nebraska at Kearney*

Maryanne Reed, *West Virginia University*

Briana Warner, *Press Assistant, Senate Office of John D. Rockefeller IV*

An 'Extended' Focus Group Design to Help Community Newspapers Market Themselves

J. Sean McCleneghan, *New Mexico State University*

Anonymous No More: The Impact of Requiring Readers to Identify Themselves in Online Comments

Steve Schild, *Saint Mary's University*

PANEL 4
Moderator
New Era in Journalism: Online News
Janet Roehl, *Eastern New Mexico University*

FRIDAY
9:45 – 11:15 AM

Sendero I

TMZ or CNN: The Changing Face of the News Media
Patricia Dobson, *Eastern New Mexico University*

Where Have All the Journalists Gone?
Janet E. Roehl, *Eastern New Mexico University*

Legal Issues Facing Bloggers
Margaret Kirby, *Eastern New Mexico University*

PANEL 5
Moderator
Crisis Communication
Rozilyn Miller, *University of Central Oklahoma*

FRIDAY
1:00 – 2:30 PM

Sendero I

Crisis Notification Methods Preferred by Students, Staff and Faculty
Rodney Osborne, *Northeastern State University*
Mark Hughes, *McAlester Army Ammunition Plant*

Grief in the Public Sphere: An Analysis of Mediated Grief Trends Following the Death of Actor Heath Ledger
Susan L. Lewis, *Abilene Christian University*

Online News Media and Interactive Disaster-Relief Communities: Using Technology to Connect with Public Compassion
Kris Kodrich, *Colorado State University*
Melinda Laituri, *Colorado State University*

PANEL 6
Moderator
Media and Education
Paula Furr, *Northwestern State University*

FRIDAY
2:45 – 4:15 PM

Sendero I

Teaching Public Relations Ethics to the Millennial Generation
Holly Hall Byars, *Arkansas State University*

Mass Communication Configurations in the 21st Century: An Examination of 200 Undergraduate Public College and University Mass Communication Department
Rozilyn Miller, *University of Central Oklahoma*

The Positive Approach to Teaching Diversity beyond Black and White
Sandra L. Combs, *Arkansas State University*

PANEL 7
Moderator
Media, Education, and Advertising
Mark Hughes, *McAlester Army Ammunition Plant*

FRIDAY
4:30 – 6:00 PM

Sendero I

Teaching Science through Multimedia Story-telling: Collaborative Learning Between Science Teachers and 6th - 8th Graders
Mary Jackson Pitts, *Arkansas State University*
Lily Zeng, *Arkansas State University*

The Ideology of Childhood and the Press Coverage of Undocumented Children in the United States
Theresa Rose Crapanzano, *University of Colorado - Boulder*
Shu-Ling Chen Berggreen, *University of Colorado - Boulder*
Cari Lee Skogberg Eastman, *University of Colorado - Boulder*

The Role of Advertising during Tough Economic Times
Richard M. Lei, *Northern Arizona University*

Mass Communication

PANEL 8

Moderator

The Internet and New Media

Kimberly Eberhardt Casteline, *University of Colorado – Boulder*

**SATURDAY
8:00 – 9:30 AM**

Sendero I

Web Satisfaction: Reaching Your Publics

Mary Jackson Pitts, *Arkansas State University*

With Liberty and YouTube for All?: Performing Race through User Created Content on America's Most Popular Video Sharing Website

Kimball Maw Jensen, *Claremont Graduate University*

Wikis, YouTube, Podcasts: A Challenge for Research and Curricular Design in the Social Sciences

Marcella LaFever, *California State University Stanislaus*

PANEL 9

Moderator

Visual Communication

Marcella LaFever, *California State University Stanislaus*

**SATURDAY
9:45 – 11:15 AM**

Sendero I

Kid Nation: Cultural Stereotypes Sadly Reinvigorated Through Reality TV

Shu-Ling Chen Berggreen, *University of Colorado - Boulder*

Kimberly Eberhardt Casteline, *University of Colorado - Boulder*

Hooah: A Visual Literacy Project for the U.S. Army

Judy Oskam, *Texas State University*

The Influence of the Amount of Time Viewing Television and Voting Behavior

Anthony B. Schroeder, *Eastern New Mexico University*

Christopher B. Stasheff, *Eastern New Mexico University*

Michael Harman, *Eastern New Mexico University*

PANEL 1
Moderator

Station Life
William C. Schaniel, *University of West Georgia*

THURSDAY
9:45- 11:15 AM

Enchantment F

Cross - listed with
RURAL STUDIES

Reading Morven Hills: Stock and Station Agency Records of a Historic Sheep Station in Central Otago

Tom Isern, *North Dakota State University*
Suzanne Kelley, *North Dakota State University*

Yeeda Station: Jewel of the Kimberly

Jim Hoy, *Emporia State University*
Cathy Hoy, *Emporia State University*

PANEL 2
Moderator

Views and Reviews of the movie "Australia"
Suzanne Kelley, *North Dakota State University*

THURSDAY
1:00 – 2:30 PM

Enchantment F

Cross - listed with
RURAL STUDIES

Discussants:

William C. Schaniel, *University of West Georgia*
Suzanne Kelley, *North Dakota State University*
Teresa D. Orr, *University of West Georgia*
Jim Hoy, *Emporia State University*
Cathy Hoy, *Emporia State University*

PANEL 3
Moderator

Empires Large and Small
Jim Maher, *University of New England*

THURSDAY
2:45 - 4:15 PM

Fiesta 1

Cross - listed with
CANADIAN STUDIES

Constitutional Recognition of Local Government in Australia: Third Time Lucky?

Jim Maher, *University of New England, Australia and Deputy Mayor Armidale Dumaresq Council*

Queensland, British Columbia and New Zealand React to the United States: Colonial Perspectives on the Emerging American Empire, 1869-1870

Fr. Thomas Murphy, S.J., *Seattle University*

**New Zealand &
Australian Studies**

PANEL 4

Moderator

Politics and Law in Australia

William C. Schaniel, *University of West Georgia*

**FRIDAY
1:00 – 2:30 AM**

Pavilion I

**Indigenous Political Organization at the National Level: A Replacement for
ATSIC?**

Jim Maher, *University of New England, Australia*

Steve Widders, *Armidale Dumaresq Council, Australia*

**The Sex Industry in New South Wales: A Critical Overview of Recent
Legislative Changes**

John Scott, *University of New England, Australia*

PANEL 5

**Current Directions in the Promotion and Institutionalization of Canadian Studies: Regional and
National Initiatives in the United States**

**FRIDAY
2:45 - 4:15 PM**

Fiesta 1

**Cross - listed with
CANADIAN STUDIES**

Panelists:

Christopher Kirkey, *State University of New York at Plattsburgh*

Jamie Caton, *Canadian Consulate General in Denver*

Kevin Cook, *Canadian Consulate General in Seattle*

POLITICAL SCIENCE

Jack W. Hou

California State University, Long Beach

PANEL 1

Moderator

Gender Issues in the Political System

John Francis Burke, *University of St. Thomas*

THURSDAY
8:00 – 9:30 AM

Sage

The Gender Gap: Myth or Reality

Mary A. Benanti, *New Mexico State University*

Assessing Determinants of Public Policy Preferences among Women and Men State Legislators: A Rational Choice Approach

Mark C. Ellickson, *Missouri State University*

Donald Whistler, *University of Central Arkansas*

PANEL 2

Moderator

Politics and War

Mary A. Benanti, *New Mexico State University*

THURSDAY
9:45 – 11:15 AM

Sage

War in the Congo: 2001 – 2008

Daniel G. Acheson-Brown, *Eastern New Mexico University*

Causes and Consequences of Mercenary Armies

Aaron Elinoff, *Fort Lewis College*

The Development of Paranoia in Political Dictators: A Social-constructionist Approach

Elizabeth Self, *Eastern New Mexico University*

PANEL 3

Moderator

Political Science and Socio-Economic Issues

Elizabeth Self, *Eastern New Mexico University*

THURSDAY
1:00 – 2:30 PM

Sage

Does Inequality Matter? Globalization and People's Perceptions of IGOs

Satoshi Machida, *University of Nebraska at Kearney*

Bargaining Power in Primary Commodity Markets: Examining Institutional Change in the International Cocoa Organization

James Timberlake, *University of New Mexico*

PANEL 4

Moderator

Political Science and Social Issues

Yohannes Woldemariam, *Fort Lewis College*

FRIDAY
8:00 – 9:30 AM

Fiesta 1

Arendt and the Pursuit of Public Happiness: Possibilities for the 21st Century

Kelly Jacobs, *University of St. Thomas*

A Study of the Motivations and Issues that Drive College Students and Young People to be Politically Active

David Zapata, *St. Mary's University*

Finding That Ole Time Religion: Press Coverage of the Presidential Candidates' Religions in 2008

John David Rausch, Jr., *West Texas A&M University*

Reed L. Welch, *West Texas A&M University*

Susan Ashley, *West Texas A&M University*

How Political Cronyism and Corporate Influence Compromise Science and the Agencies that are Supposed to Protect Public Health

Stuart Zisman, *Walden University*

Political Science

PANEL 5

Moderator

International Relations

Reed Welch, *West Texas A&M University*

**FRIDAY
4:30 – 6:30 PM**

Fiesta 2

International Relations in Perspective

Christopher S. Gabaldon, *New Mexico Highlands University*

Mirror, mirror on the wall... Why is there a wall after all? The Return of the Wall in International Relations

Charles-Philippe David, *University of Quebec at Montreal*

Elisabeth Vallet, *University of Quebec at Montreal*

The Crisis of the State System in Africa

Yohannes Woldemariam, *Fort Lewis College*

PANEL 6

Moderator

War and Politics

Elijah Logsdon, *Fort Lewis College*

**SATURDAY
9:45 – 11:15 AM**

Enchantment B

Not a Blank Check: The Supreme Court and Presidential War Power After 9-11

Stephen K. Shaw, *Northwest Nazarene University*

Neoconservative Philosophy and the Run-Up to the Iraq War

Lindsey K. Hill, *New Mexico Highlands University*

The Bomb Deception of Iran

Abbas Manafy, *New Mexico Highlands University*

PANEL 7

Moderator

Ideology, Politics, and Foreign Policy

Abbas Manafy, *New Mexico Highlands University*

**SATURDAY
1:00 – 2:30 PM**

Enchantment B

A Critical Analysis of U.S. Foreign Policy

Keith B. Smith, *New Mexico Highlands University*

U.S. Foreign Policy and Human Rights

Shulamite Abang, *New Mexico Highlands University*

U.S. Policy of Interventionism in Iraq

Lindsey K. Hill, *New Mexico Highlands University*

PANEL 8

Moderator

Ideology as a Determinant of Political Climate

Stephen K. Shaw, *Northwest Nazarene University*

**FRIDAY
2:45 – 4:15 PM**

Enchantment B

Is Islam a Barrier to Liberal Democracy?

Elijah Logsdon, *Fort Lewis College*

A Critique on Ideology and its Various Uses in Politics

Erin A. Lopez, *New Mexico Highlands University*

Understanding the Root Causes of Anti-Americanism in the Middle East

Abbas Manafy, *New Mexico Highlands University*

PUBLIC ADMINISTRATION

Victor L. Heller

University of Texas, - San Antonio

Nathan A. Heller

Northern Arizona University

PANEL 1

Moderator

Mexico Public Policy Challenges

Vic Heller, *University of Texas - San Antonio*

**THURSDAY
8:00 – 9:30 AM**

Enchantment D

Dust in the Wind; Connecting Hidden Theory with Misguided Planning Efforts in US-Mexico Border Colonias

Annette Morales, *Medius Inc.*

Sam Schmitt, *New Mexico State University*

The Applicability and Awkwardness of the Concept of Public Policy Approach in Non English-speaking Countries

Nicolas Pineda-Pablos, *El Colegio De Sonora*

PANEL 2

Moderator

Local Government and Student Stakeholders

Annette Morales, *Medius Inc.*

**THURSDAY
9:45 – 11:15 AM**

Enchantment D

How Did a Local Community Promote Students' Walking and Bicycling? A Safe Routes to School Project Initiative through Community Partnership

Kenichi Maruyama, *Arizona State University*

Viola Fuentes, *New Mexico State University*

Are Metro Campus MBA and MPA Students Customers? The Application and Limitation of NPM Model to Examine the Student Experience

Kenichi Maruyama, *Arizona State University*

PANEL 3

Moderator

Governmental Reform

Kenichi Maruyama, *Arizona State University*

**THURSDAY
1:00 – 2:30 PM**

Enchantment D

Cross Cultural Implications for NGO Management

Patsy Kraeger, *Arizona State University*

Maintaining the Public Interest in an Era of NPM Driven Economic Strategies

Viola Fuentes, *New Mexico State University*

PANEL 4

Moderator

New Organizational Possibilities

Patsy Kraeger, *Arizona State University*

**THURSDAY
2:45 – 4:15 PM**

Enchantment D

Public Sector Innovation in Asia and the Pacific Region?

Soyoon Chung, *Arizona State University*

Disabled Human Resources Management: A Comparative Perspective

Chon-Kyun Kim, *Texas A&M University, Corpus Christi*

Public Administration

PANEL 5

Moderator

Today's Administrative Challenges

Soyoon Chung, *Arizona State University*

**THURSDAY
4:30 – 6:00 PM**

Enchantment D

Information Access and Protection of Privacy: Cornerstones of the Democratic Administrative State

David L. Baker, *California State University: San Bernardino*

Where have all the Trainees Gone? A Prescription for Succession Planning

Lorna Stefanick, *Athabasca University, Canada*

PANEL 6

Moderator

Impact of the Transportation Security Administration

Lorna Stefanick, *Athabasca University, Canada*

**FRIDAY
8:00 – 9:30 AM**

Enchantment D

The Effect of Confidence in the Transportation Security Administration on the Brand Equity of Major Airlines

Nathan A. Heller, *Northern Arizona University*

PANEL 7

Moderator

Ethics in Government

Nathan A. Heller, *Northern Arizona University*

**FRIDAY
9:45 – 11:15 AM**

Enchantment D

Does Anyone Care About Public Sector Ethics?

Joseph Graves, *University of Texas at El Paso*

Public v. Private Organizations: Do Their Ethical Challenges Differ?

Victor L. Heller, *University of Texas - San Antonio*

Ethics in NPOs: Are They Above Reproach?

Victor L. Heller, *University of Texas - San Antonio*

Nathan A. Heller, *Northern Arizona University*

PUBLIC FINANCE & BUDGETING

Zhirong (Jerry) Zhao

University of Minnesota

Michael Moody

University of Kansas

PANEL 1

Moderator

State and Local Taxation

Jerry Zhao, *University of Minnesota*

**THURSDAY
8:00 – 9:30 AM**

Fiesta 3

Modernizing state and local tax systems: Illinois' Experience with a Local Option Tax on Telecommunication Services

Yonghong Wu, *University of Illinois at Chicago*

David Merriman, *University of Illinois at Chicago*

Property Tax Assessment Reform: Administration and Politics at the Street Level of Tax Policy

Scott Moore, *Colorado State University*

Rich District, Poor Districts: The Tax Efforts of Arkansas School Districts

Meagan M. Jordan, *University of Arkansas at Little Rock*

Sharon L. Wrobel, *University of Arkansas at Little Rock*

The Effects of Local Option Sales Tax on School Facilities Funding: Evidence from North Carolina

Wen Wang, *University of South Carolina*

Zhirong (Jerry) Zhao, *University of Minnesota*

PANEL 2

Moderator

Budget Deficits in the States (Panel 1)

James Conant, *George Mason University*

**THURSDAY
9:45 – 11:15 AM**

Fiesta 3

Budget Deficits in the States: The State of Connecticut

Kenneth Dautrich, *University of Connecticut*

Mark Robbins, *University of Connecticut*

Bill Simonsen, *University of Connecticut*

Budget Deficits in the States: The State of Massachusetts

Douglas Snow, *Suffolk University*

Budget Deficits in the States: The State of Illinois

Beverly Bunch, *University of Illinois at Springfield*

Budget Deficits in the States: The State of New York

Bill Duncombe, *Syracuse University*

Robert Bifulco, *Syracuse University*

Public Finance & Budgeting

PANEL 3

Moderator

Infrastructure and Development (Including the Development of ABFM)

Justin Marlowe, *University of Kansas*

THURSDAY
1:00 – 2:30 PM

Fiesta 3

Mapping a Field's Development: 20 years of ABFM Conferences

W. Bartley Hildreth, *Wichita State University*

Assessing the Financial Impact of The Waterfront Development

Mary Jane Kuffner Hirt, *Indiana University of Pennsylvania*

The Increasing Use of Earmarks to Fund Local Infrastructure: A Case Study of Illinois Municipal Governments

Karen Kunz, *West Virginia University*

Planning for Public Infrastructure Investment: The Case of Omaha, Nebraska

Carl D. Ekstrom, *University of Nebraska—Omaha*

PANEL 4

Moderator

Tax, Expenditure, and Debt Limits

Dan Smith, *New York University*

THURSDAY
2:45 – 4:15 PM

Fiesta 3

New York State Fiscal Institutions and Municipal Borrowing: Do Debt and Taxation Limits Really Impact Capital Costs?

Gao Liu, *University of Kentucky*

Jacob Fowles, *University of Kentucky*

Wie Yusuf, *Old Dominion University*

State Tax and Expenditure Limits: There still is no Story

Sharon N. Kioko, *Syracuse University*

PANEL 5

Moderator

Debt Management

W. Bart Hildreth, *Wichita State University*

THURSDAY
4:30 – 6:00 PM

Fiesta 3

A First Look at Municipal Bond Holdings of Property Casualty Insurers

Michael Moody, *University of Kansas*

The Capital Market and Readiness of Issuing Municipal Bonds in Taiwan

Ching-Mei Lin, *National Chengchi University & University of Connecticut*

Debt Management Networks and the Proverbs of Financial Management: Principles and Interests in the New York MTA Debt Restructuring

Gerald Miller, *Arizona State University*

Jonathan B. Justice, *University of Delaware*

PANEL 6

Moderator

The Price of Living—User Fees and Taxes

Wie Yusuf, *Old Dominion University*

**FRIDAY
8:00 – 9:30 AM**

Fiesta 3

The Effect of User Charges on the Expenditure Level of Charge-Financed Services

Changhoon Jung, *Auburn University*

Rui Sun, *University of Maryland*

Theodore Arapis, *Auburn University*

Juchan Kim, *Kwangwoon University*

Revisiting “The Price of Government” Construct: Benefits of User Charges and Fees as Self-Regulating Mechanisms

David L. Baker, *California State University at San Bernadino*

A Taxing Day of Life: Estimating the Comparative Price of a Set of Events Invoking Taxes, User Charges and Fines

W. Bartley Hildreth, *Wichita State University*

PANEL 7

Moderator

Financial Management

Jonathan Justice, *University of Delaware*

**FRIDAY
9:45 – 11:15 AM**

Fiesta 3

Management Discussion and Analysis in Local Comprehensive Annual Financial Reports: Grading Their Disclosure in Tough Times

Howard Frank, *Florida International University*

David Guo, *Florida International University*

Douglas R. Fink, *Florida International University*

The Effects on Municipalities and Their Employees of GASB 45: A Tale of One City

Thomas Musumeci, *Old Dominion University*

Wie Yusuf, *Old Dominion University*

The Impact of Indian Gaming on Tribal Sovereignty and Financial Management

Kevi J. Brown, *University of Oklahoma*

Aimee L. Franklin, *University of Oklahoma*

The Practice of Enterprise Resource Planning for Budgeting and Financial Management in State Government

Jonathan Gross, *Auburn University*

Changhoon Jung, *Auburn University*

Josh Zender, *Auburn University*

PANEL 8

Moderator

Budget Deficits in the States (Panel 2)

Thomas Lauth, *University of Georgia*

**FRIDAY
1:00 – 2:30 PM**

Fiesta 3

Budget Deficits in the States: The State of Georgia

Thomas Lauth, *University of Georgia*

Budget Deficits in the States: The State of Wisconsin

James Conant, *George Mason University*

Budget Deficits in the States: The State of California

Robert Gardner, *Dryden Flight Research Center, NASA*

Budget Deficits in the States: The State of Virginia

James Conant, *George Mason University*

PANEL 9

Moderator

Following the Money: Does the Source of Funds Impact Outcomes?

Michael Moody, *University of Kansas*

**FRIDAY
2:45 – 4:15 PM**

Fiesta 3

Does the Federal Medicaid Match Stabilize Non-Health Care Expenditures in the States?

Yilin Hou, *University of Georgia*

Justin Marlowe, *University of Kansas*

Sanjay Pandey, *University of Kansas*

Does the Use of Interfund Transfers Policy Affect the Level of Fund Balance Transfer?

Changhoon Jung, *Auburn University*

Taeho Eom, *Yonsei University*

Determinants of Corporate Giving: Does Industry Type Make a Difference?

Xiaolu (Sherry) Ou, *University of Minnesota*

The Relationship between Private Giving and State Funding among Maryland's Four-Year Public Institutions

John L. Cox, *George Washington University*

RURAL STUDIES

Anthony Amato

Southwest Minnesota State University

Suzanne Kelley

North Dakota State University

PANEL 1 **Heritage Studies: Defining the Field**

**THURSDAY
8:00 – 9:30 AM**

Enchantment F

Discussants:

Jim Hoy, *Emporia State University*
Tom Isern, *North Dakota State University*
Clyde A. Milner II, *Arkansas State University*
Joyce Thierer, *Emporia State University*

PANEL 2 **Station Life** Moderator

William C. Schaniel, *University of West Georgia*

**THURSDAY
9:45- 11:15 AM**

Enchantment F

**Cross - listed with
NEW ZEALAND &
AUSTRALIA STUDIES**

Reading Morven Hills: Stock and Station Agency Records of a Historic Sheep Station in Central Otago

Tom Isern, *North Dakota State University*
Suzanne Kelley, *North Dakota State University*

Yeeda Station: Jewel of the Kimberly

Jim Hoy, *Emporia State University*
Cathy Hoy, *Emporia State University*

PANEL 3 **Views and Reviews of the movie "Australia"** Moderator

Suzanne Kelley, *North Dakota State University*

**THURSDAY
1:00 – 2:30 PM**

Enchantment F

**Cross - listed with
NEW ZEALAND &
AUSTRALIA STUDIES**

Discussants:

William C. Schaniel, *University of West Georgia*
Suzanne Kelley, *North Dakota State University*
Teresa D. Orr, *University of West Georgia*
Jim Hoy, *Emporia State University*
Cathy Hoy, *Emporia State University*

Rural Studies

PANEL 4

Moderator
Discussants

Heritage Studies: Reports from the Field

Clyde A. Milner II, *Arkansas State University*
The Audience

THURSDAY
2:45 – 4:15 PM

Enchantment F

The New Regional History: An Exercise in Historical Methods

Miles Lewis, *North Dakota State University*

Brotherhood and Beyond: The FarmHouse Documentation Project

Andrea Mott, *North Dakota State University*

Somebody Had to Stay Home: Never-Ending Chores and Responsibilities

Jessica Clark, *North Dakota State University*

PANEL 5

Moderator

Gather 'round the Table: The Fourth Annual Rural & Agricultural Studies Book Discussion, featuring *Mockingbird Song: Ecological Landscapes of the South*, by Jack Temple Kirby

Anthony Amato, *Southwest Minnesota State University*

THURSDAY
4:30 – 6:00 PM

Enchantment F

Discussants

Suzanne Kelley, *North Dakota State University*

Kevin Wipf, *University of Alberta*

Andrea Mott, *North Dakota State University*

Miles Lewis, *North Dakota State University*

Brian P. Thompson, *California State University, Fullerton*

PANEL 6

Moderator

Action and Actors Behind the Scenes

Anthony Amato, *Southwest Minnesota State University*

FRIDAY
2:45 – 4:15 PM

Enchantment F

Monkey Business: Commercial and Conservational Dynamics of Rural Gold Coast [Ghana] and Côte D'Ivoire, 1889 - 1939

Brian P. Thompson, *California State University Fullerton*

Down in the Valley: Nebraska's Hidden Nisei

Sandra Reddish, *Kansas State University*

PANEL 7

Moderator

Innovation and Rural Renovation

Anthony Amato, *Southwest Minnesota State University*

FRIDAY
4:30 – 6:00 PM

Fiesta 4

Passenger Choice in Intercity Rural Transportation

Bill Thoms, *North Dakota State University*

Rural Schools in Nebraska: Robust Political Voices from the Edges

Peter J. Longo, *University of Nebraska at Kearney*

John Anderson, *University of Nebraska at Kearney*

Reform and Persistence: The Case of the Canadian Wheat Board

Kevin Wipf, *University of Alberta*

SLAVIC STUDIES

Mark A. Cichock

University of Texas at Arlington

PANEL 1

Moderator

Language, Art, and Meaning in Eastern Europe

Mark A. Cichock, *University of Texas at Arlington*

**FRIDAY
1:00 – 2:30 PM**

Fiesta 1

(Re)Conceptualizing Gender Equality: Deconstructing the Polish Language of Feminism

Sonia Angelique Iwanek, *Collin County Community College*

Selected Russian Proverbs: An Abstract

Ann K. Johnson, *Sul Ross State University*

Looking at Czech Sci-Fi: From Paral to Neff

Cynthia A. Klima, *State University of New York-Geneseo*

PANEL 2

Moderator

Russia, the Near Abroad, and Emigration

Cynthia A. Klima, *State University of New York-Geneseo*

**FRIDAY
4:30 – 6:00 PM**

Fiesta 3

Normalizing Abnormal Relations: Georgia and Russia after the 2008 War

Mark A. Cichock, *University of Texas at Arlington*

The Anti-Communist Committee of Russian Emigres in North China, 1937-1945

Ed Glatfelter, *Utah State University*

PANEL 3

Moderator

Issues in Eastern Europe before World War I

Ed Glatfelter, *Utah State University*

**SATURDAY
9:45 – 11:15 AM**

Fiesta 3

Have a Drink! Pubs and Urban Property Ownership in the Nineteenth Century Balkans,

Evguenia Davidova, *Portland State University*

Two Austrian Approaches to the National Question in East Central Europe

Peter C. Mentzel, *The Liberty Fund*

No Smoke without Fire: Tobacco and Transformation in Early Twentieth Century Bulgaria

Mary Neuburger, *University of Texas, Austin*

SOCIOLOGY
Heather Albanesi
University of Colorado
Colorado Springs

PANEL 1 **Sociology of Religion**
Moderator Heather Albanesi, *University of Colorado at Colorado Springs*

THURSDAY
8:00 – 9:30 AM
Enchantment C

Small Faith-based Networks among Muslim women
Emira Ibrahimasic, *University of New Mexico*

Women and Politics in Islam
Abeer Ibrahim, *University of Colorado at Colorado Springs*

A re-analysis of Whether Religion is a Health Resource for the Poor
Saron Wersom, *Western Washington University*

Trends in College Student's Religiosity
Tim Baylor, *Lock Haven University*

PANEL 2 **Privilege, Parenting and Education**
Moderator/Discussant Julie Biando Edwards, *University of Montana*

THURSDAY
9:45 – 11:15 AM
Enchantment C

Equality, Equity, and the Margin of Perceived Competitive Advantage
Thomas Halverson, *University of Washington*

The 'Redshirting' of Kindergarteners as 'Concerted Cultivation'
Heather Albanesi, *University of Colorado at Colorado Springs*

PANEL 3 **A Roundtable Discussion on Teaching**
Moderator Sarah Swedberg, *Mesa State College*

THURSDAY
1:00 – 2:30 PM
Enchantment A
Cross - listed with
AMERICAN STUDIES

Teaching to the Top or Teaching to the Bottom?

Sarah Swedberg, *Mesa State College*
Adele Cummings, *Mesa State College*
Maria Boikova Struble, *Western State College*
Martha E. Kinney, *Suffolk County Community College*
Pattie Dillon, *Spalding University*

PANEL 4 **Art, Space and the Creation of Meaning**
Moderator Benjamin Edwards, *University of New Mexico*

THURSDAY
1:00 – 2:30 PM
Enchantment C

Stories and Histories: The Social Semiotics of Public Monuments in Casper, Wyoming

Julie Biando Edwards, *University of Montana*
Stephan P. Edwards, *University of Montana*

Reaching for the Stars: Russian Cosmonauts' Lives and Space Experience
Michael L. Hirsch, *Huston-Tillotson University*
Dawn Shannon, *Huston-Tillotson University*

PANEL 5

Moderator/Discussant

Sociology of the Body and Sexuality

David Palumbo, *University of Colorado at Colorado Springs*

**THURSDAY
2:45 – 4:15 PM**

Enchantment C

Body Art and Sexual Activity among American College Students

Jerome R. Koch, *Texas Tech University*
Alden E. Roberts, *Texas Tech University*
Myrna L. Armstrong, *Texas Tech University*
Donna C. Owen, *Texas Tech University*

Non-mainstream Body Modification and Agented Deviance

Morgen Thomas, *University of Colorado at Colorado Springs*

Retrospective Analysis of the Female HIV/AIDS Epidemic: Lingering Issues in Risk and Prevention

Carole Campbell, *California State University at Long Beach*

PANEL 6

Moderator/Discussant

Disasters, Terrorism and Risk Analysis

Morgen Thomas, *University of Colorado at Colorado Springs*

**THURSDAY
4:30 – 6:00 PM**

Enchantment C

Risk Analysis in Cosmopolitanism World Society

Scott Denton, *University of Arizona*

A Brief Examination of Ascendant Suicide from Conflict and Structuration Perspectives

David Palumbo, *University of Colorado at Colorado Springs*

Bridge Building within Emergency Management Communities: Successes, Pitfalls, and Future Challenges

Thomas E. Drabek, *University of Denver*

The War on Terror: New Challenges for the 21st Century

Daniel Poole, *University of Utah*

PANEL 7

Moderator/Discussant

Sociology of Work and Organizations

Blake Butry, *University of Colorado at Colorado Springs*

**FRIDAY
8:00 – 9:30 AM**

Enchantment C

From 'Our Associates Make the Difference' to 'Save More, Live Better': Labor Marginalization and Worker Response at Wal-Mart

Irma Mathis and Michael V. Miller

Professional Perspectives on Consumer Understanding and Policy Ramifications of Personal Automobile Insurance

Rebecca Brown, *University of Colorado at Colorado Springs*

Power, Energy, and Organization: Interdisciplinary Insights

Marcelline Fusilier, *Northwestern State University of Louisiana*
Subhash Durlabhji, *Northwestern State University of Louisiana*

Satisfaction: A Longitudinal Study of Funeral Directors

Martha L. Shwayder, *Metropolitan State College of Denver Occupational*

PANEL 8

Moderator/Discussant

Gender: Theory, Crime and the Academy

Diane Calloway-Graham, *Utah State University*

**FRIDAY
8:00 – 9:30 AM**

Fiesta 2

**Cross - listed with
WOMEN STUDIES**

Rethinking Dichotomous Distinctions

Carol Key, *Tarleton State University*

Sexism or Professional Elitism? The Historical Influence on the Discipline of Home Economics in British Columbia

James J. Ponzetti, Jr., *University of British Columbia*

The Revolving Door of Recidivism: Characteristics of Female Drug Offenders, Substance Abuse Patterns, and Need for Treatment

Michelle Johnston, *University of Colorado at Colorado Springs*

PANEL 9

Moderator/Discussant

University Teaching and the Discipline of Sociology

Rebecca Brown, *University of Colorado at Colorado Springs*

**FRIDAY
9:45 – 11:15 AM**

Enchantment C

The Immune System as a Paradigm for Social Theory: A Return to Biology

Benjamin Edwards, *University of New Mexico*

University in Transition: Faculty Perspectives

Leslie D. Gonzales, *University of Texas at El Paso*

Seeing Red: Color of the Grading Pen and Student Reactions to the Grading Process

Richard Dukes, *University of Colorado at Colorado Springs*

Heather Albanesi, *University of Colorado at Colorado Springs*

Constructing a Vertically Integrated Sociology Program

Tadini Bacigalupi, *Metropolitan State College of Denver*

PANEL 10

Moderator/Discussant

Food, Poverty and Development

Carol Key, *Tarleton State University*

**FRIDAY
9:45 – 11:15 AM**

Enchantment F

Impact of Food Choices on Urban Native American Diets: Correlations to Reservation Nutritional Pathologies

Michèle Companion, *University of Colorado at Colorado Springs*

Chronic Strains Cause Weight Change, But Not Equally

Val Episcopo, *St. Edward's University*

Smoothing Out the Rough Spots: How Non-Income Resources and Instability Relate to Material Hardship

Gesemia Nelson, *Metropolitan State College of Denver*

PANEL 11

Moderator/Discussant

Development and the Expanding Influence of Global InstitutionsCarol Key, *Tarleton State University*FRIDAY
1:00 – 2:30 PM

Enchantment C

Debt Dependency and the Built Urban Environment: Examining the Growth of Urban Slums in the Less Developed Countries, 1990 - 2005James Rice, *New Mexico State University*Julie Steinkopf Rice, *New Mexico State University***Facing Favela's Stigma: The Work of A'o Comunit'ria do Brasil in Rio de Janeiro's shantytown**Manola Corrent, *University of Oklahoma***Reproductive Health and Millennium Development Goals in Developing Countries**Vijayan K. Pillai, *University of Texas at Arlington***PANEL 12**

Moderator/Discussant

Relations of Power, the Economy and the StateBenjamin Edwards, *University of New Mexico*FRIDAY
2:45 – 4:15 PM

Enchantment C

Bioterritorial 'Power': The U.S. Electric Grid as a Technology of GovernmentChelsea Schelly, *University of Wisconsin-Madison***Theorizing Alternative Economies: Applying Poststructuralism to Fair Trade**Julie Steinkopf Rice, *New Mexico State University***From Bad to Worse: The Implications of the Global Financial Crisis at the Intersections of Gender, Poverty, and Aging**Tina A. Quartaroli, *Future Age Consulting Inc***PANEL 13**

Moderator/Discussant

Health, Race and ImmigrationMichelle Johnston, *University of Colorado at Colorado Springs*FRIDAY
4:30 – 6:00 PM

Enchantment C

The Psychosocial Adjustment and Mental Health of Caribbean International Students at a Historically Black College & University: An Examination of Individual, Socio-cultural and Institutional FactorsNekehia Quashie, *University of Utah*Edward Stephenson, *University of Utah***Impact of Recent Immigration on Psychological Distress and Helpseeking among Filipino Americans**Aileen Duldulao, *University of Washington*Ethel Nicdao, *University of Washington***Complementary and Alternative Medicine: Correlates with Preventive Health Behaviors**Sophie Nathenson, *University of Utah***Voluntary and Involuntary Childlessness among African American Women**Lynda Dickson, *University of Colorado at Colorado Springs*

Sociology

PANEL 14

Moderator/Discussant

Grassroots Social Movements

Michèle Companion, *University of Colorado at Colorado Springs*

**SATURDAY
8:00 – 9:30 AM**

Enchantment C

New Information Communication Technologies and Grassroots Mobilization: The Role of Social Movement Organizations and Virtual Communities

Victoria Carty, *Chapman University*

"This thing, it is not finished." The Transformation of South African Political Identity

Judith Stevenson, *California State University, Long Beach*

PANEL 15

Moderator

Teaching Roundtable: Building Concept Based Assessment Tools for Sociology Students

Tadini Bacigalupi, *Metropolitan State College of Denver*

**SATURDAY
9:45 – 11:15 AM**

Enchantment C

Panelists:

Aileen Lucero, *Metropolitan State College of Denver*

Gesemia Nelson, *Metropolitan State College of Denver*

Martha Shwayder, *Metropolitan State College of Denver*

PANEL 16

Moderator

Discussant

Social Challenges in Practicing Archaeology: Case Studies from the Oaxaca Valley, Mexico

Jack Corbett, *Portland State University*

Nelly Robles Garcia, *Director of the Archaeological Zone of Monte Alban, Oaxaca, Mexico*

**SATURDAY
9:45 – 11:15 AM**

Enchantment F

Social Impacts of Archaeological Heritage Management: Assessing the Development of Santa Maria Atzompa

Augustin Andrade Cuautle, *National Institute of Anthropology and History*

The Complex Contexts of Monte Alban: The Social Anthropology of Archaeology in the Oaxaca Valley

Irma Lucia Cazares Munguia, *National Institute of Anthropology and History*

Who Speaks for the Dead? Prehispanic Burials and Contemporary Voices in the Oaxaca Valley

Ricardo Higelin Ponce de Leon, *National Institute of Anthropology and History*

Monte Alban: Social Implications in the Protection of Cultural Heritage

Dante Garcia Rios, *National Institute of Anthropology and History*

PANEL 17
Moderator

Social Movements and Collective Behavior: Theoretical Considerations & Research Results
James T. Richardson, *University of Nevada, Reno*

SATURDAY
1:00 – 2:30 PM
Enchantment C

Understanding Latino Support for the English-only Movement through System Justification Theory

H. Lyssette Chavez, *University of Nevada, Reno*

Monitoring and Surveillance of Religious Groups in America

James T. Richardson, *University of Nevada, Reno*

A Gendered Perspective on New Social Movements' Characteristics

Janice Russell, *University of Nevada, Reno*

Social Action in Response to Terrorism: Understanding Xenophobic Violence from a Value-Added Perspective

Victoria A. Springer, *University of Nevada, Reno*

PANEL 18
Moderator

The Systematic Study of Race & Public Policy From the UNM RWJF Center For Health Policy
Gabriel R. Sanchez, *University of New Mexico*

SATURDAY
2:45 – 4:15 PM
Enchantment C

The Long-term Consequences of Bank Disinvestment on Neighborhood Crime: An Analysis of Albuquerque Neighborhoods (1990 - 2006)

María B. Vélez, *University of New Mexico*
Christopher J. Lyons, *University of New Mexico*

A Description of the Institute for the Study of "Race" and Social Justice

Nancy Lopez, *University of New Mexico*
Laura Gomez, *University of New Mexico*

Understanding Urban Indian Health Care Needs in Bernalillo County

Robert Valdez, *University of New Mexico*
Tennille Marley, *University of New Mexico*

PANEL 19
Moderator

An Interdisciplinary Examination of Health Policy From the UNM RWJF Center For Health Policy
Gabriel R. Sanchez, *University of New Mexico*

SATURDAY
4:30 – 6:00 PM
Enchantment C

Factors that Determine Healthcare Coverage in New Mexico

Antonio Barreras, *University of New Mexico*
Gabriel Sanchez, *University of New Mexico*
Richard Santos, *University of New Mexico*
Amelia Rousse, *University of New Mexico*

Public Support for Expanding Health Care Coverage in New Mexico

German M. Izon, *University of New Mexico*

Do Vulnerable Populations Enjoy Improved Health During Periods of Economic Growth?

Matias Fontenla, *University of New Mexico*
Fidel Gonzalez, *Sam Houston State University*
Troy Quast, *Sam Houston State University*

States' Refusal of Abstinence-Only Education Funds

Sunny Bergh, *University of New Mexico*
Alesha Doan, *Kansas University*
Deborah McFarlane, *University New Mexico*

Urban Studies Thomas Sammons

University of Louisiana - Lafayette

PANEL 1

Moderator

Details and the Fine Grain of the Contemporary Culture

Jerry Malinowski, *University of Louisiana at Lafayette*

**FRIDAY
8:00 – 9:30 AM**

Fiesta 4

High Performance Lighting Solutions for a Sustainable Future

Brian Powell, *University of Louisiana at Lafayette*

Civility in Design: Cultivating Social Responsibility in the Design Studio- A Case Study

Brooke Davis, *University of Louisiana at Lafayette*

Conceptualizing the Ecological Street Tree

Georgia Silvera Seamans, *UC Berkeley*

PANEL 2

Moderator

Urban Studies and the Universities' Role within the Community

Robert McKinney, *University of Louisiana at Lafayette*

**FRIDAY
9:45 – 11:15 AM**

Boardroom East

Johnston Street: Challenging the Strip

Thomas Sammons, *University of Louisiana at Lafayette*

Sobro –“The Pieces of the City, Evolution or Intervention”

Mark O'Bryan, *University of Kentucky*

PANEL 3

Moderator

19th Century and Modern Urban Projects

Thomas Sammons, *University of Louisiana at Lafayette*

**FRIDAY
1:00 – 2:30 PM**

Boardroom East

Nineteenth Century Industrial Buildings of the Teche Corridor

Robert McKinney, *University of Louisiana at Lafayette*

The Maison de Verre: An Early Modern Urbanist Project

Jean Edwards, *University of Kentucky*

Geoff Gjertson, *University of Kentucky*

Spectacular Vernacular

Douglas Graf, *Ohio State University*

PANEL 4
Moderator

Readings of the City
Douglas Graf, *Ohio State University*

FRIDAY
2:45 – 4:15 PM
Boardroom East

Camouflage and Constellations: Color, Urban Form, and Place Legibility
Galen Minah, *University of Washington*

**Experiential Narrative Designs through the Lenses of Visual Communicators:
Collaborations between Urban Design and Photojournalism Students**
Teresa Hernandez, *Kent State University*
David Jurca and Gauri Torgalkar

**The Role of Cultural Industries in the Post-Industrialization of Chinese Coastal
Cities**
Douglas Webster, *Arizona State University*

PANEL 5
Moderator

Studies in Urban Transportation
Mark O'Bryan, *University of Kentucky*

FRIDAY
4:30 – 6:00 PM
Boardroom East

**Student Attitudes Concerned with Urban Transportation: Progressive or
Anticipated?**
Katharine Stowe, *St. Edward's University*

Light Weight Infrastructure Design of Transportation for Louisiana's Future
Jerry Malinowski, *University of Louisiana at Lafayette*

PANEL 1 **Well-being, Activism, and Social Justice for Women**
Moderator Amanda Burnam, *University of Oklahoma*

THURSDAY
1:00 – 2:30 PM

Fiesta 2

The Well-being of Women on a Cross-National Scale as Measured by the GDI
Amanda Burnam, *University of Oklahoma*

Using the Diversity of Experience to Engender a Classroom Community of Activists
Natalie Wilson, *California State University, San Marcos*

Performing Women's Autobiography
Rosemary Keefe, *University of Wisconsin-Superior*
Lynn Miller, *WriteSpace International*

PANEL 2 **Issues Surrounding the Status of Women**
Moderator Barbara Bonnekesen, *New Mexico Tech*

THURSDAY
2:45 – 4:15 PM

Fiesta 2

Globalizing the Pro-choice Debate
Rinita Mazumdar, *University of New Mexico*

A Women's Right to Property: Belize – A Case Study
Kim D. Cruz

The Return of the Homunculus: Neo-Conservative and Religious-Right Views of Zygotes, Embryos, and Women
Barbara Bonnekesen, *New Mexico Tech*

Teaching Gender and Islam in the West
Huma Ahmed-Ghosh, *San Diego State University*

PANEL 3 **Gender: Theory, Crime and the Academy**
Moderator/Discussant Diane Calloway-Graham, *Utah State University*

FRIDAY
8:00 – 9:30 AM

Fiesta 2

Cross - listed with
SOCIOLOGY

Rethinking Dichotomous Distinctions
Carol Key, *Tarleton State University*

Sexism or Professional Elitism? The Historical Influence on the Discipline of Home Economics in British Columbia
James J. Ponzetti, Jr., *University of British Columbia*

The Revolving Door of Recidivism: Characteristics of Female Drug Offenders, Substance Abuse Patterns, and Need for Treatment
Michelle Johnston, *University of Colorado at Colorado Springs*

PANEL 4

Moderator

Gender and Feminine Issues

Diane Calloway-Graham, *Utah State University*

**FRIDAY
1:00 – 2:30 PM**

Fiesta 2

Gender and Language in Aurora Luque's Poetry

Elena Olive', *Austin College*

Queen Bees, Goddesses, and Moon: The Divine Feminine in the Secret Life of Bees

Sita Bell, *Utah State University*

Using Hegemony, Public and Private Spheres, and Gender Identity to Evaluate the Stoning of Women

Shani Canillas-Rucker, *Colorado State University*

Women and Islam in Post-war Bosnia and Herzegovina

Emira Ibrahimovic, *University of New Mexico*

PANEL 5

Moderator

Images of Women

Amanda Martinez, *Texas A&M University*

**SATURDAY
8:00 – 9:30 AM**

Fiesta 2

From Cinderella to Lavagirl: Has the Princess become Action Heroine?

Pamela Redela

Property Of: The Reality of Women in Motorcycling

Adele Kubein, *Oregon State University*

The Color of Beauty as Perpetuated in America's Next Top Model

Amanda Martinez, *Texas A&M University*

PANEL 6

Moderator

Advocacy among Women

Barbara Bonnekessen, *New Mexico Tech*

**SATURDAY
9:45 – 11:15 AM**

Fiesta 2

The Election of Women in List PR Systems: Testing the Conventional Wisdom

Gregory D. Schmidt, *University of Texas at El Paso*

Love and Liberation in a Gender-Unequal World: Women and Socialism 1900-1920

Philippa Jane Winkler, *Northern Arizona University*

Bridging Theory and Practice: Using Content Analysis of Gender and Trade Advocacy Groups to Refine Feminist Theories of the Political Economy

Julie Steinkopf Rice, *New Mexico State University*

Index of Participants

A

Abang, Shulamite	68	Becker, Thomas	34
Acevedo, Elizabeth	13	Belec, John	20
Acheson-Brown, Daniel G.	67	Belkin, Aaron	17
Adams, Gretchen A.	56, 57	Bell, Sita	87
Adams, Michael O.	2, 3	Bejarano, Cynthia	30
Adkisson, Richard	40, 44, 49	Benanti, Mary A.	67
Immediate Past President, 2007-08		Benson, Melinda Harm	54
Ahmed-Ghosh, Huma	86	Benavides, Jude	15
Ajodhia-Andrews, Amanda	33	Berman, Rachel	33
Albanesi, Heather	78, 80	Beran, Carol	27
Sociology Section Coordinator		Berger, Christopher	36
Alm, Leslie	28	Bergh, Sunny	83
Alper, Don	20, 23, 28	Biando Edwards, Julie	78
Álvarez González, Carmen	25	Bifulco, Rober	71
Alvarez Olivas, Iván	25	Birch, David E.	53
Amato, Anthony	75, 76	Birkin, Ozden	51
Rural Studies Section Coordinator		Blanchford, Dongyan	49
Anderson, Joan	15, 19, 23	Bladh, Mats	41
Anderson, John	76	Blankmeyer Burke, Teresa	32
Anderson-Holmes, Kathryn	10	Blasco, Dani	23
Andrade Cuautle, Augustin	82	Blind, Melissa	6, 35, 37
Andrés Guzmán, Ricardo	18	Blomberg, Thomas G.	38
Arapis, Theodore	73	Bollinger, Sara L.	61
Arazan, Christine	38	Bonnekessen, Barbara	86, 87
Archambault, Steven	50	Borthwick, Emily	58, 59, 60
Archambeault, William	8, 36	Bottura, Juri	61
Archer, Kenna	56	Boikova Struble, Maria	78
Archuleta, Arturo	29	Boxberger, Daniel L.	18
Archuleta, Juan	31	Brazelton, W. Robert	43
Armstrong, Myrna L.	79	Breger Bush, Sasha	39
Ashley, Susan	67	Bremmer, Dale	48
Aske, David	50	Brenner, Christine	20
Atkinson, Glen	40, 44	Britton, Charles R.	11, 12
Axelsen, Dan	42, 45	Broadhead, Kay Lynn.	59, 60
		Brody, Alex	51
		Brooks Mitchell, Kileen	24
		Brown, Christopher	17, 23
		Executive Council Member	
		Brown, Christopher	40, 45
		Brown, Kevi J.	73
		Brown, Rebecca	79, 80
		Brown, Shanda	34
		Brown, Stephen	1, 2, 3, 4
		Brown, Steven E.	32, 33
		Chronic Disease and Disability Section Coordinator	
		Brunet-Jailly, Emmanuel	16
		Brunner, Ric	58
		Brunson, Jeremy	32
		Buckley, Patrick	20
		Bunch, Beverly	71
		Burg, B.R.	55
		Burkardt, Nina	52
		WSSA Archivist	
		Burkhart, Ross	28
		Burke, John	29, 67
		Burnam, Amanda	86

B

Baca, Jacobo	30
Bacigalupi, Tadini	80, 82
Bailey, Kathleen	35
Bakir, Erdogan	45
Baker, David L.	70, 73
Bales, William	38
Ballard, James David	35
Banian, King	50
Barajas, Alejandrina	19
Barker, Adam	9
Barnartt, Sharon	32
Barreras, Antonio	83
Barrie, Doreen	28
Baskoy, Tuna	41
Bataillou, Christian	15
Bauer, Kira	9
Baughman, T.H.	55, 56, 57
History Section Coordinator	
Baylor, Tim	78

Index of Participants

Bustillos Durán, Sandra.....	25	Coenders, Germà.....	15
Butler, Edgar.....	35	Cole, Paula M.	42
Butler, Kevin D.	56	Coleman, Ann.....	35
Butler, Randall R.	7, 36	Collins, Kimberly.....	15
Butry, Blake.....	78, 79	Collins, Terry.....	19
C		Combs, Sandra L.	63
Caballero Lozano, Carmen Amelia.....	25	Comert, Hasan.....	44
Calderón Villarreal, Cuauhtémoc.....	21	Conant, James.....	71, 73
Callegary, James.....	24	Conner, Thaddieus.....	7
Calloway-Graham, Diane	80, 86, 87	Connolly, Laura S.	50
Women's Studies Section Coordinator.....		Cook, Kevin.....	28, 66
Camden, Laura.....	62	Corbett, Jack.....	34, 82
Camfield, Thomas M.	55	Corley, Elizabeth A.	52
Companion, Michèle.....	80, 82	Corman, Rhonda R.	50
Campbell, Al.....	45	Corntassel, Jeff	8, 9
Campbell, Annhenrie.....	47	Executive Council Member	
Campbell, Carole.....	79	Coronado, Irasema	17, 23, 25
Campbell, Julie.....	38	Executive Council Member	
Canillas-Rucker, Shani.....	87	Correia, David.....	30
Cantillo, Andres F.	43	Corrent, Manola.....	81
Carrillo, Amanda.....	59, 60	Cortes Guardado, Marco A.	61
Carson, Scott	1, 3, 48, 49, 51	Costley, William.....	18
General Economics Section Coordinator.....		Covarrubias, Jesus.....	31
Carty, Victoria.....	82	Cox, John L.	74
Casey, Timothy.....	27	Creviston, Vernon P.	10
Castañeda, Liliana.....	61	Crapanzano, Theresa Rose.....	63
Casteline, Kimberly Eberhardt.....	62, 64	Crawford, Jane.....	55, 56
Castillo Viveros, Nemesio.....	25	Crider, Jonathan B.	57
Castro-Buelna, Jeanette M.	31	Cruz, Kim D.	86
Catlin, Dennis W.	35	Cruz Martinez, Elsa.....	34
Caton, Jamie.....	28, 66	Cuddington, John.....	47
Cazares Munguia, Irma Lucia.....	82	Cudeii, Diana.....	60
Champlin, Dell P.	45	Cummings, Adele.....	10, 78
Chapman, Brandon.....	56	Cuttitta, Anthony R.	58, 60
Chavez, H. Lyssette.....	83	Cuevas Contreras, Tomás J.	23
Chavez, Karma R.	58	D	
Chávez, Manuel.....	24	Dadzie, Richard.....	44
Chia, Vanessa.....	36	Dautrich, Kenneth.....	71
Chen Berggreen, Shu-Ling.....	62, 64	David, Charles-Philippe.....	68
Chermak, J.	48	Davidova, Evguenia.....	77
Chester, Lynne.....	41	Davis, Brooke.....	84
Chiang, Linda H.	13, 14	de Almeida, José Felipe A.	41
Asian Studies Section Coordinator.....		DeMartino, George.....	39
Christianson, Harold.....	48, 50	Demas, Lane T.	55
Cichock, Mark A.	77	Denton, Scott.....	79
Slavic Studies Section Coordinator.....		Dhondt, Geert.....	41
Choo, Freddie.....	47	Dhuyvetter, Kevin.....	11
Chung, Soyoon.....	69, 70	Dickens, Robert.....	54
Chu, Jou-juo.....	49	Dickson, Lynda.....	78, 81
Clark, Bradley T.	52	Dillon, Pattie.....	10, 78
Clark, Charles.....	45	Doan, Alesha.....	83
Clark, Douglas.....	52	Dobbs, Rhonda R.	38
Clark, Jessica.....	76	Dobson, Patricia.....	63
Clark, Paul.....	11	Dormiani, Angela A.	55
Cline, Kurt.....	53	Doty, Roxanne.....	15
Cloud, Redwing.....	8	Drabek, Thomas E.	79
Coes, Don.....	50		

Index of Participants

- Dredge, Bart 10
 Duchamel, Sabine 15
 Dufour, Mathieu 45
 Dugger, William M. 42, 44
 Dukes, Richard 80
 Duldulao, Aileen 81
 Duncan, Pamela 53
 Duncombe, Bill 71
 Dunn, Timothy J. 17, 18, 21
 Durán, Javier 17
 Durlabhji, Subhash 79
 Duvall, Chris 12
- E**
- Earley, Joseph 11
 Edwards, Benjamin 80, 81
 Edwards, Jean 84
 Edwards, Stephan P. 78
 Egan, Clifford 55
 Egginton, Everett 17
 Ekstrom, Carl D. 72
 Elinoff, Aaron 67
 Ellickson, Mark C. 67
 Eom, Taeho 74
 Episcopo, Val 80
 Erhunmwunse, Godspower 34
 Erickson, Erick Lee 27
 Espinosa, Salvador 15
 Ethridge, P. 21
 Eudaily, Seán Patrick 7
 Eutsey, Lisa 59
 Evans, Thomas 18
 Eyrich, Jaime G. 2, 5
- F**
- Fadden, Stephen 2, 5
 Fako, Thabo 34
 Farley, Heather M. 52
 Farrell, Jenny M. 58, 59
 Fehler, April 2, 3
 Ferm, Michele 32
 Fialho Pessali, Huáscar 44
 Findley, T. Scott 50
 Fink, Douglas R. 73
 Fitzgerald, Janine 41
 Fitzpatrick, Max 61
 Fontenla, Matias 50, 83
 Forbes, Jack 21
 Ford, Richard K. 11, 12
 Foster, Daniel 59, 60
 Foster, Susan 32
 Fowles, Jacob 72
- Fowler, Gil** 62
 Mass Communication Section Coordinator
- Francis, Susan 35
 Francis, Teresa I. 38
 Francom, Claudia 20
 Frank, Howard 73
- Franklin, Aimee L. 73
 Franks, CES 27, 28
 Friesner, Dan 42, 45
 Fudulu, Paul 45
 Fuentes, Viola 69
 Fuess, Scott 50, 51
 Furey, Kevin 40
 Furr, Paula F. 62, 63
 Fusilier, Marcelline 79
- G**
- Gabaldon, Christopher S. 68
 Gallamore, Monica S. 55
 Gallaire, Fatima 24
 Ganley, William T. 41
 Ganster, Paul 23
 Gámez Vázquez, Alba Eritrea 23
 Gaona, Osiris 11, 12
 García, Arnaldo 21
 García, Jr., Baldomero 23
 García, David 31
 García Leos, Norma 11, 12
 García, Joseph J. 61
 García, Justin 31
 García, Paula 31
 García, Sergio 25
 García y Griego, LM 29
 García Rios, Dante 82
 Gardner, Robert 73
 Garfinkel-Castro, Andrea 24
 Gay, David E. R. 11, 12
 Gayton, Denny 9
 Gillman, Denise 63
 Gillman, Denise 15
 Githumbi, Ruth 1, 3
 Gjertson, Geoff 84
 Glatfelter, Ed 77
 Golden, Bill 1, 2
 Gomez, Laura 83
- Gómez Zamudio, Ramón** 61
 Latin American Studies Section Coordinator
- Gonzales, Crystal 29
 Gonzales, Felipe 30
 Gonzales, Leslie D. 80
 González, Eliseo Díaz 15
 Gonzalez, Fidel 83
 Gooding, Frederick 62
 Grabel, Ilene 39
 Graf, Douglas 84, 85
 Graham, D. Kurt 57
 Graves, Joseph 70
 Green, Ian Matthew 42
 Green, Michael K. 39, 44
 Green, Monica 1, 2
 Greene, Dana 30
- Greene, Richard P.** 11, 12
 Geography Section Coordinator
- Book Review Editor, *Social Science Journal*

Index of Participants

Griffith, Winston H.	45	Hoy, Jim	65, 75
Grimsrud, Kristine.....	48, 52, 53	Hsiao, Kuan-Hsiu	14
Grinder, Darrin L.	10	Hsiung, James	14
Gross, Jonathan	73	Huang, Kun	14
Guia-Julve, Jaume	15, 23	Huang, Tzu-Man	47
Guo, David.....	73	Hughes, Mark	63
H		Hudson, Carol S.	28
Hadjilambrinos, Constantine.....	56	Hwang, Shir-fun.....	14
Hafner, John	50	I	
Hall Byars, Holly.....	63	Ibáñez, Oscar F.	5
Halverson, Thomas.....	78	Ibarra-Salazar, Jorge.....	5
Hake, Eric	40, 43	Ibrahim, Abeer	78
Hakob, Sekepyan.	51	Ibrahimasic, Emira	78, 87
Hansen, Tracie	59	Isern, Tom	65, 75
Hanson, Ralph E.	62	Executive Council Member	
Hardy-Short, Dayle	58, 60	Iwanek, Sonia Angelique	77
Human Communication Section Coordinator.....		Iwashita, Akihiro	24
Harjo, Suzan Shown	5	Izon, German M.	53, 83
Harman, Michael	64	Izotov, Aleksander.	19
Harris, LaDonna	7	J	
Hayden, F. Gregory	40, 41, 42, 45	Jackson-Pitts, Mary	62, 63, 64
Heather, Barbara.....	37	Jacobs, Kellya	67
Heffington, Benjamin D. A	59, 60	Jacques, Peter J.....	6, 54
Heller, Nathan A.	69, 70	Jarding, Liliias Jones	1, 3
Public Administration Section Coordinator		Jarratt-Snider, Karen	6, 9
Heller, Victor L.	69, 70	Jennings, Jr., Frederic B.	39, 45
Public Administration Section Coordinator		Jo, Tae-Hee.....	41
Executive Council Member		Johnson, Andrew F.	27
Hernandez, Angelica.....	58	Johnson, Ann K.	77
Hernández, Elsa Patricia.	25	Johnston, Janis E.	35
Henkel, Jr., David S.....	24	Johnston, Michelle.....	80, 81, 86
Henry, John F.	41, 44, 46	Jordan, Lauren.....	52
Heppler, Jason A.	55	Jordan, Meagan M.	71
Hernandez, Teresa	85	Jones, Marion	48, 49
Herren, Robert	49, 50	Judkins, Gabriel	11
Hewins-Maroney, Barbara	1, 3	Jung, Changhoon.....	73, 74
Higelin Ponce de Leon, Ricardo	82	Jurca, David	85
Hildreth, W. Bartley	72, 73	Justice, Jonathan B.	72, 73
Hill, Lindsey K.	68	K	
Hill, Michael Paul	18	Kaboub, Fadhel.....	43
Hill Maher, Kristen	18, 24	Kanth, Rajani.....	39
Hirsch, Michael L.	78	Kastens, Terry	9
Hoass, David.....	48, 49	Kauppi, Joan.....	36
Hoffman, Tom	5	Kea, Ray A.	56, 57
American Indian Studies Section Coordinator		Kebabci, Deniz.....	47
Holscher, Louis M.	29, 30, 31	Keefe, Rosemary.....	86
Chicano Studies and Land Grants Section		Keith, Elizabeth	5, 6, 9
Coordinator.....		American Indian Studies Section Coordinator	
Hopkins, Barbara E.	44, 45	Kelley, Suzanne	65, 75, 76
Horejas, Thomas	33	Rural Studies Section Coordinator	
Hoskisson, Tam.....	56	Kepner, Valarie	65
Hou, Jack W.	66	Kepner, Valarie	41
Political Science Section Coordinator.....		Kerber, Cynthia.....	33
WSSA 51 st Annual Conference Program Chair		Kesselring, Randy	48
President-Elect, 2008-09		Key, Carol.....	80, 81, 86
Hou, Yilin.....	74		
Hoy, Cathy.....	65, 75		

Index of Participants

Keys, David.....	38	Leone, Matthew C.	37
Khindanova, Irina.....	47, 53	Lewis, Hayes A.	1, 3
Kiang, Walter Y.	Deniz 13, 14	Lewis, Leatrice.....	1, 3
Asian Studies Section Coordinator		Lewis, Miles.....	76
Kiel, Dwight C.	52	Lewis, Susan L.	63
Environmental Policies & Natural Resources Section		Liang, Jr-shiuan	14
Kilian, Reinhold	33, 34	Liddle, Kelsey	27
Killsback, Leo.....	9	Lightfoot, Sheryl	5
Kim, Chon-Kyun	69	Liikanen, Ikka	22
Kim, Juchan	73	Lin, Ching-Mei.....	72
Kinney, Martha E.	10, 78	Lin, Li-hui	14
Kioko, Sharon N.	72	Linder, Peter S.	56
Kipp, Billie Jo	7	Lindsay, David H.	47
Kirkey, Christopher	28, 66	Ling, Yu-Long	14
Kirby, Margaret	63	Linn, J. Gary	32, 33, 34
Klatt, Martin.....	15	Chronic Disease and Disability Section Coordinator	
Klein, Phillip	44	Executive Council Member	
Klima, Cynthia A.	77	Liu, Gao	72
Vice President, 2008-09		Logsdon, Elijah.....	68
Knoedler, Janet T.	42, 45	Longo, Peter J.	38, 76
Koch, Brad	14	Lopez, Erin A.	68
Koch, Jerome R.	79	Lopez, Nancy.....	83
Koch, Pamela	14	Lowman, Emma Battell.....	5
Kodrich, Kris	63	Luksetick, William	50
Kohpahl, Gabriele.....	19	Luna-Firebaugh, Eileen	35, 37
Konrad, Victor	20, 23	Criminal Justice & Criminology Section Coordinator	
Kozel, Philip	41	Lucero, Aileen F.	29, 82
Kraeger, Patsy	69	Chicano Studies and Land Grants Section	
Krause, K.	48	Coordinator	
Krumm, Silvia.....	34	Lybecker, Donna L.	16
Kubein, Adele.....	87	Lybecker, Kristina.....	50, 51
Kuester, Daniel D.	11	Lyons, Christopher J.	83
Kuffner Hirt, Mary Jane.....	72	Lyons, Emily.....	18
Kunz, Karen	72		
Kurtz, Rick S.	54	M	
L		Machida, Satoshi.....	67
LaFever, Marcella.....	64	Madrid, Enrique	15
Lan, Zhiyong.....	13, 53	Maher, Jim	27, 65, 66
Lang, Carston.....	50	Malinowski, Jerry	84, 85
Laine, Jussi.....	22	Manafy, Abbas	68
Laituri, Melinda.....	63	Mananseryen, Tatul.....	51
LaJeunesse, Robert.....	39	Maneepong, Chuthatip	19
Lapeyre, Julian.....	38	Mangun, William R.	52
Lara, Dulcinea.....	30	Maniam, Balasundram	47
Latmani, Saida.....	17	Marlowe, Justin.....	72, 74
Lauth, Thomas.....	27	Marley, Tennille	83
Lea, Joseph J.	15	Marston, Christine.....	17
Leal, Teresa	15	Martinez, Amanda.....	87
Leavell, Hadley.....	47	Martinez, David.....	8
Lee, Frederic S.	41, 46	Martinez, Oscar.....	17
Lee, Lloyd L.	8	Martinez-Brawley, Emilia E.	29
Lee, Unro	51	Maroney, Morgen.....	1, 3
Lee, Yu Feng.....	49	Marsh, Robert.....	38
Leftoff, Sondra.....	10	Maruyama, Kenichi.....	69
Lei, Richard M.	63	Mathis, Irma.....	79
Lei, Wei	14	Matos, Cristina.....	39
Leloup, Fabienne.....	15	Matthews, Timothy	48
		Matus, José	18

Index of Participants

Maw Jensen, Kimball	64	Nathenson, Sophie	81
May, Gary E.	32	Neck, Kym	21
Mayhew, Anne	39, 42	Nelson, Gesemia	80, 82
Mays, Larry	38	Nesiba, Reynold	40, 43, 44
Mazumdar, Rinita	86	Neuburger, Mary	77
McAdams, John	48	Nicdao, Ethel	81
McCanna, David T.	7, 35, 36	Nickleberry, Lynette	1, 3
McCleneghan, J. Sean	62	Nicol, Heather	23
McDougall, A.K.	18	Nielsen, Marianne O.	8, 36, 37
McFarlane, Deborah	83	Niggle, Chris	42, 43
McInerney, Daniel J.	10	Niño Contreras, Lya Margarita	17
American Studies Section Coordinator		Noble-Britton, Pinky	34
McKinney, Robert	84	Nord, Douglas	17
McKinnon, Sara L.	58	Executive Council Member	
McPhee, Craig	49, 51	Norfleet, Philip	55
McSwain, James B.	56	Norman, Laura M.	24
Medina, Ignacio	61	Nuno, John Paul	18
Megdal, Sharon	24	O	
Mendoza, Jorge Eduardo	21	O'Bryan, Mark	84, 85
Mentzel, Peter C.	77	Ochoa Macías, Roberto	61
Merriman, David	71	O'Connor Shelley, Tara	38
Mesbah, Hesham M.	62	O'Donnell, Jerry	29
Meyer, Jon'a	8, 36	O'Hara, Phillip Anthony	40, 41, 43, 45
Mickelsen, Zachary Alan	60	Olds, Julia	27
Miker, Marta	25	Olive', Elena	87
Miller, Edythe	42	Olsen, Georgina	5
Miller, Gerald	72	Olson, Mary	8
Miller, Lynn	86	Orr, Teresa	65, 75
Miller, Michael V.	79	Ortiz, Victor M.	24
Miller, Robert J.	9	Osborne, Rodney	62, 63
Miller, Rozilyn	63	Oskam, Judy	64
Milner II, Clyde A.	75, 76	Ou, Xiaolu (Sherry)	74
Minah, Galen	85	Owen, Donna C.	79
Mondragón, Roberto	29	P	
Montoya, T. Mark	15	Pacheco Vega, Raúl	24
Moody, Michael	71, 72, 74	Palumbo, David	79
Public Finance & Budgeting Section Coordinator		Palau i Saumell, Ramon	19
Moore, Conrad	11	Pandey, Sanjay	74
Moore, Dennis	32	Parcher, Jean W.	24
Moore, Scott	71	Parker, Steven	14, 52
Moore, William Haas	16, 17	Pasi, Fahini	33
Morales, Annette	69	Patrick, J. Michael	23
Moreno-Álvarez, Gabriela	24	Patrick, Steven	7, 35, 36, 37, 38
Morrison, Micheal	50	Criminal Justice & Criminology Sect. Coordinator	
Mott, Andrea	76	Pavlik, Steve	5, 8
Moyer, Jonathan	39	Payan, Tony	15, 20
Mueller, Carol	19	Association of Borderland Studies	
Mumme, Stephen	6, 7	Section Coordinator	
Muria, Magalí	21	Peach, Jim	23, 40, 44
Murphy Erfani, Julie A.	21	Pearson, Diane.	6, 8
Murphy, S.J., Thomas	27, 65	Pencek, Thomas.	47
Canadian Studies Section Coordinator		Peña, Sergio	24
Musto, Jennifer Lynne	87	Peroff, Nicholas C.	6, 9
Musumeci, Thomas	73	Pham, Xuan	44
Myrstol, Bradley	7, 36	Phillips, Lisa	18
N		Phillips, Ronnie	40, 42
Namoro, Soiliou Daw	48		

Index of Participants

Piet, Pete	12	Romero, Eric.	29, 30, 31
Pillai, Vijayan K.	81	Chicano Studies and Land Grants Section	
Pineda-Pablos, Nicolas	69	Coordinator	
Pisani, Michael J. M.	19, 23	Rosales Soldana, Jorge Abel	61
Poirot Jr, Clifford S.	43, 44, 46	Latin American Studies Section Coordinator	
Poku, Kwabena	34	Rosev, Tatjana K.	58
Ponzetti, James	49, 80, 86	Ross, Debra	35
Poole, Daniel	79	Ross, Kara	11, 12
Poom Medina, Juan	61	Ross, Kristi	54
Popp, Anthony V.	23	Ross, Rita	27
Powell, Brian	84	Rousse, Amelia	83
Powner, Les	18	Rovai, Eugenie	53
Prasch, Robert	39, 44	Ruell, Emily	52
Pratt, Leila	49, 50, 51	Ruiz Flores, Jesús	61
Executive Council Member		Russell, Janice R.	37, 83
Price, James	50	Ryan, Richard W.	11, 12
Price, Marji	59		
Pressman, Steven	39, 41	S	
Q		Sabharwal, Meghna	13
Quartaroli, Tina A.	81	Sachs, Steve	7
Quashie, Nekehia	81	Salas, Stephen	31
Quast, Troy	83	Salas Plata, Jorge	23
Quintana, Gilbert	31	Salaz, Ruben	31
Quive, Maria	34	Sammons, Thomas	84
R		Urban Studies Section Coordinator	
Ralls, Brenda	33	Sánchez, Bernadette	29
Ramirez-Pimienta, Juan Carlos	18	Sanchez, Gabriel R.	83
Ramirez Sanchez, Enrique	58, 59	Sánchez, Juan	29
Rankin, Elizabeth	48	SándeZ Pérez, Agustín	17
Ransaw, Theodore	1, 3, 4	Sanders, Shane	9
African & African American Section Coordinator		Sandoval, Sergio	61
Rausch Jr., John David	67	Santos, Richard	83
Rebuck, Robert A.	19	Sauer, Christine	50
Reddish, Sandra	76	Schaar-Buis, Denise	37
Redela, Pamela	87	Schaniel, William C.	65, 66, 75
Reed, Maryanne	62	New Zealand & Australian Studies Sect.	
Resendiz, Rosalva	21	Coordinator	
Revell, Maria	32	Schelly, Chelsea	81
Reyes, Aida	25	Schild, Steve	62
Reyes, Juan C.	23	Schmidt, Gregory D.	87
Rice, James	81	Schmitt, Sam	69
Richardson, James T.	37, 83	Schlenker, Emily	33
Ridgeway, Sharon	53	Schneider, Geof.	39, 40, 43
Rincones Delgado, Rodolfo	25	Schreiner, Tara	12
Robbins, Mark	71	Schroeder, Anthony B.	64
Roberts, Alden E.	79	Scoggins, Scott	9
Garcia, Nelly Robles	82	Scotch, Richard	32
Rodrigue, Christine M.	53	Scott, Christopher A.	24
Rodriguez, Elaine	31	Scott, James	15, 19, 22
Roe, Becky	13	Scott, Janet	49
Roehl, Janet	63	Scott, John	66
Roeser, Patricia	57	Seamans, Georgia Silvera	84
Rogers, Brent M.	55	Self, Elizabeth	67
Rogers, Brian	58, 59, 60	Seif, Natalie	35
Roman, Belinda	19	Semenova, Alla	42
		Shaw, Stephen K.	68
		Shepherd, Jeffrey P.	15, 21

Index of Participants

Shannon, Dawn.....	78	Thomas, Morgen.....	79
Short, Brant	58, 60	Thompson, Brian P.	76
Human Communication Section Coordinator.....		Thoms, Bill	76
Sherman, Howard	43	Thull, Jerry	60
Shwayder, Martha	79, 82	Timberlake, James	67
Simonsen, Bill	71	Tiedje, Michelle.....	55
Smith, Dan.....	72	Tilton, Jeffrey	52
Smith, Justin T.H.	63	Tippeconnic Fox, Mary Jo	6, 9, 35
Skogberg Eastman, Cari Lee	50	Tiwari, Kashi Nath	47
Smith, Keith B.	68	Economic Business & Finance Section Coordinator	
Smith, Linda.....	2, 3	Todorova, Zdravka	43
Snow, Douglas	71	Tolan, Mary	62
Snyder, Kevin.....	60	Torell, Gregory.....	48
Solé, Joan.....	15	Torgalkar, Gauri.....	85
Song,e Hyojin	14	Torn, Jon.....	60
Socorro Tabuenca Córdoba, María	19	Tsai, Wen-Hui.....	14
Sotres-Cervantes, Lida	21	Tsoodle, Leah	6
Speed, Shannon	18	Tsosie, Jr., William B.	6
Spener, David	17		
Springer, Victoria.....	37, 83	U	
Springler, Elisabeth.....	44	Unger, Kay	51
Starks, Riva	58	Ullman, Char.....	20
Stasheff, Christopher B.	64	Underwood, Daniel.....	39, 42, 45
Staudt, Kathy.....	16, 17, 19	Unnithan, N. Prabha	35
Stea, David	20	Editor, <i>Social Science Journal</i>	
Stefanick, Lorna	70	Urbina, Javier V.	20
Steinkopf Rice, Julie.	81, 87	Urquhart, Ian.....	28
Steinman, Erich.....	9		
Stephenson, Edward.....	81	V	
Stevens, Shannon.	59	Valdéz, Nelson	61
Stevenson, Judith.....	82	Valdez, Robert	83
Stewart, Kim.....	34	Valdez, Stephanie	31
Stinner, William.....	33	Valencia-Weber, Gloria	18
Storer, Paul.....	20	Vallet, Elisabeth	68
Stockly, Sue	49	Varma, Roli.....	13, 14
Stovel, Nora Foster.....	27	van der Velde, Martin	23
Stowe, Katharine.....	85	Vance, Annalise	20
Struble, Maria Boikova	10, 78	Vandervoet, Prescott	24
Sturgeon, James	42	Vargas Leyva, María Ruth	19, 23
Suacedo, Eduardo.	49	Vega, Santos	29
Sun, Rui.....	73	Vélez, María B.	83
Sunada, Grant.....	33	Vidal Lieberman, Carmen.....	31
Suzuki, Peter T.....	8	Villegas, Mirta	61
Swedberg, Sarah.....	10, 78	Voeltz, Richard.....	55, 57
Swiercek, Nicholas D.	55	Voss, Robert J.	55
T		W	
Taggart, William A.....	7	Waid, Courtney A.	38
Tamez, Eloisa.....	15	Waller, William.....	42
Tamez, Margo.....	18, 21	Wang, Jing	52
Tan, Kim B.	47	Wang, Wen	71
Tanveer Choudhry, Misbah	44	Watkins, John	40, 44, 45
Taylor, Katrina.	54	Watkins, Kate	39
Taylor, Lawrence.....	18, 28	Webb, James L.	41
Templer, Otis W.	11	Weitzettle, Christina	36
Tevie, Justin	52	Welch, Eric	52
Thatcher, Jennifer	48	Welch, Reed L.	67
Thierer, Joyce	75	Wells Marshall, Robert.....	27

Index of Participants

Wersom, Saron	78
Whalen, Charles J.	43
Wheelock, Rick.....	6, 8
Whistler, Donald.....	67
Whitehead, Michele L.	7, 36
Whitsel, Brad	55, 56
Widders, Steve.....	66
Wildcat, Daniel.....	5
Wilds, Leah	54
Wiens-Tuers, Barbara	43, 44
Executive Council Member	
Williams, Ed	23
Williams, Mamie	34
Wilson, Debra R.	32, 33, 34
Chronic Disease and Disability Section Coordinator.....	
Wilson, Natalie	86
Wilson, Jamie.....	5
Wilson, Jeff	21
Winkler, Philippa Jane.....	87
Wipf, Kevin	76
Wisman, Jon	44
Woldemariam, Yohannes	67
Wojciechowski, Krzysztof	17
Wood, Darryl	7, 36
Wood, John	7, 36
Wrenn, Mary	40, 41
Wrobel, Sharon L.	71
Wu, Yonghong	71
Wunder, Timothy A.	45
Y	
Yasko, Richard	55
Yang, Lihua.....	13, 53
Yau, Dick Tak-sang.	13
Yau, Jenny.....	13
Yoon, Chris.	13, 61
Yoskowitz, David W.	19
Yusuf, Wie.	72, 73
Z	
Zapata, David.	67
Zaremba, William.	47
Zekavat, Seid M.	12
Zeng, Lily.....	63
Zender, Josh	73
Zhao, Xiaobing.....	52
Zhao, Zhirong (Jerry)	71
Public Finance & Budgeting Section Coordinator	
Ziegler, Zac.....	60
Zisman, Stuart	1, 2, 3, 4, 33, 67
Zizalra-Hernández, Isabel.....	23
Zorita, Paz M-B.	29



Doctor of Economic Development

The DED is a professional doctorate offered jointly by the Department of Economics and International Business and the Department of Agricultural Economics and Agricultural Business.

NMSU College of Business
NMSU College of Agriculture and Home Economics

DED Program Overview

Economic development is a complex process. Its study and practice draws on a wide variety of academic knowledge and experience. The Doctor of Economic Development (DED) is a professional degree primarily intended to provide advanced applied training for economic development professionals (rather than academic economists).

Recognizing the diversity of subjects and experience and knowledge useful to economic developers, DED students will enter the program from a variety of backgrounds. All DED students will share a common core of training in economics and economic development followed by the opportunity to select elective courses and specialties reflecting their particular interests and goals. All graduates will complete an internship and a major economic development project.

DED graduates can be seen as the link between academic theory and research in economic development and "real world" economic development problems. DED graduates will be prepared to navigate the world between the theoretical and analytical world of academic economics and the very practical problems of economic development at all levels.

For more information contact:

Richard V. Adkisson, Director, DED Program
Department of Economics and International Business
Box 30001, MSC 3CQ
New Mexico State University
Las Cruces, NM 88003-8001
Phone: 575-646-4988 Fax: 575-646-1915
E-mail: radkisso@nmsu.edu

Visit the DED website at:
<http://business.nmsu.edu/~econ/ded/DEDweb.html>



NORTHERN
ARIZONA
UNIVERSITY

YUMA
Branch Campus

*Making quality, higher education more
accessible and affordable
to the lower Colorado River Region.*



928.317.6400 | www.nau.edu/yuma

North Dakota State University

Center for Heritage Renewal

The mission of the **Center for Heritage Renewal** is to identify, preserve, and capitalize on the heritage resources of North Dakota and the northern plains.

The center congratulates participants in the panels devoted to **Heritage Studies** within the Rural Studies Section of the WSSA, as they seek definition of the emerging field of Heritage Studies. The center welcomes panelists from **Arkansas State University, Emporia State University, and North Dakota State University** for this dialog on a discipline.

NDSU

Objectives of the Center for Heritage Renewal

1. To assist state agencies, private organizations, and the people of the state and region in generating prosperity and quality of life from heritage resources
2. To establish a center for expertise and action in the fields of historic preservation and heritage tourism
3. To provide opportunities for learning, employment, and internships for NDSU students (undergraduate and graduate)

www.ndsu.edu/heritage



My **Penn State Altoona**

visit www.altoona.psu.edu/admissions
or call 814-949-LION or 800-843-9843

PENNSTATE



Altoona

My Penn State Altoona

19 baccalaureate degrees

8 associate degrees

19 minors

363 faculty

4,104 total students

4 residence halls

70 clubs and organizations

15 varsity athletic teams

1 great college community



make it yours!

WWW.ALTOONA.PSU.EDU

